

CURVE #15
Curve Data Based on Centerline
Rad. = 200.45' Delta = 38°39'44" Tangent = 70.32'
Arc = 135.26' L.C. = 132.71' Def/Ft. = 8.57509 Min.

Station	Arc	FACE CHORD LENGTHS		Def.	T. Def.
		B Lt.	B Rt.		
30+46.00	-	-	-	0'00"00"	0'00"00"
30+50.00	4.00'	3.56'	4.44'	0'34"18"	0'34"18"
30+75.00	25.00'	22.24'	27.73'	3'34"22"	4'08"40"
31+00.00	25.00'	22.24'	27.73'	3'34"22"	7'43"03"
31+25.00	25.00'	22.24'	27.73'	3'34"22"	11'17"26"
31+50.00	25.00'	22.24'	27.73'	3'34"22"	14'51"48"
31+81.26	31.26'	27.80'	34.66'	4'28"03"	19'19"51"

Subdivision Bench Marks

No.	Street and Station	From CL	Description	Elevation
8	Bracken Ct., Sta. 31+81.26	14.50' Lt.	South Curb Return of the cul-de-sac of Bracken Ct.	



SCALE 1" = 20'
IRON = •

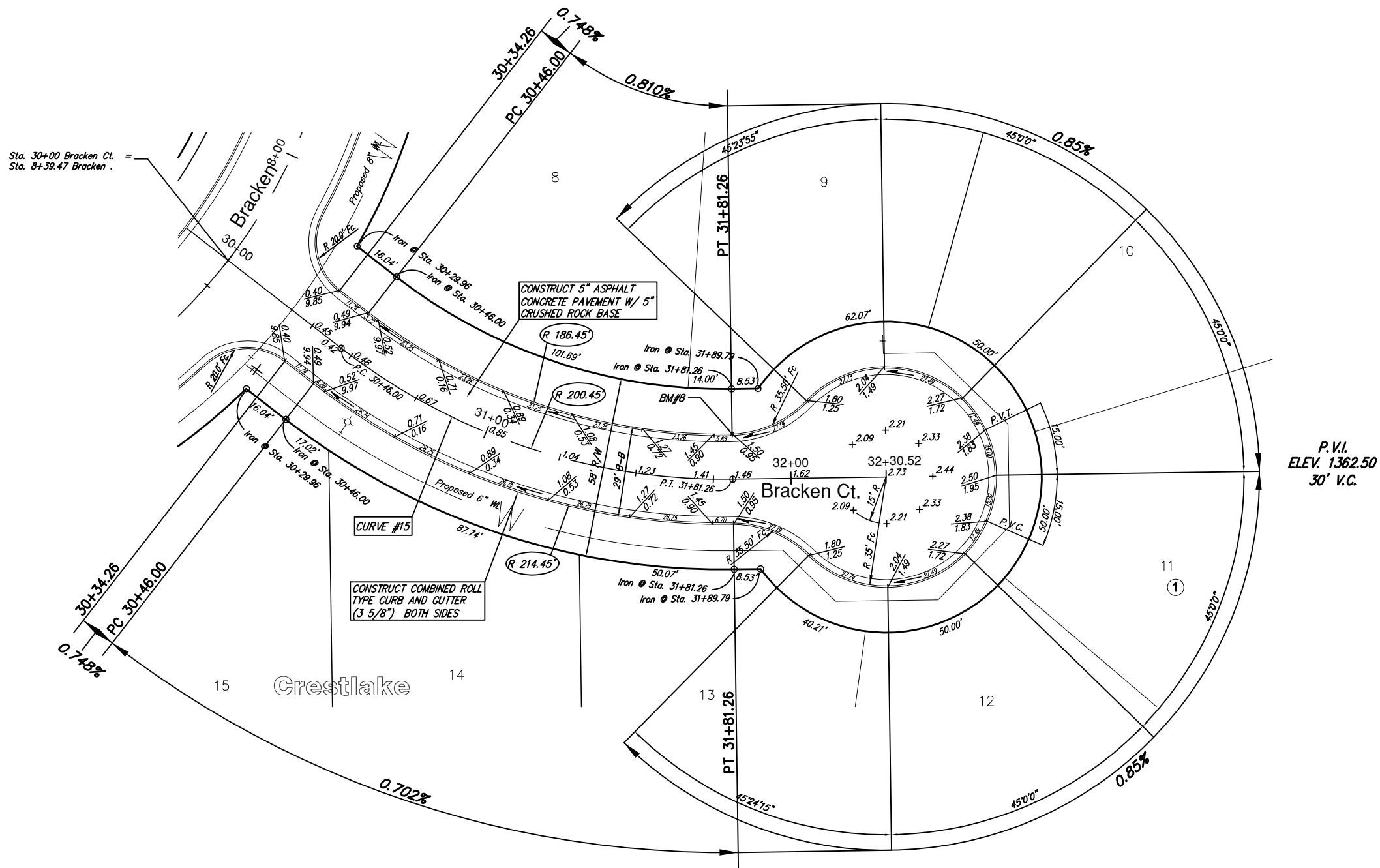

NOTE: ROLL TYPE CURB AND GUTTER TO BE CONSTRUCTED ALONG PAVEMENT DEPICTED ON THIS SHEET

**Crestlake
Bracken Ct.
WICHITA, KANSAS**

Ruggles & Bohm, P.A.
 Engineering, Surveying, Land Planning
 924 North Main (316) 264-8008
 Wichita, Kansas 67203 (316) 264-4621 fax
 www.rbkansas.com E-mail: info@rbkansas.com

DESIGN	AML	SHEET 10 OF 40
DRAWN	MLP	
REVIEW		
UTILITY		
DRAWING FILE	PROJECT NUMBER	DATE
paving {BRACKEN CT}	472-84406	May 25, 2006