

# PAVING AND INCIDENTAL DRAINAGE IMPROVEMENTS

84449

TO SERVE

## OAK CREEK 2ND-PHASE 2

19TH STREET NORTH - FROM CHATEAU PARKWAY TO OAK CREEK PARKWAY

CHATEAU PARKWAY - FROM 19TH STREET NORTH TO A POINT 80' SOUTH OF LOT 4, BLOCK 2

OCA NO. 766116

CITY OF WICHITA PROJECT NO. 472-84449

## CITY OF WICHITA, KANSAS

JAMES L. ARMOUR, P.E. - CITY ENGINEER

PROJECT LENGTH = 4,007 LIN. FT.

### EARTHWORK SUMMARY

EXCAVATION 5,735 CU. YDS.  
 COMPACTED FILL 2,040 CU. YDS.  
 LOOSE FILL 2,045 CU. YDS.

EXCESS EXCAVATED MATERIAL FROM THE PROJECT SHALL BE STOCKPILED ON-SITE AS SHOWN ON SHEET NO. 2 OR TO BE DETERMINED BY THE OWNER AND APPROVED BY THE ENGINEER. STOCKPILE(S) SHALL BE BLADED SMOOTH AND SLOPED TO DRAIN.

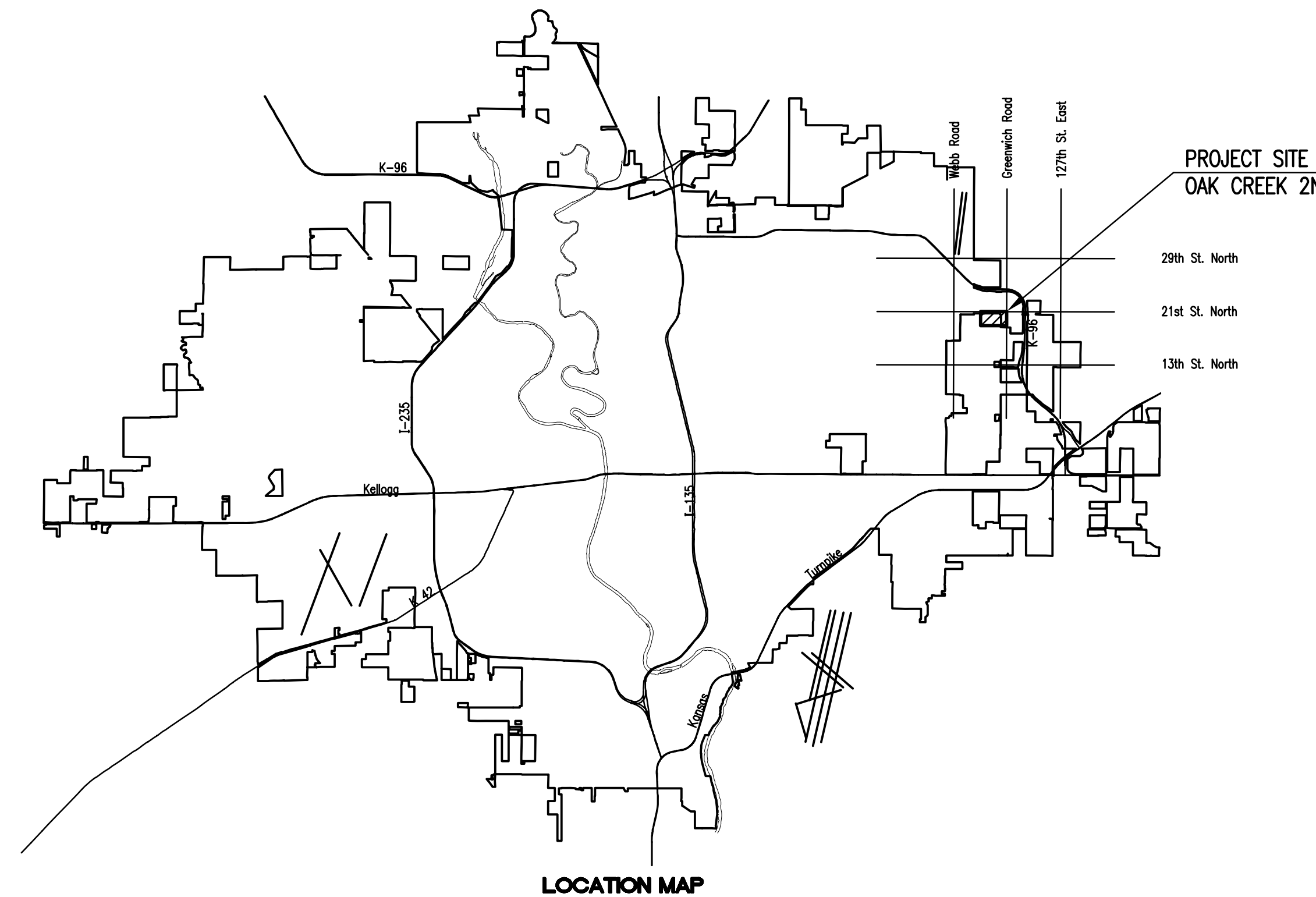

### INDEX OF SHEETS

1. TITLE SHEET
2. KEY MAP AND GENERAL NOTES
- 3-4. PLATS AND HORIZONTAL CONTROL
5. TYPICAL 20' BK.-BK. PAVEMENT DETAILS
6. TYPICAL 29' BK.-BK. PAVEMENT DETAILS
7. TYPICAL 35' BK.-BK. PAVEMENT DETAILS
- 8-9. PAVING PLANS-CHATEAU PARKWAY
- 10-14. PAVING PLANS-19TH STREET NORTH
15. VALLEY GUTTER DETAILS
16. MISCELLANEOUS PAVING DETAILS
17. ROUNDABOUT PLAN (STA. 10+00)
18. ROUNDABOUT SIGNING PLAN (STA. 10+00)
19. ROUNDABOUT COORDINATE PLAN (STA. 10+00)
20. ROUNDABOUT PLAN (STA. 19+98.27)
21. ROUNDABOUT SIGNING PLAN (STA. 19+98.27)
22. ROUNDABOUT COORDINATE PLAN (STA. 19+98.27)
23. ROUNDABOUT TYPICAL SECTIONS
24. ROUNDABOUT RETAINING WALL LAYOUT
25. ROUNDABOUT MISCELLANEOUS DETAILS
26. PLAN/PROFILE-SWS LINE NO. 1
27. PLAN/PROFILE-SWS LINE NO. 1A
28. PLAN/PROFILE-SWS LINE NO. 2
29. PLAN/PROFILE-SWS LINE NO. 3
30. CHANNEL-CHATEAU PARKWAY
31. STD. TYPE 1A CURB INLET (5' OPENING)
32. STD. AREA INLET
33. STD. TYPE "P" MANHOLE DETAILS
34. MANHOLE ADJUSTMENT DETAILS
35. MANHOLE FRAME AND COVER DETAILS
36. MISCELLANEOUS DRAINAGE DETAILS
37. ELECTRICAL DETAILS
- 38-40. ELECTRICAL PLANS
41. EROSION CONTROL PLAN
- 42-45. EROSION CONTROL DETAILS
46. SIGNING DETAILS
- 47-84. CROSS SECTIONS

SUBDIVISION BENCH MARKS (SBM)				
NO.	STREET AND STATION	FROM @	DESCRIPTION	ELEVATION
1	CHATEAU PARKWAY, @ STA. 11+12.43	17.5' LT.	ON WEST CURB, 14' NORTH OF CURB INLET	
2	CHATEAU PARKWAY, @ 2 STA. 16+58.23	17.5' LT.	ON NORTH CURB, NORTH OF MEDIAN CURB P.C.C.	
3	19TH STREET NORTH, @ RT. STA. 36+40.17	14.5' LT.	ON NORTH CURB	
4	19TH STREET NORTH, @ STA. 42+00.00	14.5' LT.	ON NORTH CURB	
5	19TH STREET NORTH, @ STA. 48+00.00	14.5' LT.	ON NORTH CURB	

THE COST OF THE BENCH MARK DISC, INCLUDING INSTALLATION, SHALL BE INCIDENTAL TO THE CURB.

NOVEMBER 2006

PLANS PREPARED BY

PROFESSIONAL ENGINEERING CONSULTANTS, P.A.  
 ENGINEERS  
 WICHITA, KANSAS