

LT. CURVE DATA
 A=39°24'17" L D=13° 21' 20.4" R=429.00' L=295.04' T=153.62' E=26.68'
 CURVE DATA BASED ON @ Lt. radius Δ/2= 19° 42' 8.5"

STATION	ARC LENGTH	FACE CURB LENGTH		CHORD LENGTH		DEFLECTION ANGLE	TOTAL DEFLECTION
		LEFT CURB	RIGHT CURB	8' OFF LEFT FACE CURB	8' OFF RIGHT FACE CURB		
33+25.33						0°00'00.0"	0°00'00.0"
33+50.00	24.67'	23.86'		23.40'		01°38'50.7"	01°38'50.7"
33+75.00	25.00'	24.18'		23.71'		01°40'10.1"	03°19'8.8"
34+00.00	25.00'	24.18'		23.71'		01°40'10.1"	04°59'10.8"
34+25.00	25.00'	24.18'		23.71'		01°40'10.1"	06°39'20.9"
34+50.00	25.00'	24.18'		23.71'		01°40'10.1"	08°19'30.9"
34+75.00	25.00'	24.18'		23.71'		01°40'10.1"	09°59'41.0"
34+79.22	4.22'	4.08'		4.00'		00°16'54.5"	10°16'35.5"
35+00.00	20.78'	20.10'		19.71'		01°23'15.6"	11°39'51.0"
35+25.00	25.00'	24.18'		23.71'		01°40'10.1"	13°20'01.1"
35+50.00	10.67'	10.32'		10.12'		00°42'45.1"	14°02'46.2"
35+52.34	2.34'	2.26'		2.22'		00°09'22.5"	15°09'33.7"
35+75.00	22.66'	21.92'		21.50'		01°30'47.5"	16°40'21.2"
36+00.00	25.00'	24.18'		23.71'		01°40'10.1"	18°20'31.2"
36+20.37	20.37'	20.37'		19.32'		01°21'37.0"	19°42'08.6"
TOTAL	295.04'	285.41'					

Defl./ft. = 4.006698 min.

LT. CURVE DATA
 A=19°55'56" R D=18° 28' 57" R=310.00' L=107.84' T=54.47' E=4.75'
 CURVE DATA BASED ON @ Lt. radius Δ/2= 9° 57' 58"

STATION	ARC LENGTH	FACE CURB LENGTH		CHORD LENGTH		DEFLECTION ANGLE	TOTAL DEFLECTION
		LEFT CURB	RIGHT CURB	8' OFF LEFT FACE CURB	8' OFF RIGHT FACE CURB		
32+17.49						0°00'00.0"	0°00'00.0"
32+18.05	0.56'					0°59'0.5"	0°03'06.3"
32+18.49	0.44'	0.46'	0.39'	0.47'	0.38'	00°02'26.4"	00°05'32.7"
32+25.00	6.51'	6.80'	6.80'	6.97'	5.63'	00°36'05.8"	00°41'38.5"
32+50.00	25.00'	26.13'	22.26'	26.77'	21.61'	02°18'37.1"	03°00'15.6"
32+75.00	25.00'	26.13'	22.26'	26.77'	21.61'	02°18'37.1"	05°18'52.7"
33+00.00	25.00'	26.13'	22.26'	26.77'	21.61'	02°18'37.1"	07°37'29.9"
33+25.00	25.00'	26.13'	22.26'	26.77'	21.61'	02°18'37.1"	09°56'7.7"
33+25.33	0.33'	0.35'	0.29'	0.36'	0.28'	00°01'49.8"	09°57'58.0"
TOTAL	107.84'	112.71'	96.02'				

Defl./ft. = 5.544753 min.

WATER VALVE BOX ELEVATIONS

STREET	STATION	OFFSET	PROPOSED ELEVATION
19th Street North	@ Sta. 36+20.38	22.0' Rt.	1400.19

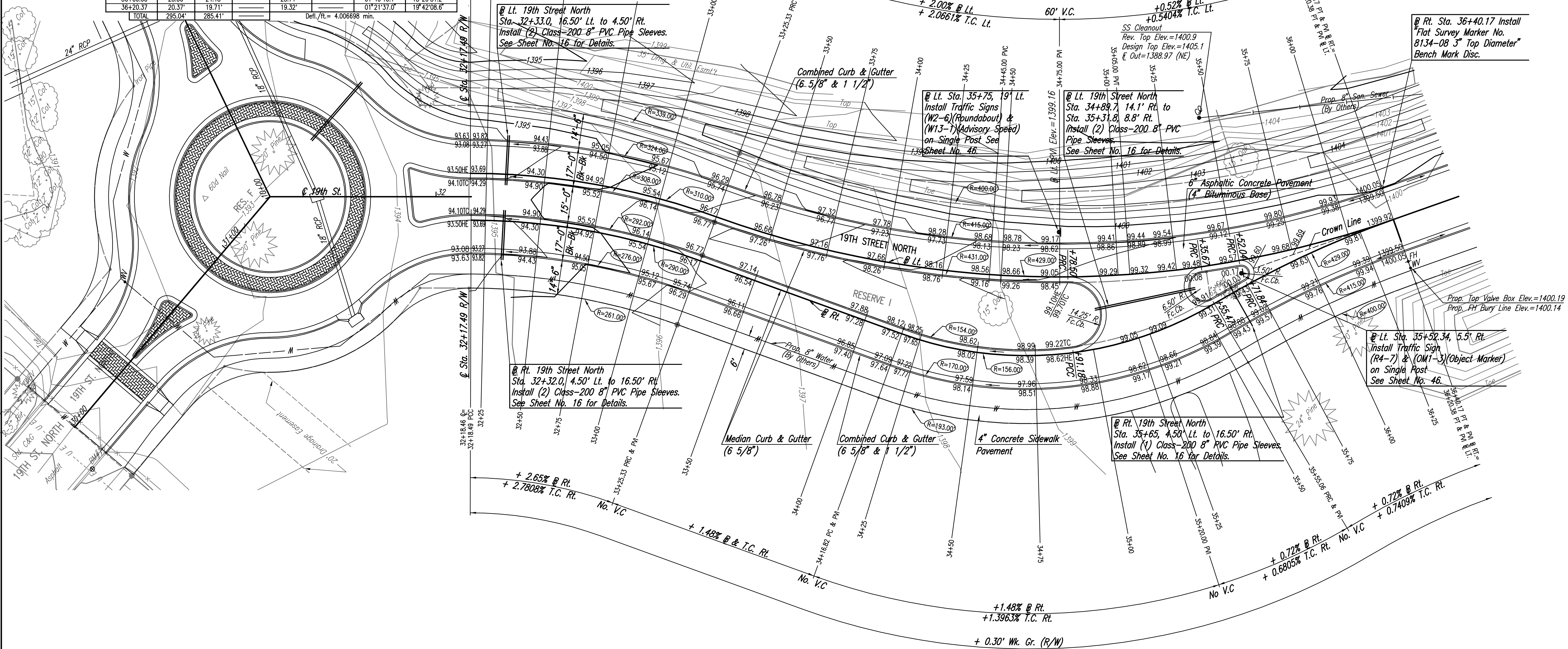
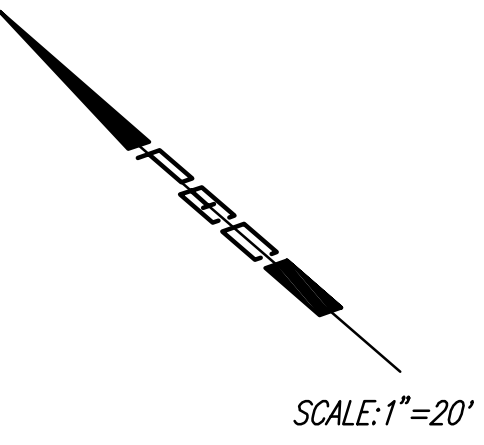

RT. CURVE DATA
 A=50°46'19" L D=36° 43' 41" R=156.00' L=138.24' T=74.03' E=16.67'
 CURVE DATA BASED ON @ Rt. radius Δ/2= 25° 23' 9.5"

STATION	ARC LENGTH	FACE CURB LENGTH		CHORD LENGTH		DEFLECTION ANGLE	TOTAL DEFLECTION
		LEFT CURB	RIGHT CURB	8' OFF LEFT FACE CURB	8' OFF RIGHT FACE CURB		
34+16.82						0°00'00.0"	0°00'00.0"
34+25.00	8.18'		8.91'	9.33'		01°30'07.8"	01°30'07.8"
34+50.00	25.00'		27.24'	28.50'		04°35'27.6"	06°05'35.5"
34+75.00	25.00'		27.24'	28.50'		04°35'27.6"	10°41'03.1"
34+91.18	16.18'		17.63'	18.45'		02°58'16.7"	13°39'19.8"
35+00.00	8.82'		9.61'	10.06'		01°37'11.0"	15°16'30.8"
35+25.00	25.00'		27.24'	28.50'		04°35'27.6"	19°51'58.4"
35+50.00	25.00'		27.24'	28.50'		04°35'27.6"	24°27'26.1"
35+55.06	5.06'		5.51'	5.77'		00°55'45.2"	25°23'09.6"
TOTAL	138.24'		150.64'				

Defl./ft. = 11.018419 min.

RT. CURVE DATA
 A=11°22'1" R D=13° 21' 20.4" R=429.00' L=85.11' T=42.69' E=2.12'
 CURVE DATA BASED ON @ Rt. radius Δ/2= 5° 41' 5"

STATION	ARC LENGTH	FACE CURB LENGTH		CHORD LENGTH		DEFLECTION ANGLE	TOTAL DEFLECTION
		LEFT CURB	RIGHT CURB	8' OFF LEFT FACE CURB	8' OFF RIGHT FACE CURB		
35+55.06						0°00'00.0"	0°00'00.0"
35+55.47	0.41'		0.40'		0.39'	00°01'38.6"	00°01'38.6"
35+71.84	16.37'		15.84'		15.84'	01°05'35.4"	01°07'13.9"
35+75.00	3.16'		3.06'		3.00'	00°12'39.7"	01°19'53.6"
36+00.00	25.00'		24.18'		23.71'	01°40'10.1"	03°00'03.7"
36+25.00	25.00'		24.18'		23.71'	01°40'10.1"	04°40'13.7"
36+40.17	15.17'		14.67'		14.39'	01°00'46.9"	05°41'5.5"
TOTAL	85.11'		82.33'				

Defl./ft. = 4.006698 min.

Revision By Date

OAK CREEK 2ND - PHASE 2

19TH STREET NORTH
 STA. 31+00 TO STA. 36+00
 JAMES L. ARMOUR, P.E. - CITY ENGINEER
 CITY OF WICHITA PROJECT NO. 472-84449

Professional Engineering Consultants, P.A.
 303 S. TOPKA • WICHITA, KANSAS 67202
 316-262-2691 • FAX 316-262-3003

Designed by BDB, BMM Job No. 35-05731-003
 Drawn by BJS, TAT Date February 2006 Sheet 10 of 84

Scaled 11-06-2006 1:54:46 PM by BEJ
 Plot Scale 1:20 11-07-2006 11:56:54 AM by BEJ
 J:\SENTOUT\2005\05231\003\2006-11-07 to City\DWG\10-19TH ST NORTH-STR31-36