

WATER VALVE BOX ELEVATIONS			
STREET	STATION	OFFSET	PROPOSED ELEVATION
19th STREET NORTH	Sta. 48+04.98	22.0' Rt.	1388.59

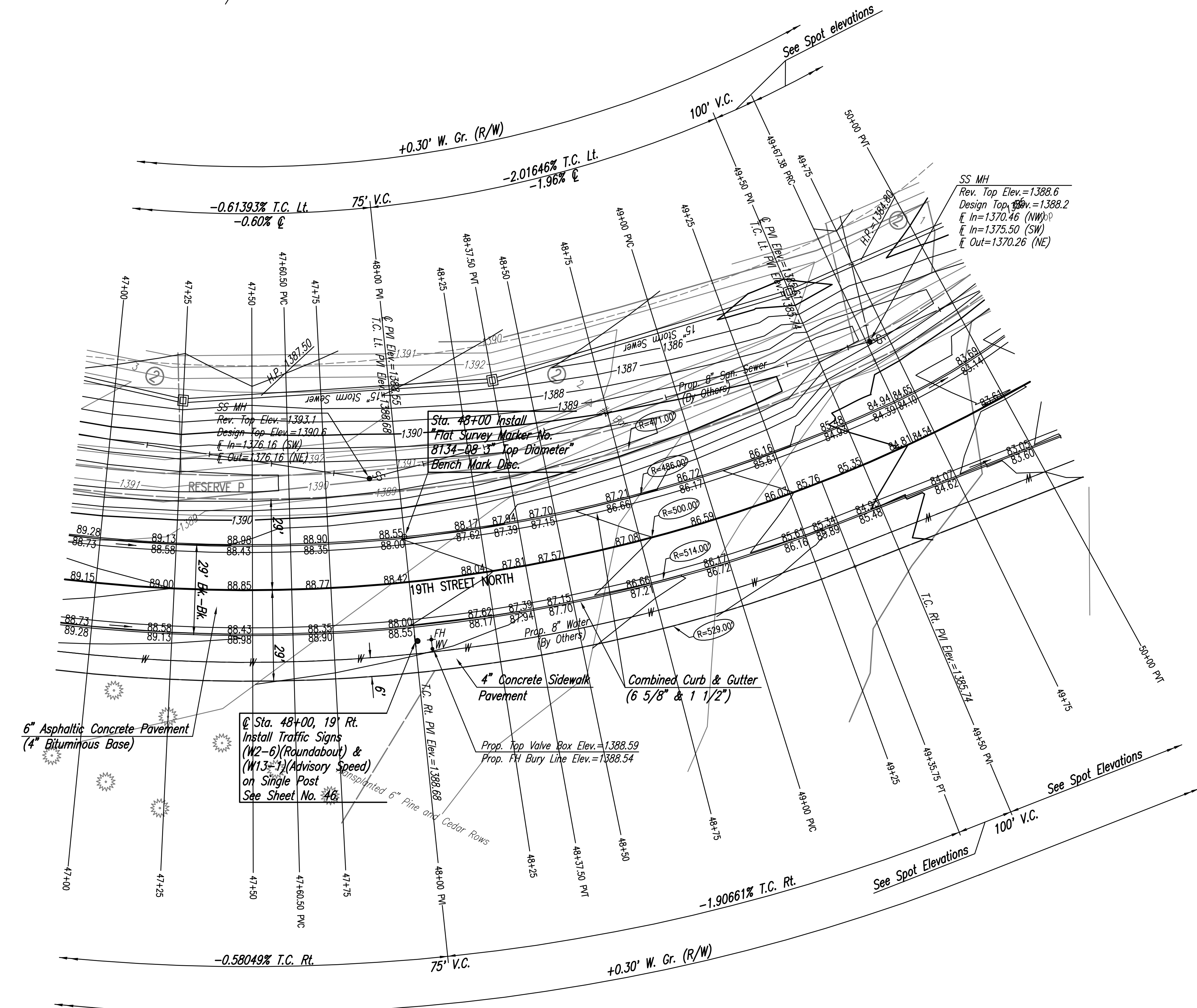
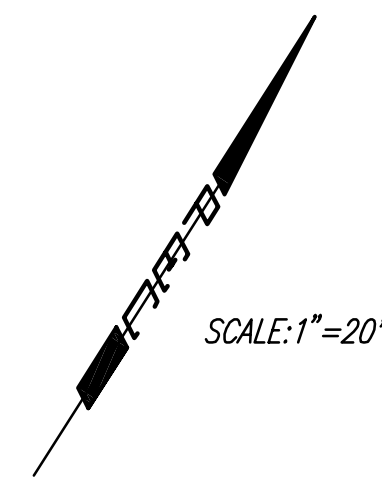

**Q CURVE DATA**

A=108°19'21" L D=11° 27' 33" R=500.00' L=945.29' T=692.28' E=353.96'

CURVE DATA BASED ON Q radius Δ/2= 54° 9' 40.5"

Q STATION	Q ARC LENGTH	FACE CURB LENGTH		CHORD LENGTH		DEFLECTION ANGLE	Q TOTAL DEFLECTION
		LEFT CURB	RIGHT CURB	8' OFF LEFT FACE CURB	8' OFF RIGHT FACE CURB		
40+90.63						0°00'00.0"	0°00'00.0"
41+00.00	9.37'	9.11'	9.63'	8.96'	9.78'	00°32'12.7"	00°32'12.7"
41+25.00	25.00'	24.30'	25.70'	23.90'	26.10'	01°25'56.6"	01°58'09.3"
41+50.00	25.00'	24.30'	25.70'	23.90'	26.10'	01°25'56.6"	03°24'6"
41+75.00	25.00'	24.30'	25.70'	23.90'	26.10'	01°25'56.6"	04°50'02.6"
42+00.00	25.00'	24.30'	25.70'	23.90'	26.10'	01°25'56.6"	06°15'59.2"
42+25.00	25.00'	24.30'	25.70'	23.90'	26.10'	01°25'56.6"	07°41'55.8"
42+50.00	25.00'	24.30'	25.70'	23.90'	26.10'	01°25'56.6"	09°07'52.4"
42+75.00	25.00'	24.30'	25.70'	23.90'	26.10'	01°25'56.6"	10°33'49.1"
43+00.00	25.00'	24.30'	25.70'	23.90'	26.10'	01°25'56.6"	11°59'45.7"
43+25.00	25.00'	24.30'	25.70'	23.90'	26.10'	01°25'56.6"	13°25'42.3"
43+50.00	25.00'	24.30'	25.70'	23.90'	26.10'	01°25'56.6"	14°51'38.9"
43+75.00	25.00'	24.30'	25.70'	23.90'	26.10'	01°25'56.6"	16°17'35.6"
44+00.00	25.00'	24.30'	25.70'	23.90'	26.10'	01°25'56.6"	17°43'32.2"
44+25.00	25.00'	24.30'	25.70'	23.90'	26.10'	01°25'56.6"	19°09'28.8"
44+50.00	25.00'	24.30'	25.70'	23.90'	26.10'	01°25'56.6"	20°35'25.4"
44+75.00	25.00'	24.30'	25.70'	23.90'	26.10'	01°25'56.6"	22°01'22.1"
45+00.00	25.00'	24.30'	25.70'	23.90'	26.10'	01°25'56.6"	23°27'18.7"
45+25.00	25.00'	24.30'	25.70'	23.90'	26.10'	01°25'56.6"	24°53'15.3"
45+50.00	25.00'	24.30'	25.70'	23.90'	26.10'	01°25'56.6"	26°19'11.9"
45+75.00	25.00'	24.30'	25.70'	23.90'	26.10'	01°25'56.6"	27°45'08.6"
46+00.00	25.00'	24.30'	25.70'	23.90'	26.10'	01°25'56.6"	29°11'05.2"
46+25.00	25.00'	24.30'	25.70'	23.90'	26.10'	01°25'56.6"	30°37'01.8"
46+50.00	25.00'	24.30'	25.70'	23.90'	26.10'	01°25'56.6"	32°02'58.4"
46+75.00	25.00'	24.30'	25.70'	23.90'	26.10'	01°25'56.6"	33°28'55.1"
47+00.00	25.00'	24.30'	25.70'	23.90'	26.10'	01°25'56.6"	34°54'51.7"
47+25.00	25.00'	24.30'	25.70'	23.90'	26.10'	01°25'56.6"	36°20'48.3"
47+50.00	25.00'	24.30'	25.70'	23.90'	26.10'	01°25'56.6"	37°46'44.9"
47+75.00	25.00'	24.30'	25.70'	23.90'	26.10'	01°25'56.6"	39°12'41.6"
48+00.00	25.00'	24.30'	25.70'	23.90'	26.10'	01°25'56.6"	40°38'38.2"
48+25.00	25.00'	24.30'	25.70'	23.90'	26.10'	01°25'56.6"	42°04'34.8"
48+50.00	25.00'	24.30'	25.70'	23.90'	26.10'	01°25'56.6"	43°30'31.4"
48+75.00	25.00'	24.30'	25.70'	23.90'	26.10'	01°25'56.6"	44°56'28.1"
49+00.00	25.00'	24.30'	25.70'	23.90'	26.10'	01°25'56.6"	46°22'24.7"
49+25.00	25.00'	24.30'	25.70'	23.90'	26.10'	01°25'56.6"	47°48'21.3"
49+50.00	25.00'	24.30'	25.70'	23.90'	26.10'	01°25'56.6"	49°14'17.9"
49+75.00	25.00'	24.30'	25.70'	23.90'	26.10'	01°25'56.6"	50°40'14.6"
50+00.00	25.00'	24.30'	25.70'	23.90'	26.10'	01°25'56.6"	52°06'11.2"
50+25.00	25.00'	24.30'	25.70'	23.90'	26.10'	01°25'56.6"	53°32'07.8"
50+35.92	10.92'					00°37'32.4"	54°09'40.7"
TOTAL	945.29'	852.20'	868.78'				

Defl./ft. = 3.437747 min.

Served 11-06-2006 3:49:38 PM by BJS  
 Plot Scale 1:20 11-07-2006 12:05:48 PM by BEJ  
 J:\SENTOUT\2005\05231\003\2006-11-07 to City DMC\13-19TH ST NORTH-STR47-50

No.	Revision	By	Date
OAK CREEK 2ND - PHASE 2 <b>19TH STREET NORTH</b> STA. 47+00 TO STA. 50+00 JAMES L. ARMOUR, P.E. - CITY ENGINEER CITY OF WICHITA PROJECT NO. 472-84449 <b>Professional Engineering Consultants, P.A.</b> 303 S. TOPKA • WICHITA, KANSAS 67202 316-262-2691 • FAX 316-262-3003			
Designed by	BDB, BMM	Job No.	35-05731-003
Drawn by	BJS, TAT	Date	February 2006
			Sheet 13 of 84