

Saved: 11-07-2006 5:33:52 AM by BJS
 Plot Scale: 1:10 11-07-2006 12:01:30 PM by BEJ
 J:\SENTOUT\2005\05731\003\2006-11-07 to City DMV\2-ROUNDABOUT_COORDINATE_2

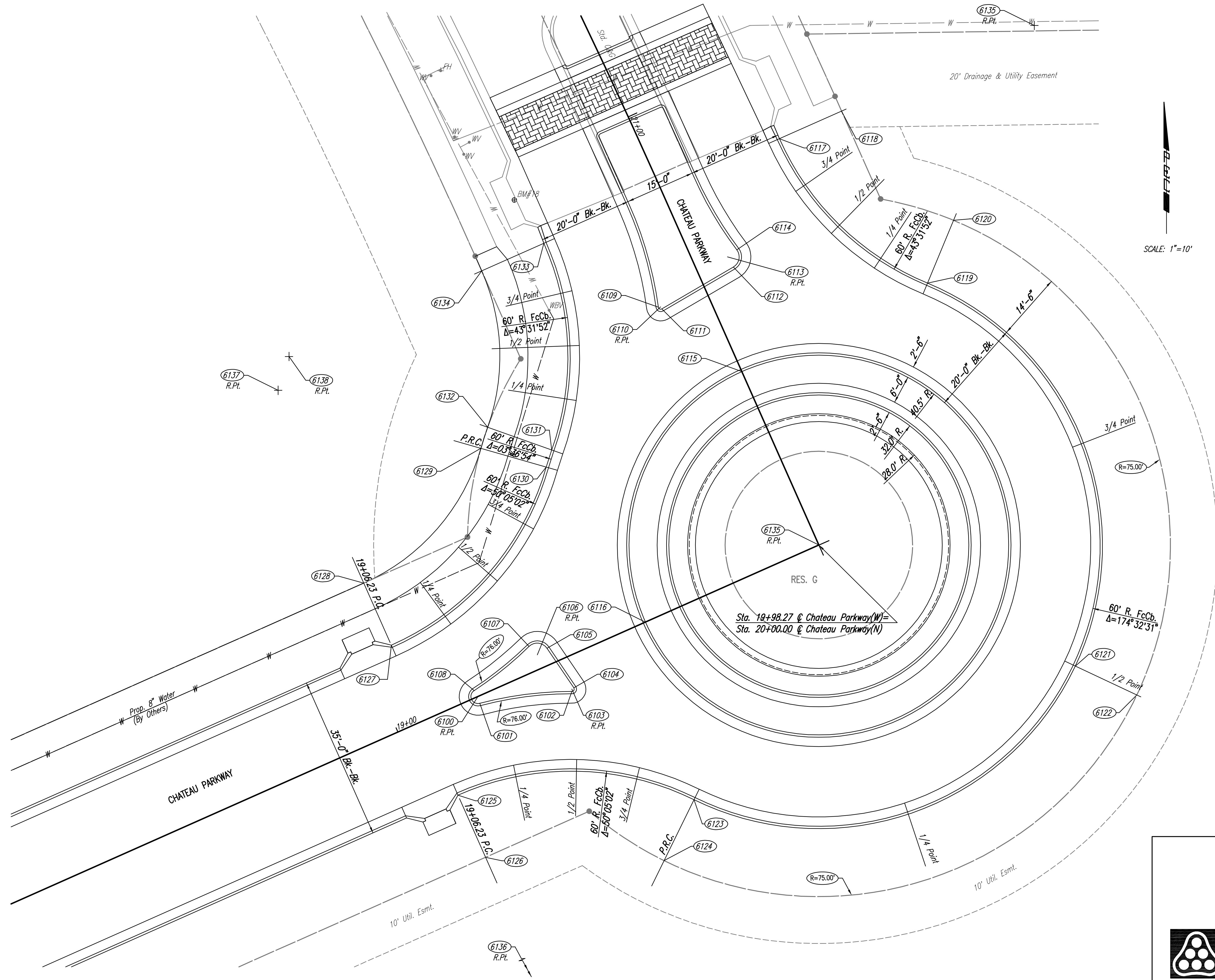

COORDINATE LIST		
POINT	NORTH	EAST
6100	386,466.2548	2,372,116.5909
6101	386,464.8043	2,372,116.9732
6102	386,467.3296	2,372,136.6244
6103	386,467.8296	2,372,136.6254
6104	386,468.1104	2,372,137.0391
6105	386,476.5467	2,372,131.3139
6106	386,475.1429	2,372,129.2453
6107	386,476.9287	2,372,127.4957
6108	386,467.5109	2,372,115.7711
6109	386,549.3038	2,372,155.0700
6110	386,549.3700	2,372,155.5656
6111	386,548.9386	2,372,155.8183
6112	386,557.8815	2,372,171.0824
6113	386,560.0385	2,372,169.8186
6114	386,561.5437	2,372,171.8147
6115	386,535.5734	2,372,172.8889
6116	386,482.1207	2,372,152.3142
6117	386,585.2571	2,372,180.9129
6118	386,591.1427	2,372,194.1647
6119	386,554.4459	2,372,212.5009
6120	386,567.8401	2,372,218.0548
6121	386,472.7521	2,372,244.0473
6122	386,466.5668	2,372,257.1619
6123	386,444.2458	2,372,162.6774
6124	386,431.2285	2,372,156.2900
6125	386,445.2078	2,372,112.3160
6126	386,431.9560	2,372,118.2016
6127	386,477.1949	2,372,098.1095
6128	386,490.4467	2,372,092.2239
6129	386,519.1930	2,372,117.2219
6130	386,515.2039	2,372,131.1624
6131	386,518.8386	2,372,132.3277
6132	386,523.6983	2,372,118.6663
6133	386,562.9326	2,372,130.6475
6134	386,557.0470	2,372,117.3957
6135	386,609.4083	2,372,235.2910
6136	386,390.8298	2,372,136.4672
6137	386,531.5730	2,372,073.9584
6138	386,538.7814	2,372,076.2694

6100 = COORDINATE POINT NO.
 SEE SHEET NOS. 3 & 4 FOR PLAT COORDINATES

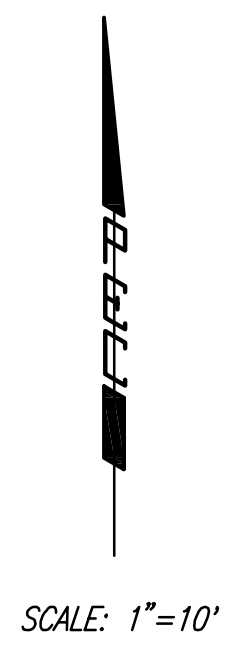

No.	Revision	By	Date
	OAK CREEK 2ND - PHASE 2		
ROUNDABOUT COORDINATE PLAN			
STA. 19+98.27			
JAMES L. ARMOUR, P.E. - CITY ENGINEER CITY OF WICHITA PROJECT NO. 472-84449			
Professional Engineering Consultants, P.A.			
303 S. TOPKA • WICHITA, KANSAS 67202 316-262-2691 • FAX 316-262-3003			
Designed by	BDB, BMM	Job No.	35-05731-003
Drawn by	BJS, TAT	Date	February 2006
			Sheet 22 of 84

