

PLAN	CHECKED	DATE
	CHECKED	

PROFILE	CHECKED	DATE
	CHECKED	

S:\11-06-2006 5:34:34 PM by BIS
 Plot Scale 1:20 11-07-2006 12:20:13 PM by BEJ
 J:\SENTOU\2005\02731\003\2006-11-07 to CIV\DWG\28-SWS LINE NO 2

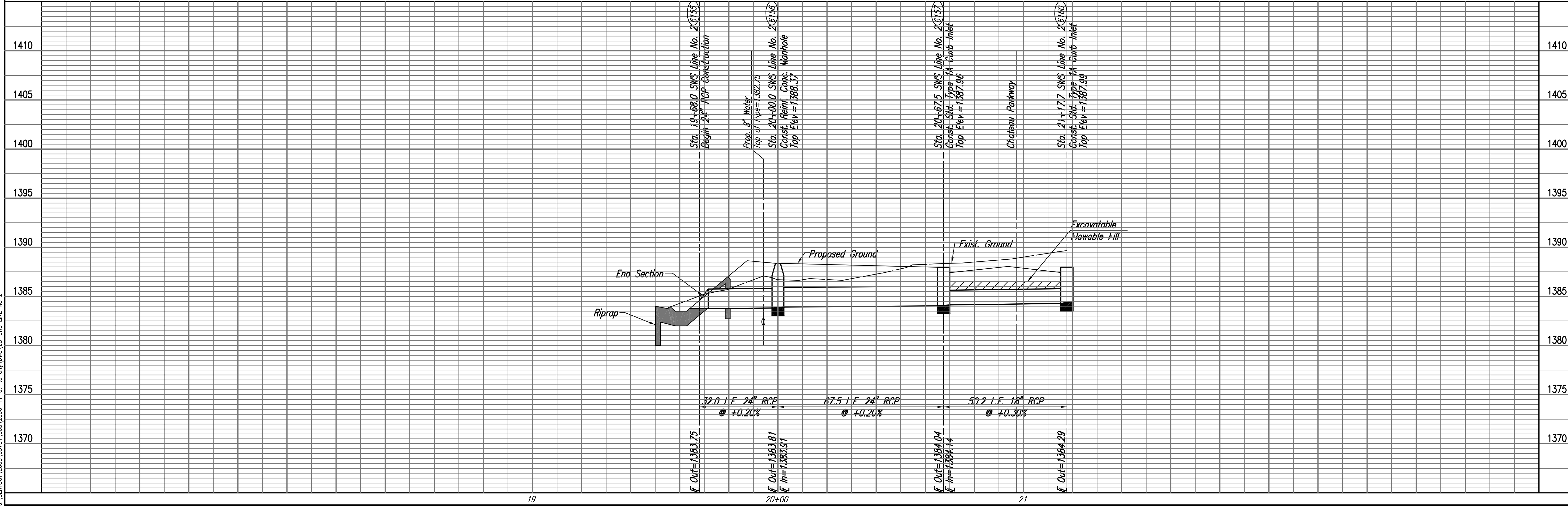

CAUTION !!!
 Proposed 8" Water
 City of Wichita

Install 25 S.Y.
 Light Stone Riprap
 See Sheet No. 36.

Sta. 19+68.0 SWS Line No. 2
 Begin 24" RCP Construction
 Install 32.0 L.F. 24" RCP (SE)
 (Including End Section)

Sta. 20+00.0 SWS Line No. 2=
 @ 2 Chateau Parkway Sta. 14+00.00, 20.67' Lt.
 Const. Reinforced Conc. Manhole
 Dia.=4'-0"
 Top Elev.=1388.37
 Install 67.5 L.F. 24" RCP (SW)
 See Sheet No. 33.

Install 46 L.F.
 Excavatable Flowable
 Fill to Elev. 1386.5

Sta. 21+17.7 SWS Line No. 2=
 @ 1=Chateau Parkway Sta. 13+30.00, 20.67' Rt.
 Const. Std. Type 1A Curb Inlet
 L=5'-0", W=3'-0"
 Top Elev.=1387.99
 See Sheet No. 31.

