

NOTE BOOK NO.	TEMPLATE AREAS CHECKED

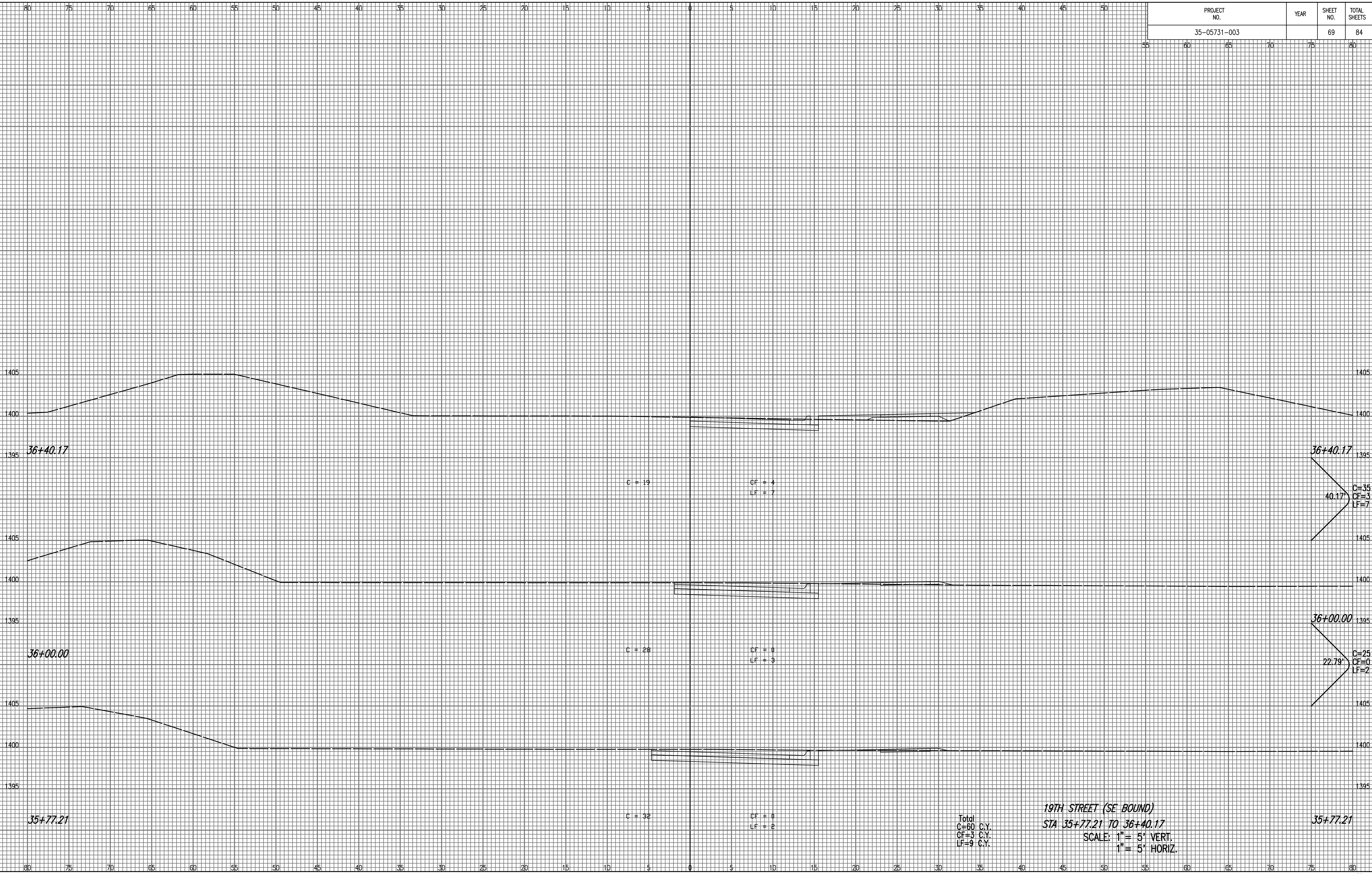

Total
 C=60 C.Y.
 CF=3 C.Y.
 LF=9 C.Y.

19TH STREET (SE BOUND)
 STA 35+77.21 TO 36+40.17
 SCALE: 1" = 5' VERT.
 1" = 5' HORIZ.

SAVED 11-06-2006 11:17:06 AM BY BUS
 Plot Scale 1:1 11-07-2006 12:56:24 PM BY BEJ
 J:\SEN001\2005\05731\003\2006-11-07 to City Dwg\03-CROSS SECTION