

**BENCHMARKS:**  
 BM #1: "C" Cut on Top of Curb at West Line of Lot 7, Block A, Auburn Hills 5th Addition. Elev. = 207.73 (City Datum)

BM #2: Disc in Back of Curb, North of Front Corner Common to Lots 23 and 24, Block D, Auburn Hills 12th Addition. Elev. = 191.84 (City Datum)

BM #3: "C" Cut in Middle of Curb Inlet Top Adjacent to the South Corner of Lot 15, Block B. Elev. = 196.44 (City Datum)

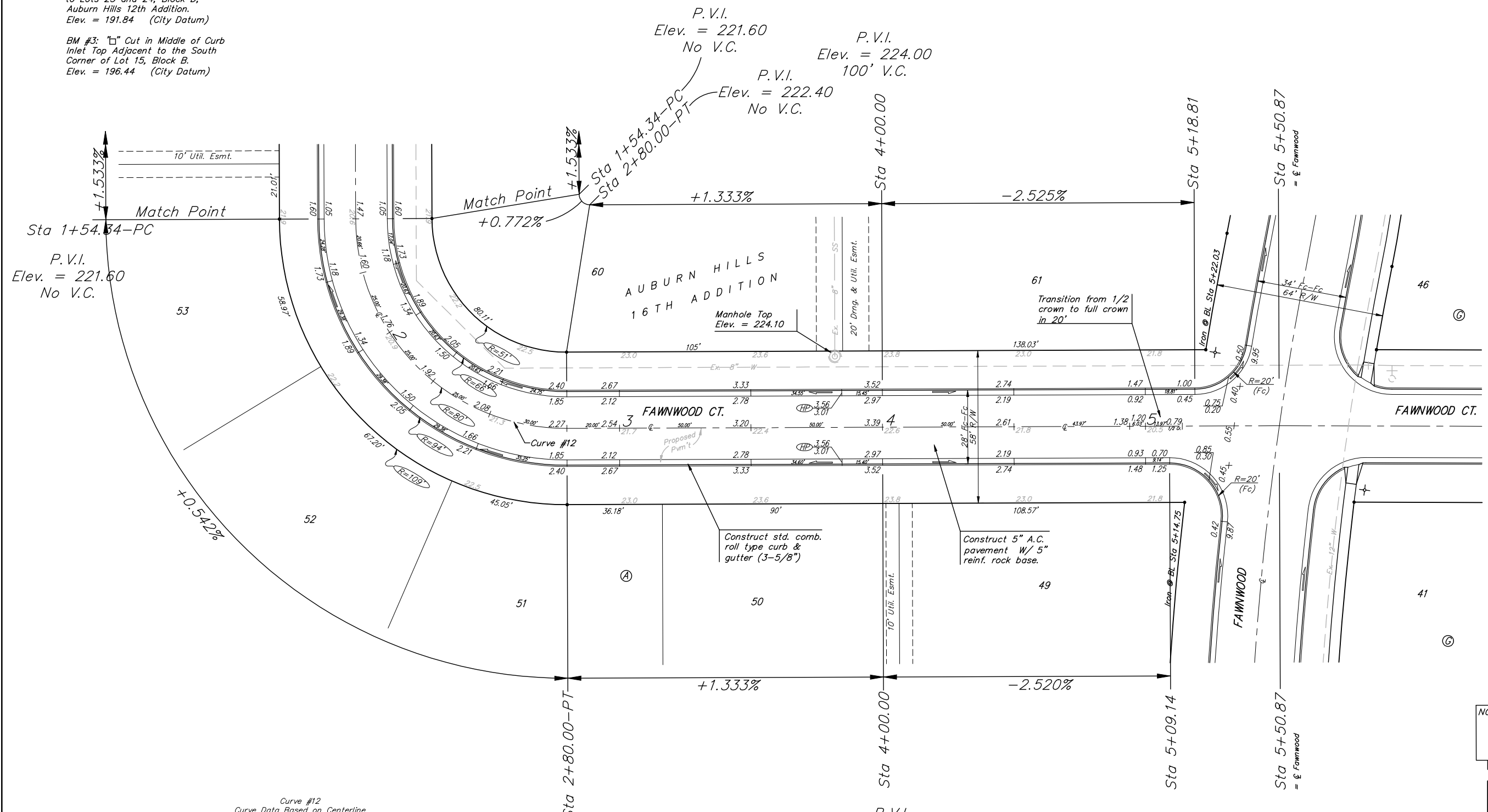
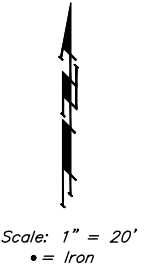

Curve #12  
 Curve Data Based on Centerline  
 Rad. = 80' Delta = 90°00'00" Tangent = 80.00'  
 Arc = 125.66' L.C. = 113.14' Def/Ft. = 21.48655 Min.

Station	Arc	FACE CHORD LENGTHS		Defl.	T. Defl.
		8' Lt.	8' Rt.		
1+54.34	-	-	-	0°00'00"	0°00'00"
1+75.00	20.66'	14.94'	26.27'	7°23'55"	7°23'55"
2+00.00	25.00'	18.05'	31.75'	8°57'10"	16°21'04"
2+25.00	25.00'	18.05'	31.75'	8°57'10"	25°18'14"
2+50.00	25.00'	18.05'	31.75'	8°57'10"	34°15'24"
2+75.00	25.00'	18.05'	31.75'	8°57'10"	43°12'34"
2+80.00	5.00'	3.62'	6.37'	1°47'26"	45°00'00"

P.V.I.  
 Elev. = 222.40  
 No V.C.

P.V.I.  
 Elev. = 224.00  
 100' V.C.

**NOTE:** ROLL TYPE CURB & GUTTER TO BE CONSTRUCTED ON THE PAVEMENT SHOWN ON THIS SHEET. TOP OF CURB ELEVATIONS ARE GIVEN FOR FULL HEIGHT CURB.

Trees and shrubs in public right-of-way which are in direct conflict with proposed new construction shall be removed by the Contractor ONLY with the Developer or Baughman Company approval. Trees and shrubs which are not in direct conflict with proposed new construction shall be saved and protected from damage.

**Baughman** ENGINEERING | SURVEYING | PLANNING | LANDSCAPE ARCHITECTURE

AUBURN HILLS 16TH ADD. - PH. II  
**FAWNWOOD CT.**  
 LOTS 49-61, BLOCK A  
 Sta 1+54.34 to Sta 5+50.87

PROJECT NUMBER: 472-84291  
 REVISIONS:

DESIGN: AEO  
 APPROVED: [Signature]  
 SCALE: Noted  
 SHEET: **14 OF 61**

Drawn: TMS  
 Date: 06/06

AuburnHills16thPhaseII.cdw 06-02-E502