

- CLEARING AND GRUBBING SHALL INCLUDE CLEARING AND DISPOSAL OF ALL TREES, BUSHES, VEGETATION, ROOTS AND RELATED ITEMS WITHIN THE PROJECT LIMITS.
- CONTRACTOR SHALL BE RESPONSIBLE FOR VERIFICATION OF LOCATION OF ALL UTILITIES PRIOR TO EXCAVATION. DAMAGE TO ANY UTILITIES OR STRUCTURES DURING EXCAVATION AND CONSTRUCTION OF PROPOSED SANITARY SEWER MAINS SHALL BE THE RESPONSIBILITY OF THE CONTRACTOR.
- EVERY EFFORT HAS BEEN MADE TO LOCATE AND SIZE ALL UNDERGROUND UTILITIES FROM AVAILABLE CITY DOCUMENTS. ON-SITE SURVEYS AND UTILITY COMPANY REFERENCE MATERIAL. CONTRACTOR SHALL EXERCISE EXTREME CARE AND CAUTION IN OTHER DANGEROUS UNDERGROUND AND OVERHEAD OBSTRUCTIONS EXIST AND ARE NOT SHOWN ON THE PLAN AND PROFILE SHEETS. WHEN LINES OR OTHER OBSTRUCTIONS TO PROTECT THE LINES AND IMMEDIATELY NOTIFY THE OWNER, UTILITY COMPANY AND ENGINEER.
- ALL EXCAVATED MATERIAL DEEMED UNSUITABLE BY THE ENGINEER SHALL BE REMOVED AND LEGALLY DISPOSED OF OFF SITE. REPLACE WITH ACCEPTABLE MATERIAL AS DIRECTED BY THE ENGINEER.
- ALL ELEVATIONS SHOWN ON THIS PLAN ARE EXISTING.
- SEE SITE UTILITIES PLAN FOR SANITARY SEWER, & WATER ABANDONMENT, REPAIRING, & REMOVAL REQUIREMENTS.
- REMOVE ALL TOPSOIL & VEGETATION IN ALL AREAS WITHIN SITE LIMITS NOT INDICATED TO REMAIN.
- REMOVE & LEGALLY DISPOSE OF ALL EXCAVATED PIPE FROM CONSTRUCTION AREA.
- PROTECT ANY EXISTING ON-SITE SERVICES DURING CONSTRUCTION.
- CONTRACTOR TO SALVAGE ALL EXISTING TRAFFIC & INFORMATIONAL SIGNAGE & DELIVER TO CITY OF WICHITA AS DIRECTED.
- ALL WATER YAWNS THROUGHOUT PLAN TO BE ADJUSTED TO FINISH GRADE ELEVATIONS
- ALL CURB WITHIN THE PROJECT LIMITS IS TO BE REMOVED UNLESS OTHERWISE INDICATED ON THE DEMOLITION PLAN.

GENERAL INTENT NOTES

13. THE PANS AND REFERENCED CONSTRUCTION SPECIFICATIONS DESCRIBE THE WORK FOR CONSTRUCTION. THESE PLANS ARE INTENDED TO BE FULLY EXPLANATORY. THE PLAN AND SPECIFICATION DOCUMENTS SHALL BE CONSIDERED AND INTERPRETED AS A WHOLE AND THEREFORE ANYTHING SHOWN, INDICATED OR SPECIFIED IN ONE AND NOT THE OTHER, SHALL BE INTERPRETED AS BEING SHOWN, INDICATED OR SPECIFIED OR BOTH.

16. MINOR DEVIATIONS FROM THE DESIGN LAYOUT ARE ANTICIPATED AND SHALL BE CONSIDERED INCIDENTAL OF THE WORK CAN BE MADE OR WILL BE PERMITTED BY THE OWNER WITHOUT THE ISSUANCE OF A CHANGE ORDER.

17. NO PLEA OF IGNORANCE OF EXISTING CONDITIONS OR OF DIFFICULTIES OR CONDITIONS ENCOUNTERED IN THE EXECUTION OF THE WORK WILL BE ACCEPTED AS AN EXCUSE FOR ANY FAILURE OR OMISSION ON THE PART OF THE CONTRACTOR TO FULFILL EXACT DETAIL OF ALL OF THE REQUIREMENTS IN THE CONTRACT DOCUMENTS GOVERNING THE WORK.

Survey Legend	
	CONCRETE PAVING
	AIR VALVE (BELOW-OFF VALVE)
	AIR VALVE (ABOVE-OFF VALVE)
	ASPHALT PAVING
	UNDERGROUND STORM SEWER
	UNDERGROUND TELEPHONE CABLE
	UNDERGROUND SANITARY SEWER
	UNDERGROUND GAS
	OVERHEAD CABLE
	OVERHEAD POWER CABLE (PUG)
	ELECTRIC MANHOLE
	FIRE HYDRANT
	CLEAN OUT
	GAS METER
	GAS VALVE
	GAS WYE
	IRON Pn (GROUND)
	IRON Pn (SET)
	LIGHT POLE
	MAIL BOX
	SANITARY SEWER MANHOLE
	STORM SEWER MANHOLE
	TELEPHONE MANHOLE
	STORM SEWER INLET
	POWER POLE OF (GROUND POST)
	RAILROAD
	HANDICAP PARKING
	SIGN
	TRAFFIC SIGNAL
	WATER METER
	WATER VALVE
	SPRINKLER VALVE
	4" SPIGOT
	6" SPIGOT
	MANHOLE WELL
	CONCRETE
	ASPHALT PAVING
	UNDERGROUND WATER
	UNDERGROUND STORM SEWER
	UNDERGROUND TELEPHONE CABLE
	UNDERGROUND SANITARY SEWER
	UNDERGROUND GAS
	OVERHEAD CABLE
	OVERHEAD POWER CABLE (PUG)
	ELECTRIC MANHOLE
	FIRE HYDRANT
	CLEAN OUT
	GAS METER
	GAS VALVE
	GAS WYE
	IRON Pn (GROUND)
	IRON Pn (SET)
	LIGHT POLE
	MAIL BOX
	SANITARY SEWER MANHOLE
	STORM SEWER MANHOLE
	TELEPHONE MANHOLE
	STORM SEWER INLET
	POWER POLE OF (GROUND POST)
	RAILROAD
	HANDICAP PARKING
	SIGN
	TRAFFIC SIGNAL
	WATER METER
	WATER VALVE
	SPRINKLER VALVE
	4" SPIGOT
	6" SPIGOT
	MANHOLE WELL
	CONCRETE

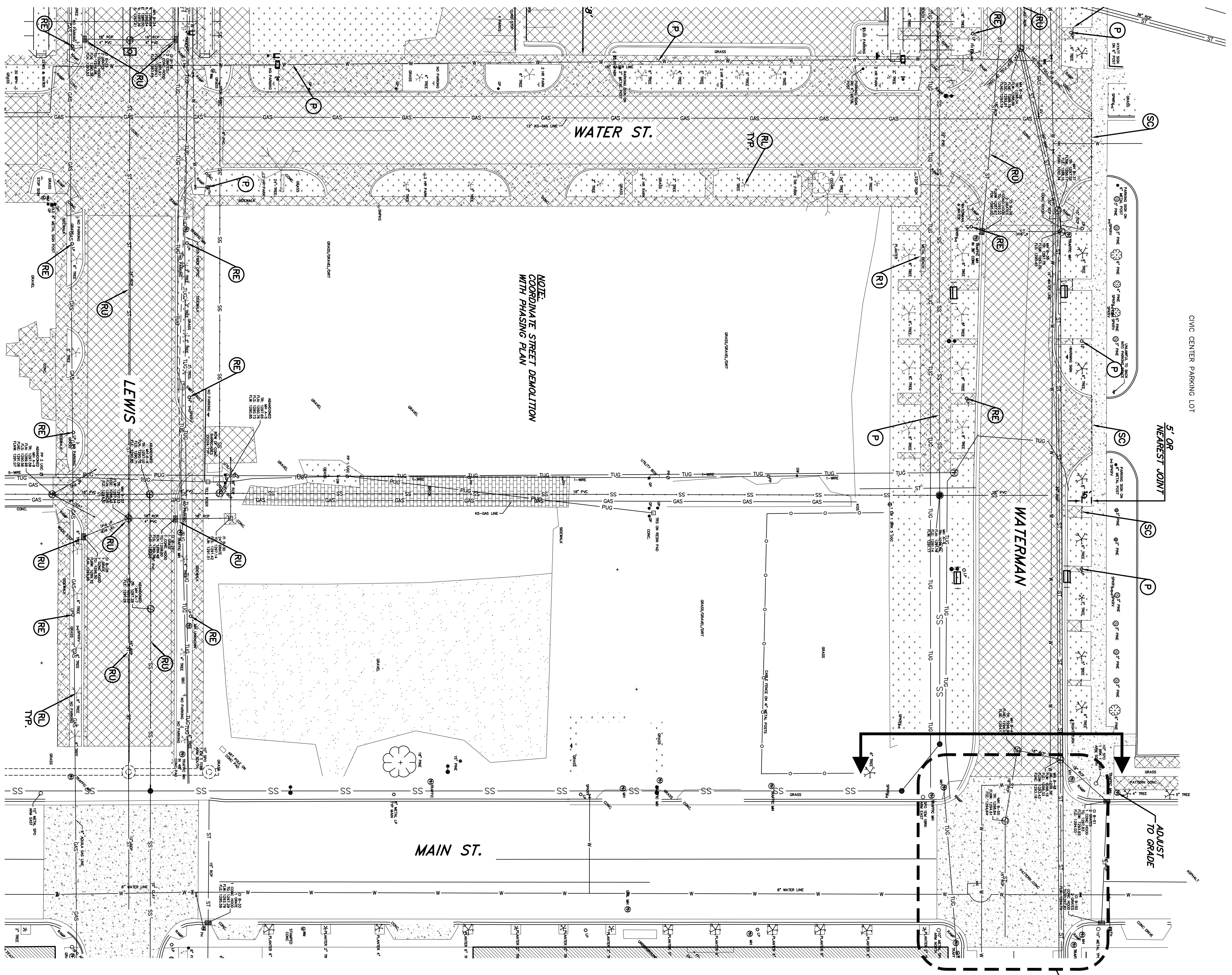

LEGEND	
	EXISTING ASPHALT TO BE REMOVED AND/OR CONCRETE CURB & CUTTER
	EXISTING CONCRETE TO BE REMOVED AND/OR CONCRETE CURB & CUTTER
	EXISTING ASPHALT
	REMOVE & LEGALLY DISPOSE OF ALL MATERIAL OFF-SITE.
	REMOVE & SALVAGE SUITABLE COMPONENTS FOR REUSE
	REPAIR BY OTHERS, NOT PART OF THIS CONTRACT.
	REMOVE & RETURN TO CITY OF WICHITA
	MAINTAIN & PROTECT IN PLACE SEE UTILITY PLAN FOR DETAILS
	SAW-CUT/REMOVAL LIMIT LINES CONTRACTOR TO SAW-CUT AS NECESSARY
	ELECTRIC POWER ITEMS TO BE REMOVED COORDINATE WITH ELECTRICAL COMPANY
	REMOVE/ABANDON ALL EXISTING UTILITIES RE: UTILITY PLANS
	REMOVE LANDSCAPING
	PROTECT EXISTING LANDSCAPING
	LIMITS OF DEMOLITION

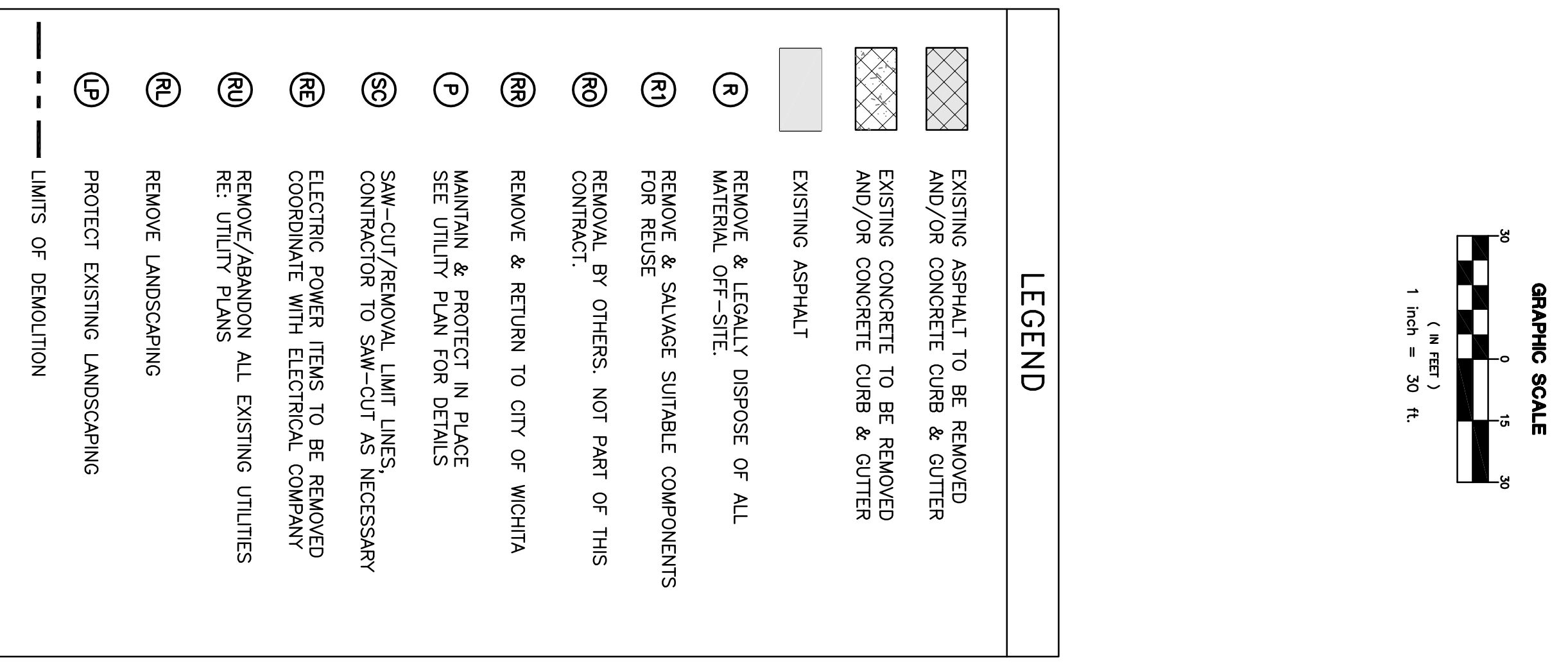

No.	Date	Description
05-30-06		BID SET
04-27-06		FIELD CHECK

Job No.	D1.1
Date	05-30-06
Drawn	IN
Checked	PB
Date	13 of 96

WICHITA WATERWALK

PUBLIC IMPROVEMENTS PHASE 2 PACKAGE 2

Johnson & Associates, Inc.
 100 E. California Ave. - Third Floor
 Oklahoma City, OK 73104
 (405) 235-8075 FAX (405) 235-8078
 Certificate of Authorization RE-1728 EXP. DATE: 12-31-2008

Gossell Livingston
 Architecture
 Wichita, KS 67202
 Tel: (316) 265-9387
 Fax: (316) 265-9446
 Email: gossell@glv.com