

BENCHMARK:
 BM #2 - Railroad Spike in the North Face of the Third Power Pole West of Ridge Road on the South Side of 37th Street North
 Sta. 57+38, 48' Rt.
 Elev. = 1333.43 MSL

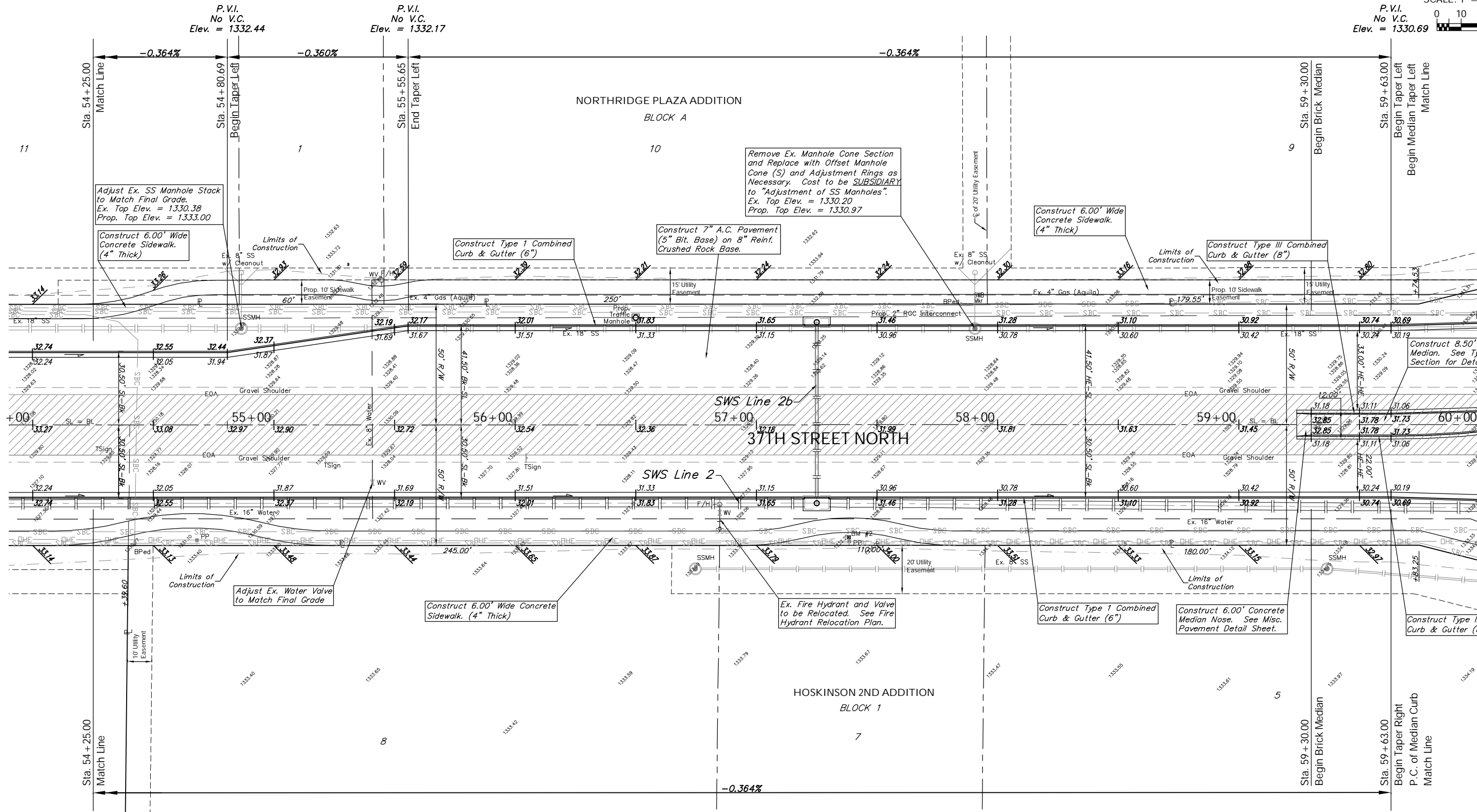
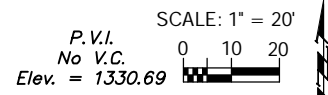

Adjust Ex. SS Manhole Stack to Match Final Grade.
 Ex. Top Elev. = 1330.38
 Prop. Top Elev. = 1333.00

Construct 6.00' Wide Concrete Sidewalk. (4\"

Construct Type I Combined Curb & Gutter (6\"

Construct 7\"

Construct 6.00' Wide Concrete Sidewalk. (4\"

Construct Type III Combined Curb & Gutter (8\"

Construct 8.50' Wide Brick Median. See Typical Section for Details.

Adjust Ex. Water Valve to Match Final Grade

Construct 6.00' Wide Concrete Sidewalk. (4\"

Ex. Fire Hydrant and Valve to be Relocated. See Fire Hydrant Relocation Plan.

Construct Type I Combined Curb & Gutter (6\"

Construct 6.00' Concrete Median Nose. See Misc. Pavement Detail Sheet.

Construct Type III Combined Curb & Gutter (8\"

Note:
 Pavement, Sidewalks, and Etc. To Be Removed Are Indicated By:

Drawing File: F:\37th Pave\37th Land\dwg\37th Base.dwg (Pav10)
 Project No. 04-01-E791 CAPITAL IMPROVEMENT PROJECT
37TH STREET NORTH PAVING
 Sta. 54 + 25.00 to Sta. 59 + 63.00
 37TH STREET NORTH - TYLER ROAD TO RIDGE ROAD

Baughman Company, P.A.
 315 Ellis St. Wichita, KS 67211 P 316-262-7271 F 316-262-0149
 ENGINEERING | SURVEYING | PLANNING | LANDSCAPE ARCHITECTURE