

BENCHMARK:  
 BM #9 - "I" in the South East Corner of the Concrete SBC Pad in the South West Corner of 37th Street North and Tyler Road  
 Sta. 8+56, 95' Rt.  
 Elev. = 1342.17 MSL

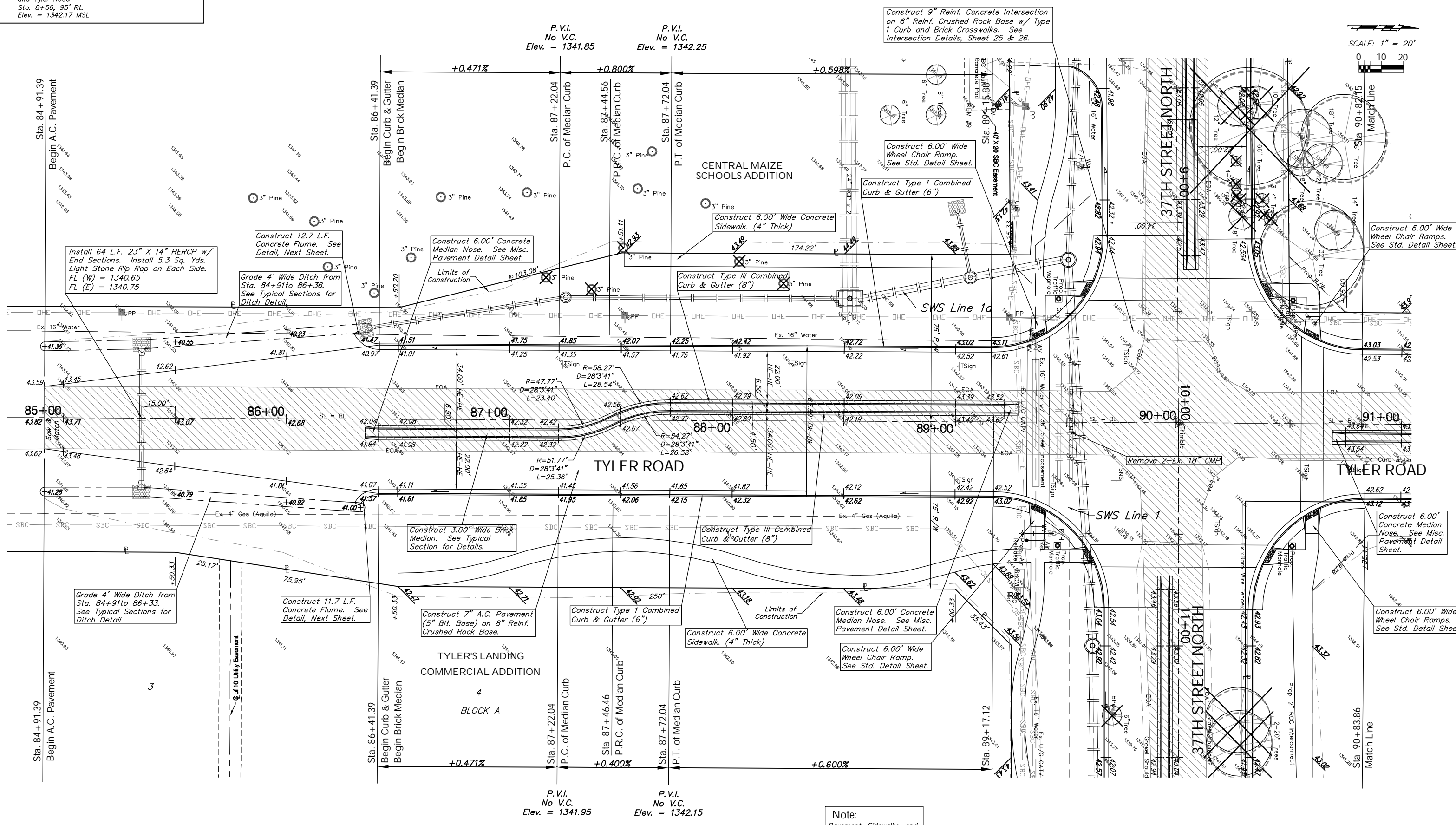
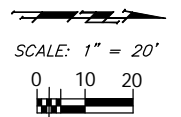

P.V.I. No V.C.  
Elev. = 1341.85

P.V.I. No V.C.  
Elev. = 1342.25

P.V.I. No V.C.  
Elev. = 1341.95

P.V.I. No V.C.  
Elev. = 1342.15

Note:  
Trees/Shrubs to be removed are marked thus:

Note:  
Pavement, Sidewalks, and Etc. To Be Removed Are Indicated By:

Drawing File: F:\37th Pav\37th Land\dwg\37th Base.dwg (Rev12)  
 Project No. 0401E791  
 CAPITAL IMPROVEMENT PROJECT  
**TYLER ROAD PAVING**  
 Sta. 84+91.39 to Sta. 90+83.86  
 37TH STREET NORTH - TYLER ROAD TO RIDGE ROAD

**Baughman Company, P.A.**  
 315 Ellis St. Wichita, KS 67211 P 316-262-7271 F 316-262-0149  
 ENGINEERING | SURVEYING | PLANNING | LANDSCAPE ARCHITECTURE