

BENCHMARK:  
 BM #2 - Railroad Spike in the North Face of the Third Power Pole West of Ridge Road on the South Side of 37th Street North  
 Sta. 57+38, 48' Rt.  
 Elev. = 1333.43 MSL

SCALE:  
 HORIZONTAL: 1" = 20'  
 VERTICAL: 1" = 5'

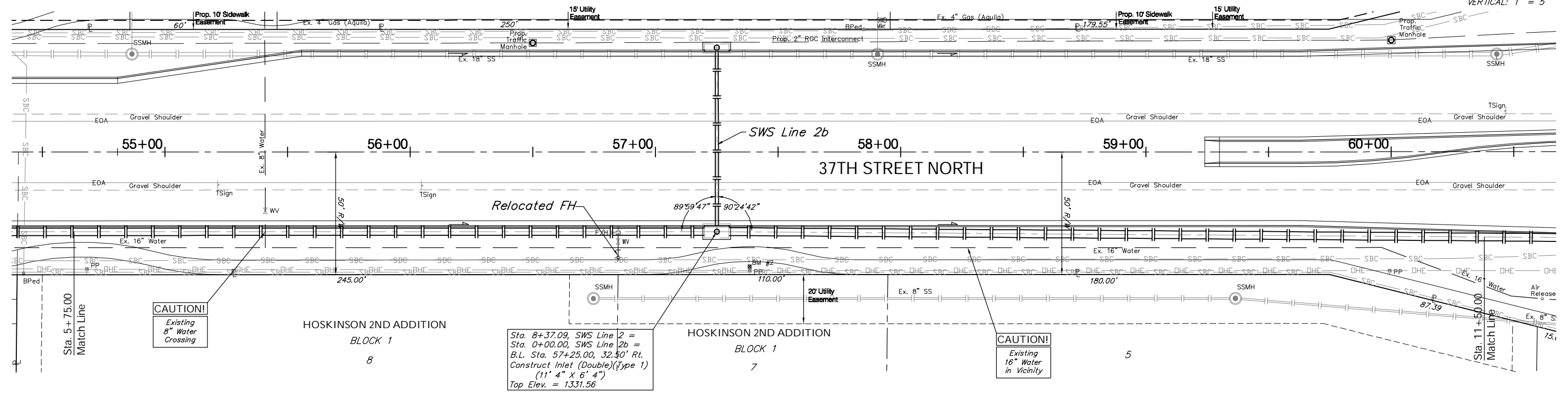

Sta. 8+37.09, SWS Line 2 =  
 Sta. 0+00.00, SWS Line 2b =  
 B.L. Sta. 57+25.00, 32.50' Rt.  
 Construct Inlet (Double) (Type 1)  
 (11' 4\"/>

CAUTION!  
 Existing 8\"/>

CAUTION!  
 Existing 16\"/>

