

FHWA REGION NO.	STATE	PROJECT NO.	FISCAL YEAR	SHEET NO.	TOTAL SHEETS
7	KANSAS	87 N-0346-01	2006	98	146

37TH STREET NORTH

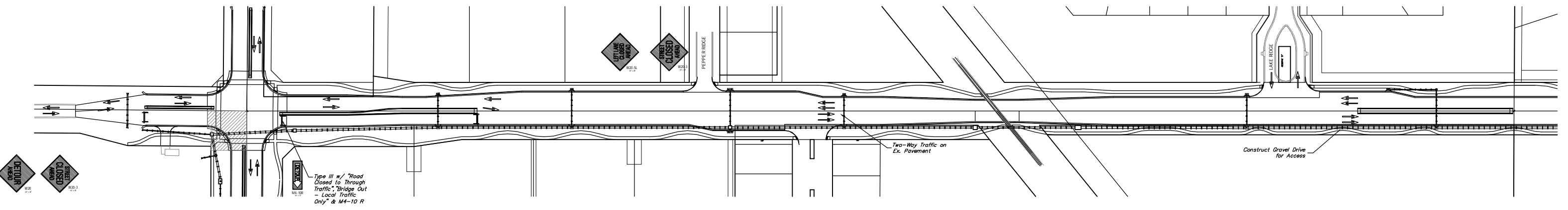

37TH STREET NORTH

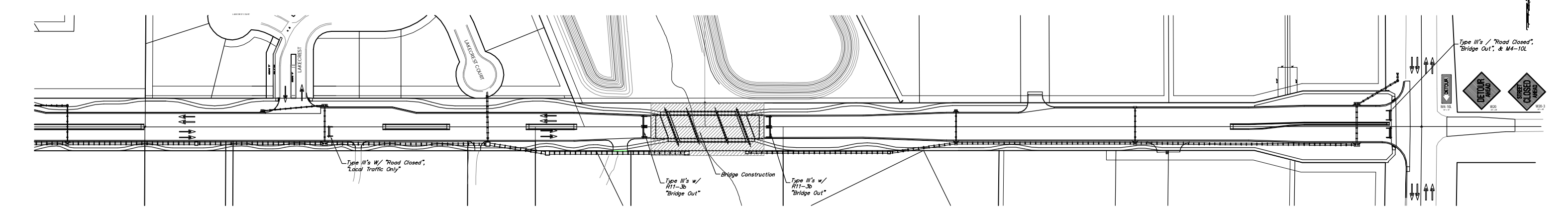

TYLER ROAD

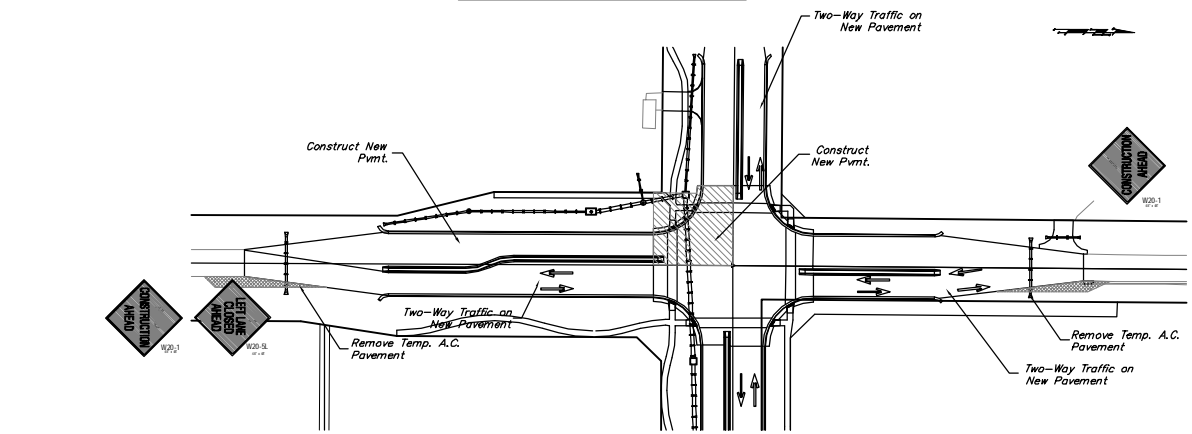

LEGEND	
	Work Area
	Temp. A.C. Pavement
	ReflectORIZED Drum (40' Spacing)
	Tubular Marker (60' Spacing)
	Type III Barricade
	Traffic Flow Pattern

PHASE V

Continue bridge construction. Construct new pavement at the southwest quarter of the 37th St and Tyler Rd intersection. Continue installation of the traffic signalization at the 37th St and Ridge Rd intersection. 2-way east-west traffic on 37th St from the west Project limits to just east of Tyler Rd to be carried on the new pavement on the north side of 37th St and on full width new pavement from just east of Tyler Rd to the west side of the creek. 37th St from east of the creek to Ridge Road shall remain closed to traffic. 2-way north-south traffic on Tyler Rd is to be carried on new pavement on the east side of Tyler Rd. East-west through traffic on 37th St is to be detoured south to 29th St.