

37th STREET NORTH

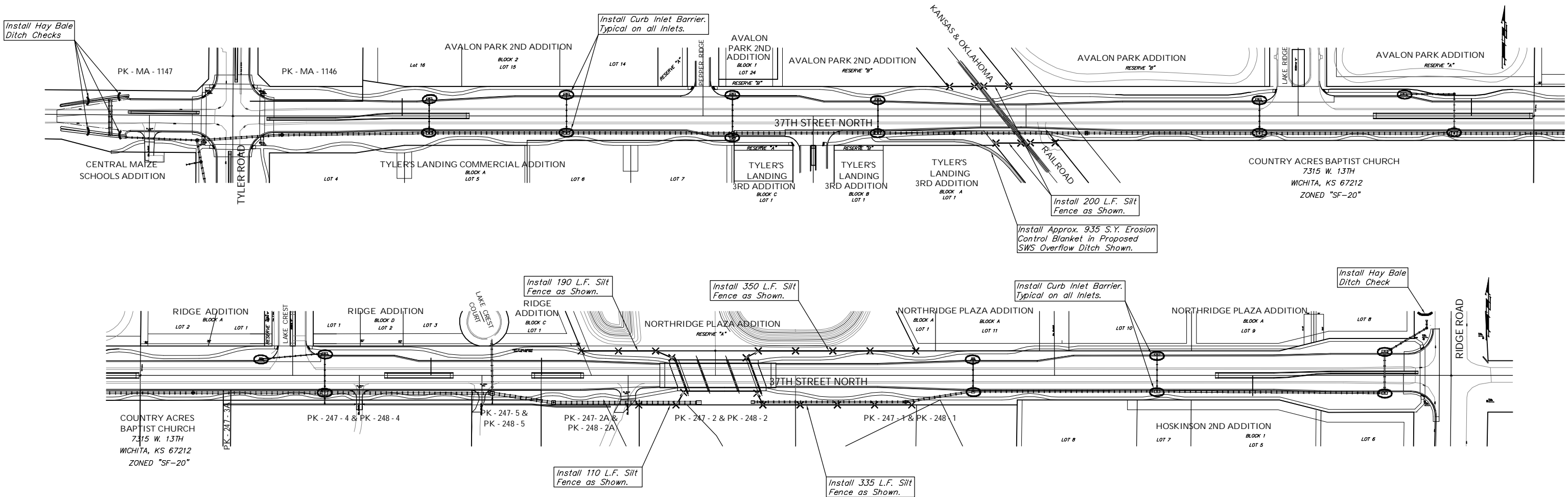

TYLER ROAD

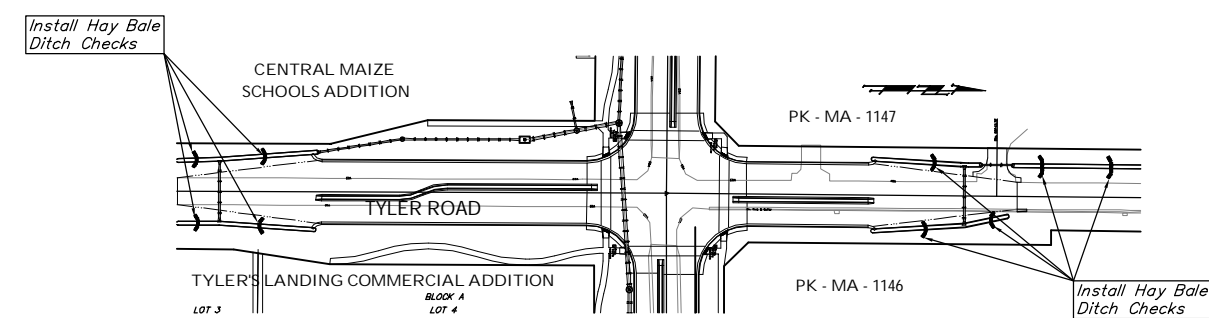

EROSION CONTROL MEASURE	UNITS	QUANTITY
SILT FENCE	L.F.	1185
RIPRAP	S.Y.	**
DROP INLET BARRIER	EA.	0
CURB INLET BARRIER	EA.	21
STRAW BALE DITCH CHECK	EA.	14
EARTHEN DIKES	L.F.	0
EROSION CONTROL BLANKET	S.Y.	10,500
POND E.C. BLANKET	S.Y.	0
Construction Entrance	EA.	2

QUANTITIES ARE FOR INFORMATION ONLY!
CONTRACTOR SHALL VERIFY QUANTITIES PER SPECIFIC ENGINEERING PLAN SHEET.

EROSION CONTROL PLAN LEGEND	
<i>(Installation Details Found in the BMP Details Sheets)</i>	
	— LIGHT STONE RIP-RAP
	— DROP INLET PROTECTION
	— CURB INLET PROTECTION
	— STRAW BALE BARRIERS
	— SILT FENCING
	— EARTH DIKES

NO SCALE

**QUANTITIES OF RIP RAP AT END SECTIONS ARE CALLED OUT ON THE PAVING AND SWS PLANS.

Drawing File: F:\37th Pave\Erosion\Erosion Control Plan.dwg (ECP)

Design: TPV
Drawn: TPV
Approved: TPV

Project No. 0401-E791 CAPITAL IMPROVEMENT PROJECT

EROSION CONTROL PLAN

37TH STREET NORTH - TYLER ROAD TO RIDGE ROAD

Scale: 1" = 100'

Baughman Company, P.A.
315 Ella St. Wichita, KS 67211 P 316-262-7271 F 316-262-0149
ENGINEERING | SURVEYING | PLANNING | LANDSCAPE ARCHITECTURE