

DSNR: MJW OPER: DRP SCALE: 1"=10'
 I:/2006/06237/SIGNAL/06237-000-SIGNALROADWAY.DGN LAST REV: 2-26-2007 BY: DRP

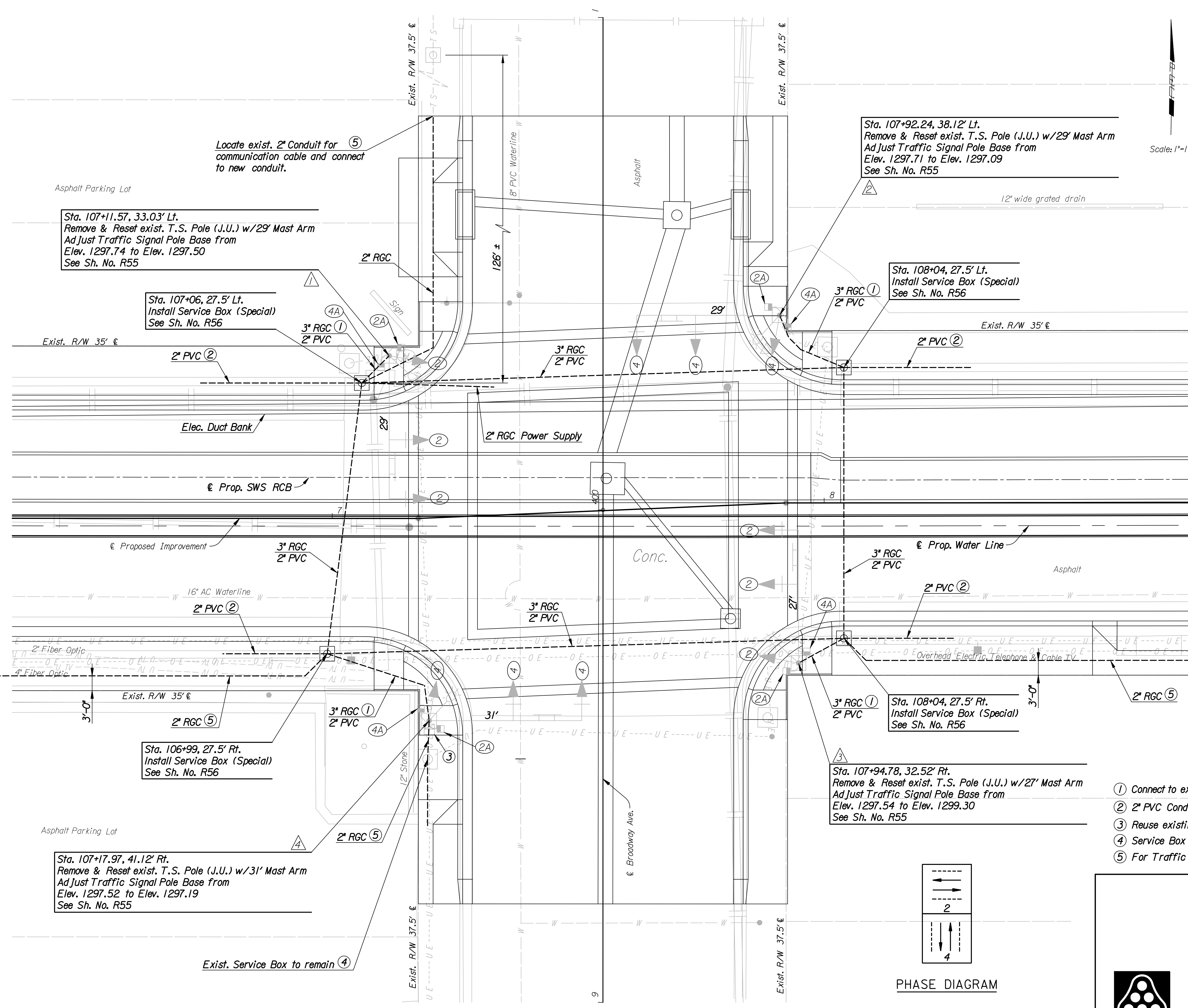

LEGEND

- ☐ Traffic Signal Pole with Mast Arm
- Traffic Signal Pedestal
- ☀ Luminaire with Arm
- ← Traffic Signal Head
- ← Traffic Signal Head with Backplate
- ⚡ Pedestrian Signal Head
- ☒ Controller (Pole Mounted)
- ☐ Service Box (Pre-Fab)
- Conduit
- ② Signal Phase
- △ Signal Pole Reference Number
- ⊥ Street Name Sign
- ⊙ Meter and Enclosure

Scale: 1"=10'

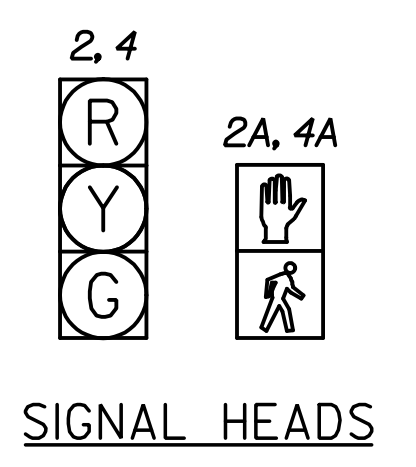

SIGNAL HEADS

- ① Connect to existing conduit in Pole Base or install as required.
- ② 2" PVC Conduit w/pull wire for street light circuit. See Lighting Plans.
- ③ Reuse existing Controller and Cabinet.
- ④ Service Box to remain. Splice to Communication Cable to the South.
- ⑤ For Traffic Signal Interconnect.

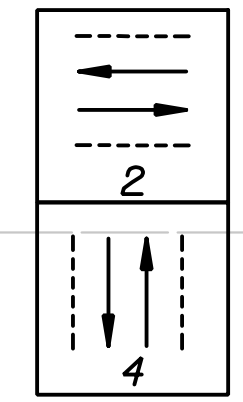

PHASE DIAGRAM

Revision		By	Date
WATERMAN STREET			
TRAFFIC SIGNAL PLAN			
WATERMAN AND BROADWAY			
JAMES L. ARMOUR, P.E.—CITY ENGINEER CITY OF WICHITA PROJECT NO. 468-84167			
Professional Engineering Consultants, P.A.			
303 S. TOPEKA • WICHITA, KANSAS 67202 316-262-2691 • FAX 316-262-3003			
Designed by	WDH	Job No.	06237
Drawn by	DRP	Date	Feb., 2007
			Sht. R46 of R111

