

BENCHMARK:
 BM #5 - 80d Spike in the South Face of the 11th Power Pole East (3/8 mile) of Maize Road on the North Side of 29th Street North.
 Sta. 1+639.15, 14.28m Lt.
 Elev. 410.880 SI Units (1348.03 MSL)

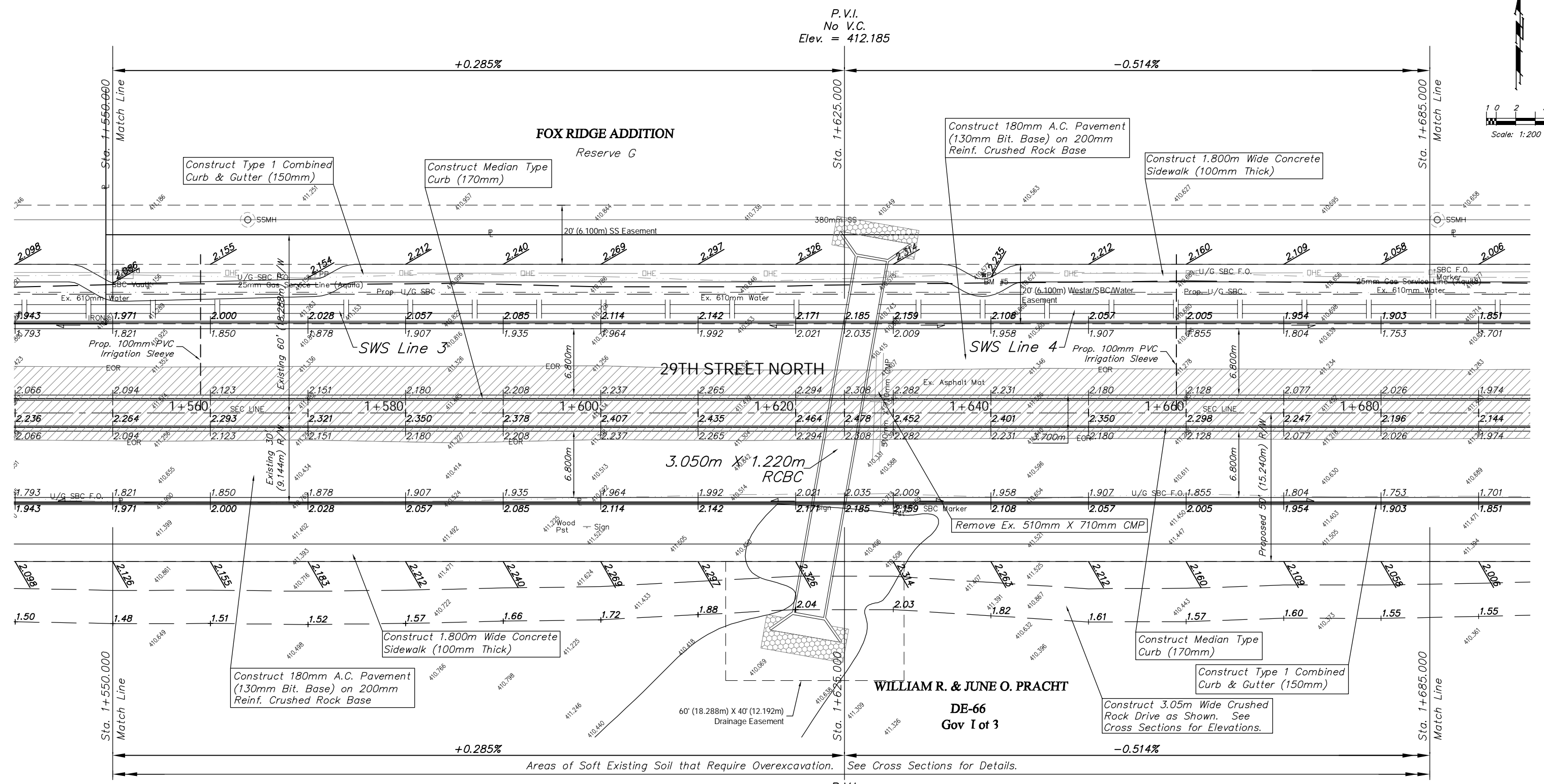

Note:
 Pavement, Sidewalks, and Etc. To Be Removed Are Indicated By:

PROJECT NUMBER 472-83863		SHEET NAME Pav05		ENGINEERING DIRECTORY F:\29th North\Earth\dwg	
DESIGN TPV	DRAWN TPV	APPROVED JFB	DATE Oct. 2004	SCALE Noted	BAUGHMAN NO 02-02-E232

CAPITAL IMPROVEMENT PROJECT
29TH STREET NORTH PAVING
 Sta. 1+550.000 to Sta. 1+685.000

BAUGHMAN COMPANY, P.A.
 ENGINEERING, SURVEYING, & PLANNING
 316-262-7271 • 315 ELLIS • WICHITA, KANSAS 67211

