

BENCHMARK:
 BM #7 - Small RR Spike in the South Face of the 1st Power Pole East of Keith on the North Side of 29th Street North.
 Sta. 2+063.40, 14.84m Lt.
 Elev. 411.437 SI Units (1349.86 MSL)

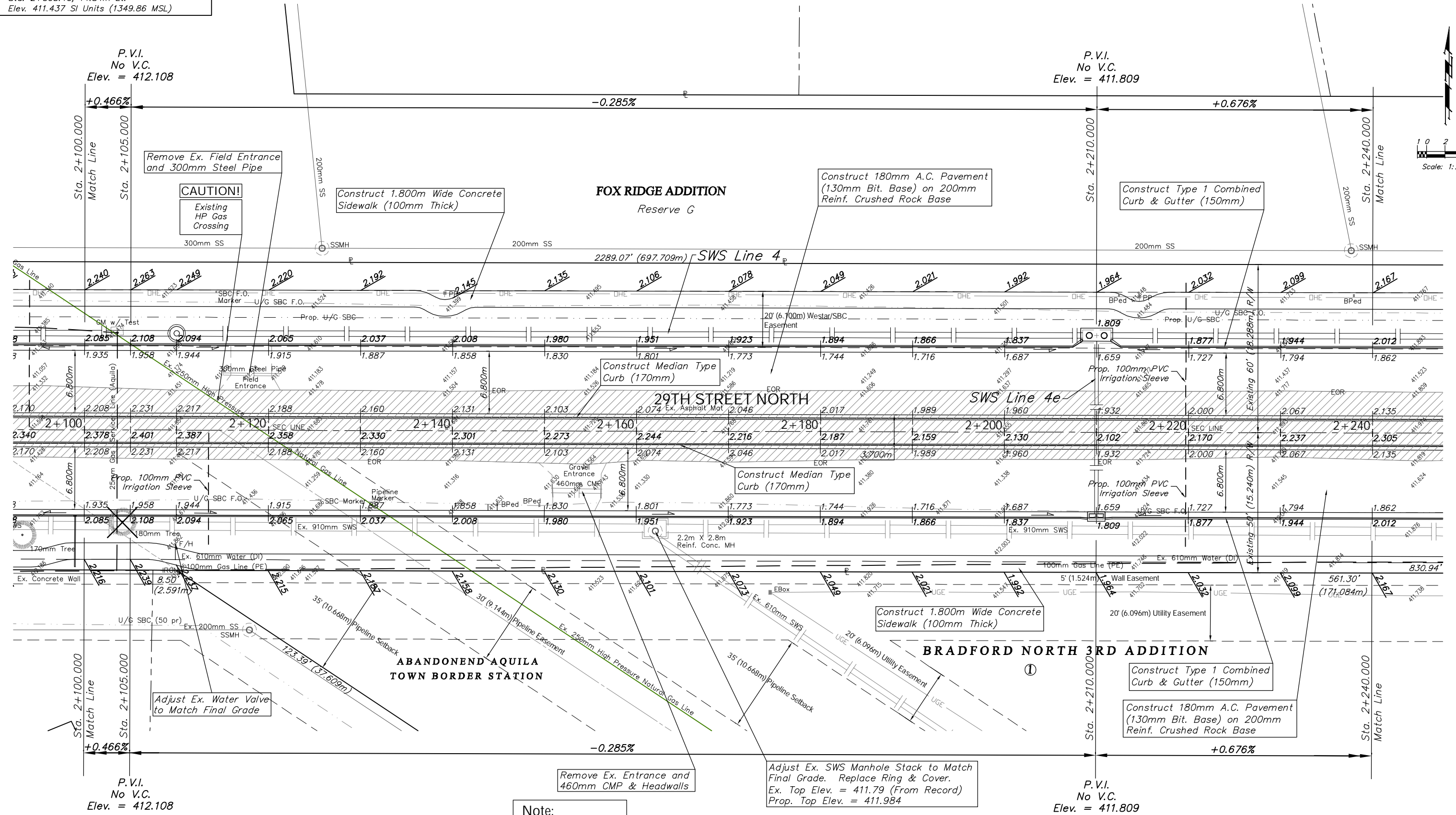
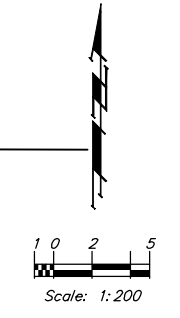

Remove Ex. Field Entrance and 300mm Steel Pipe

CAUTION!
 Existing HP Gas Crossing

Construct 1.800m Wide Concrete Sidewalk (100mm Thick)

FOX RIDGE ADDITION
 Reserve G

Construct 180mm A.C. Pavement (130mm Bit. Base) on 200mm Reinf. Crushed Rock Base

Construct Type 1 Combined Curb & Gutter (150mm)

Construct Median Type Curb (170mm)

29TH STREET NORTH

SWS Line 4e

Construct Median Type Curb (170mm)

Construct 1.800m Wide Concrete Sidewalk (100mm Thick)

BRADFORD NORTH 3RD ADDITION

Construct Type 1 Combined Curb & Gutter (150mm)

Construct 180mm A.C. Pavement (130mm Bit. Base) on 200mm Reinf. Crushed Rock Base

Adjust Ex. Water Valve to Match Final Grade

Remove Ex. Entrance and 460mm CMP & Headwalls

Adjust Ex. SWS Manhole Stack to Match Final Grade. Replace Ring & Cover. Ex. Top Elev. = 411.79 (From Record) Prop. Top Elev. = 411.984

P.V.I. No V.C. Elev. = 411.809

Note:
 Trees/Shrubs to be removed are marked thus:

Note:
 Pavement, Sidewalks, and Etc. To Be Removed Are Indicated By:

PROJECT NUMBER 472-83863		SHEET NAME Pav09		ENGINEERING DIRECTORY F:\29th North\Earth\dwg	
DESIGN TPV	DRAWN TPV	APPROVED JFB	DATE Oct. 2004	SCALE Noted	BAUGHMAN NO 02-02-E232

CAPITAL IMPROVEMENT PROJECT
29TH STREET NORTH PAVING
 Sta. 2+100.000 to Sta. 2+240.000

BAUGHMAN COMPANY, P.A.
 ENGINEERING, SURVEYING, & PLANNING
 316-262-7271 • 315 ELLIS • WICHITA, KANSAS 67211