

BENCHMARK:
 BM #8 - Small RR Spike in the South Face of the 2nd Power Pole West of Meadow Park on the North Side of 29th Street North.
 Sta. 2+290.26, 14.61m Lt.
 Elev. 412.352 SI Units (1352.86 MSL)

BM #9 - "□" on the Top of Curb at the South End of the Curb Return at the Southeast Corner of Tyler Road and 29th Street North.
 Sta. 2+612.58, 13.78m Rt.
 Elev. 415.765 SI Units (1364.06 MSL)

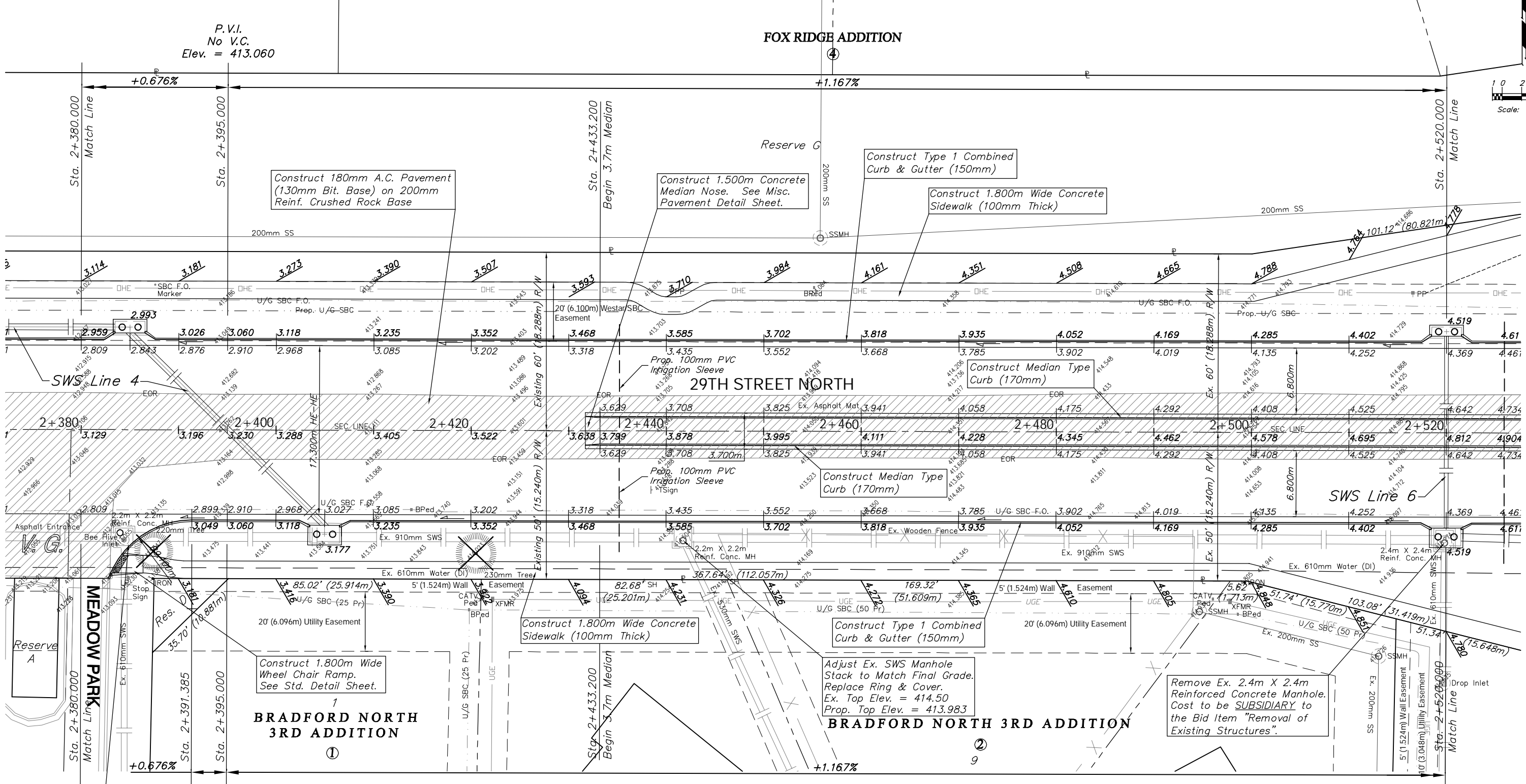
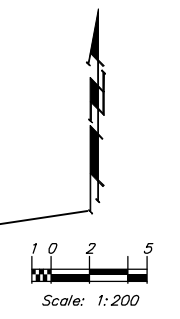

P.V.I.
No V.C.
Elev. = 413.060

Remove Ex. Beehive Grate and Top of Reinforced Concrete Manhole. Construct Reinforced Concrete Lid with Offset Manhole to Move MH from Curb. Cost to be **SUBSIDIARY** to "Adjustment of SWS Manhole". See Reinforced Concrete Manhole Detail Sheet.
 Ex. Top Elev. = 412.79
 Prop. Top Elev. = 412.900

Note:
 Trees/Shrubs to be removed are marked thus:

Note:
 Pavement, Sidewalks, and Etc. To Be Removed Are Indicated By:

PROJECT NUMBER 472-83863		SHEET NAME Pav11		ENGINEERING DIRECTORY F:\29th North\Earth\dwg	
DESIGN TPV	DRAWN TPV	APPROVED JFB	DATE Oct. 2004	SCALE Noted	BAUGHMAN NO 02-02-E232

CAPITAL IMPROVEMENT PROJECT
29TH STREET NORTH PAVING
 Sta. 2+380.000 to Sta. 2+520.000

BAUGHMAN COMPANY, P.A.
 ENGINEERING, SURVEYING, & PLANNING
 316-262-7271 • 315 ELLIS • WICHITA, KANSAS 67211

