

TRAFFIC CONTROL SIGNS & SIGN POST

Station	Location from C	Classification - Each										Sign Post Length	
		R1-1	R2-1	R4-7	OM-1	S1-1	W16-P	Breakaway 1-3/4"x1-3/4"	"U"- Channel				
Ridge Rd.:													
19+32.39	LT.			1	1								
19+62.70	RT.												
20+13.61	RT.	1											
20+37.08	RT.			1	1								
23+35.31	LT.		1										
25+42.00	LT.			1	1								
27+18.57	RT.			1	1								
28+00.48	RT.			1	1								
29+74.21	RT.	1											
Maple:													
45+23.11	LT.												
45+34.67	LT.	1											
46+28.57	LT.		1										
47+70.90	LT.			1	1								
49+14.40	LT.			1	1								
50+85.96	RT.			1	1								
51+64.40	RT.			1	1								
53+62.22	RT.												
54+06.34	RT.	1											
54+60.16	RT.				1	1							
Total		3	3	9	9	1	1						

STATE	PROJECT NO.	YEAR	SHEET NO.	TOTAL SHEETS
KANSAS	87 N-0307-01	2006	57	89

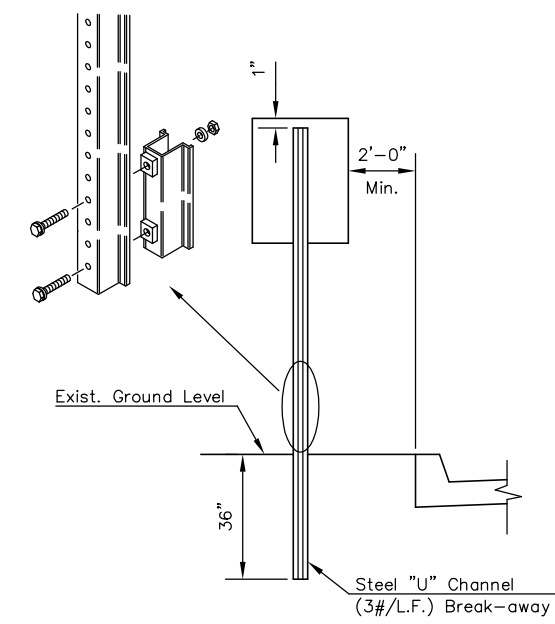
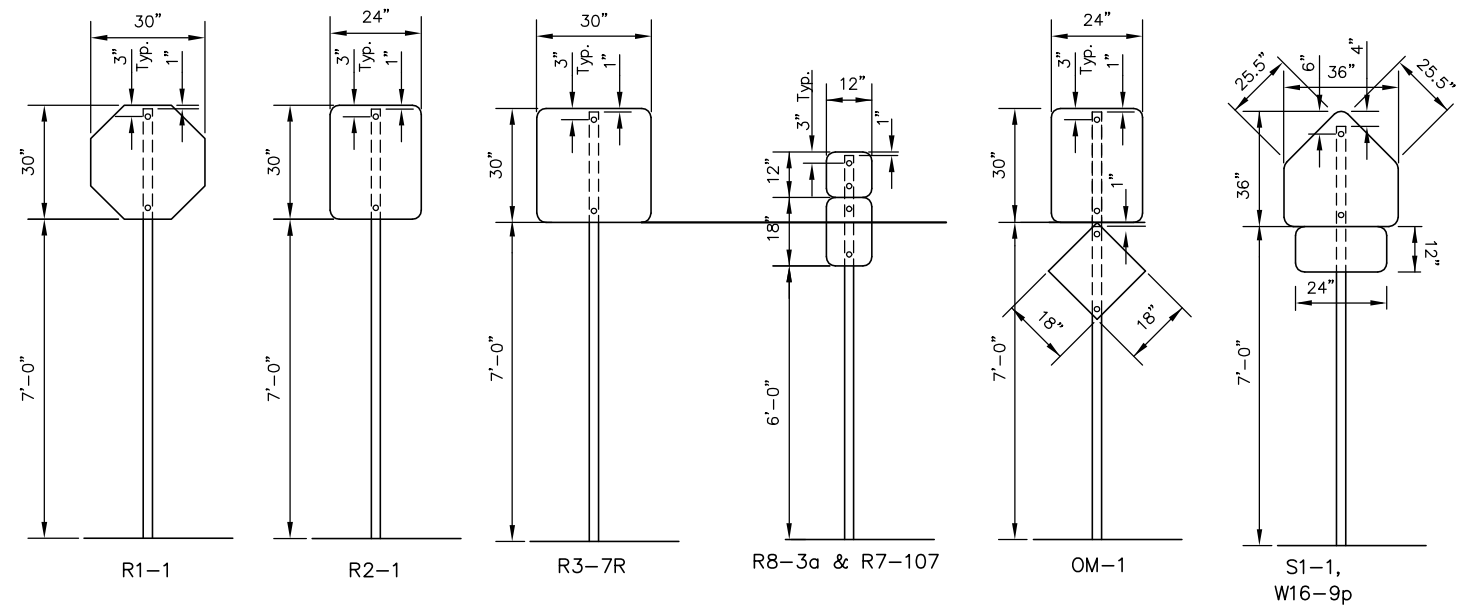

SIGN MOUNTING DETAILS

SIGN POST LENGTH SUMMARY	
BREAKAWAY SIGN POST:	
1 3/4"x1 3/4" LENGTH	EACH
6.5'	9
10.5'	6
11.0'	1
2-1/4"x2-1/4"x18"	16
2"x2"x36"	16
U-CHANNEL	
LENGTH	EACH
STUBS 3'	
POSTS 8'	
POSTS 9'	
POSTS 9-1/2'	
POSTS 11'	

RECAPITULATION OF MATERIALS		
ITEMS	TOTAL	UNIT
Sign Face, (High Intensity HA Reflective Sheeting)	104.54	S.F.
Steel "U" Channel Sign Post		L.F.
Breakaway Sign Post, 1-3/4" x 1-3/4"	132.50	L.F.
Breakaway Anchor Sleeve, 2-1/4" x 2-1/4" x 18"	24.00	L.F.
Breakaway Sign Post Anchor, 2" x 2" x 36"	48.00	L.F.

RECAPITULATION OF MATERIALS		
BID ITEMS	TOTAL	UNIT
Signing	LUMP SUM	S.F.

SIGN DESCRIPTION			
CLASSIFICATION	TYPE	SIZE	AREA
R1-1	STOP SIGN	30"x30"	5.18 SQ. FT.
R2-1	SPEED LIMIT	24"x30"	5.00 SQ. FT.
R4-7	-	24"x30"	5.00 SQ. FT.
OM-1	OBJECT MARKER TYPE I	18"x18"	2.25 SQ. FT.
S1-1	SCHOOL ZONE CROSSING AHEAD	36"x36"	6.75 SQ. FT.
W16-P	AHEAD	24"x12"	2.00 SQ. FT.

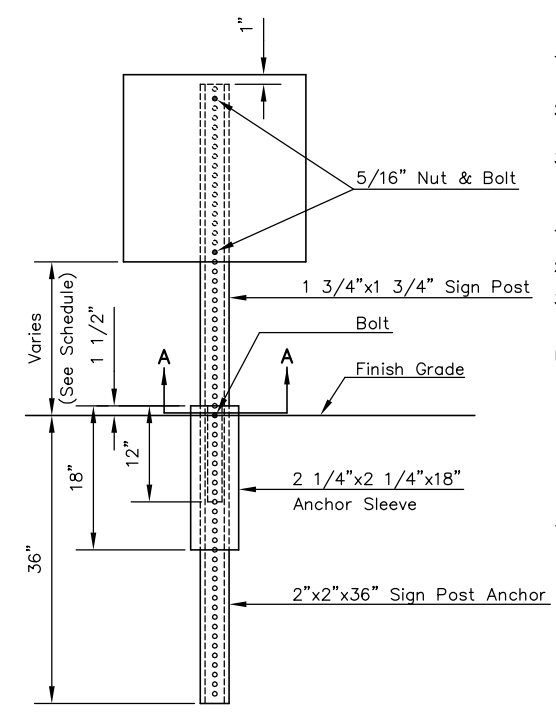

- PAVEMENT INSTALLATION SEQUENCE
- SIGN POST ANCHOR DRIVEN INTO SUBGRADE PRIOR TO THE PLACEMENT OF THE PAVEMENT.
  - ANCHOR SLEEVE DRIVEN INTO SUBGRADE OVER THE SIGN POST ANCHOR PRIOR TO THE PLACEMENT OF THE PAVEMENT.
  - INSERT SIGN POST INTO THE SIGN POST ANCHOR AND BOLT IN PLACE.

- GROUND INSTALLATION SEQUENCE
- SIGN POST ANCHOR DRIVEN INTO THE GROUND.
  - ANCHOR SLEEVE DRIVEN INTO THE GROUND OVER THE SIGN POST ANCHOR.
  - INSERT SIGN POST INTO THE SIGN POST ANCHOR AND BOLT IN PLACE.

NOTE: IN ALL INSTALLATIONS THE FIRST HOLE ABOVE THE FINISHED GRADE LEVEL IN ALL THREE UNITS MUST BE IN LINE FOR INSERTION OF THE BOLT.

ALL BOLTS AND NUTS FOR FASTENING THE SIGNS AND SIGN POST ASSEMBLY SHALL COMPLY WITH SECTION 1614 AND ALL WASHERS SHALL COMPLY WITH SECTION 1614 OF THE STANDARD SPECIFICATION FOR STATE ROAD AND BRIDGE CONSTRUCTION (1990 EDITION) AND SHALL BE SUBSIDIARY ITEM.

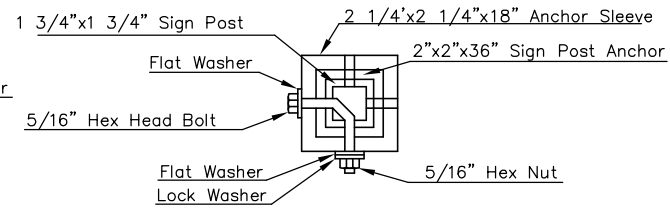

BREAK-AWAY SIGN POST DETAIL SECTION A-A

NOTE: ALL LETTER, NUMBER, & SYMBOL SIZES, SPACING, & COLORS AND THE SIGN COLORS SHALL CONFORM TO THE CURRENT "MANUAL ON UNIFORM TRAFFIC CONTROL DEVICES."  
ALL SIGN MATERIAL TO BE 0.080" ALUMINUM.

J:\Civil\03392\dwg\Details\03392sn1.dwg  
KANSAS DEPARTMENT OF TRANSPORTATION  
**SIGNING DETAILS**  
PROJECT NO. SEDGWICK CO.  
**M K E C ENGINEERING CONSULTANTS, INC.**  
WICHITA, KANSAS  
DESIGNED BY: JRA CHECKED BY:  
DRAWN BY: DPG DATE: 6/30/04 SHEET 57 OF 89