

F.H.W.A. REGION NO.	STATE	PROJECT NO.	YEAR	SHEET NO.	TOTAL SHEETS
7	KANSAS	54-87 K-8258-04	2004	25	60

STA. 3+381.417, LINE 2 =
 STA. 3+381.417, $\frac{1}{4}$ NORTH FRONTAGE RD., 2.3 m LT.
 INSTALL
 1 - CIMJ TEE, 400 mm X 300 mm (16"x12")
 1 - ANCHOR VALVE ASSEMBLY 300 mm (12") (E)
 (MJ BUTTERFLY VALVE) VALVE BOX EL. 408.857

STA. 3+482.854, LINE 2 =
 STA. 3+482.942, $\frac{1}{4}$ NORTH FRONTAGE RD., 2.300 m LT.
 INSTALL
 1 - ANCHOR VALVE ASSEMBLY SPECIAL
 300 mm (12") E
 (MJ BUTTERFLY VALVE) VALVE BOX EL. 409.458
 1 - CIMJ PLUG 300 mm (12")
 1 - BLOWOFF ASSEMBLY 50 mm (2")

STA. 3+392.160, LINE 2 =
 STA. 3+392.160, $\frac{1}{4}$ NORTH FRONTAGE RD., 2.3 m LT.
 INSTALL
 1 - FIRE HYDRANT ASSEMBLY
 L = 2.1 m
 BURY LINE EL. 408.963
 VALVE BOX EL. 408.933

PC WL STA. 3+405.878, LINE 2 =
 PC STA. 3+405.870, $\frac{1}{4}$ NORTH FRONTAGE RD., 2.300 m LT.

WATER LINE 2
 CURVE DATA
 PI STA. 3+439.367 (BK.)
 $\Delta = 02^{\circ}33'45"$ LT.
 T = 33.498 m
 L = 66.985 m
 R = 1 497.700 m

WATER LINE 2
 CURVE DATA
 PI STA. 3+477.854 (BK.)
 $\Delta = 00^{\circ}22'53"$ RT.
 T = 5.000 m
 L = 10.000 m
 R = 1 502.300 m

INSTALL WL PIPE
 300 mm (12") X 101.2 m

Scale: 1:500

DATE	BY	REFERENCE NOTED	REFERENCE CHECKED

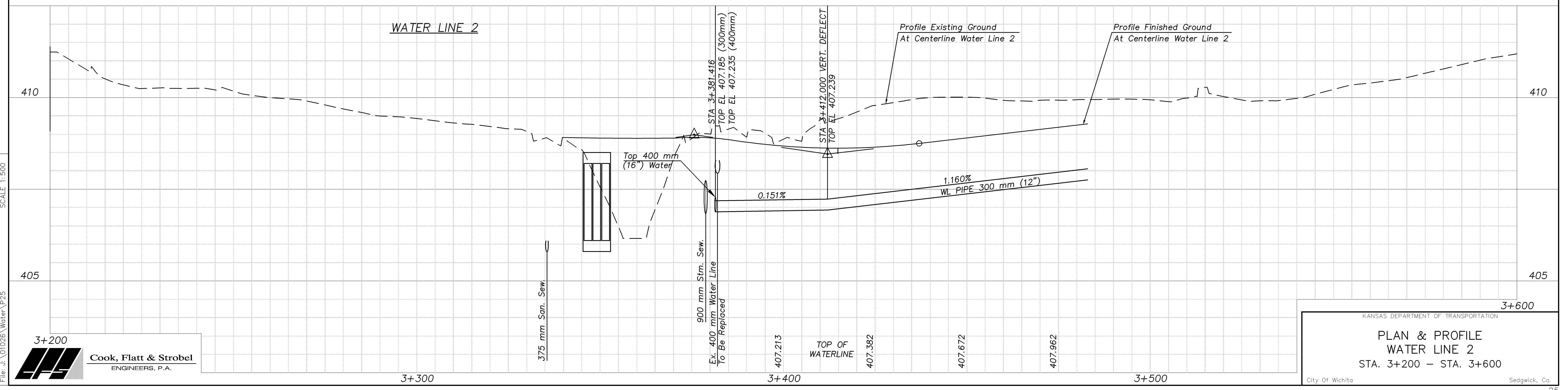
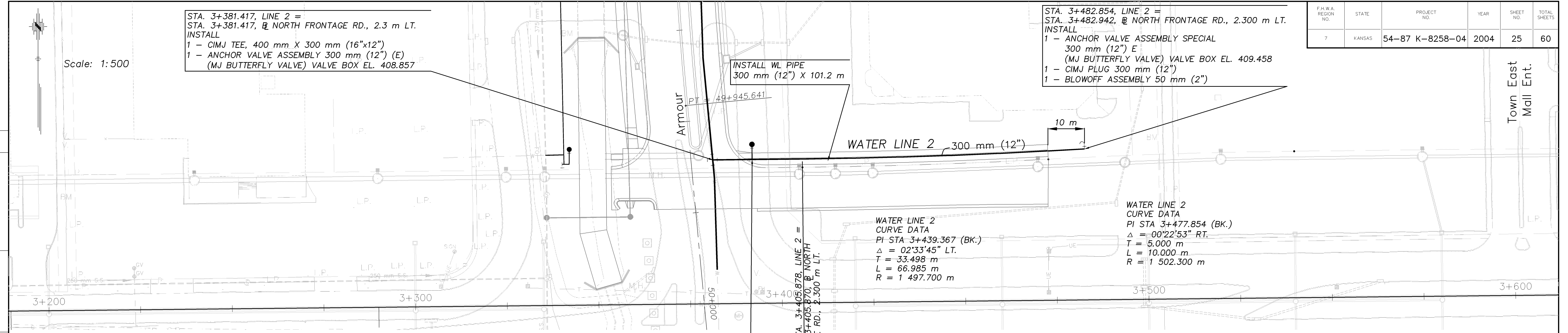

KANSAS DEPARTMENT OF TRANSPORTATION

PLAN & PROFILE
WATER LINE 2
 STA. 3+200 - STA. 3+600

City Of Wichita Sedgwick, Co.

Drawn by: [] Plotted: []
 File: J:\01026\Water\PP25 SCALE 1:500

