

F.H.W.A. REGION NO.	STATE	PROJECT NO.	YEAR	SHEET NO.	TOTAL SHEETS
7	KANSAS	54-87 K-8258-04	2004	27	60

STA. 49+731.949 = 33.472 m RT.
 STA. 49+731.949 @ ARMOUR RD.
 INSTALL-
 1- CIMJ TEE 200 mm x 200 mm (8" x 8"). CONNECT TO EXISTING WATER LINE PIPE 200 mm (8")(E-W)
 1- ANCHORED VALVE ASSEMBLY 200 mm (8")(S) MJ GATE VALVE VALVE BOX ELEV. 409.100±

Scale: 1:500

STA. STA. 49+958.724 = 39.347 m RT.
 STA. 49+955.553 @ ARMOUR RD.
 INSTALL-
 1- CIMJ TEE 200 mm x 100 mm (8" x 4").
 1- ANCHORED VALVE ASSEMBLY 100 mm (4")(W)
 VALVE BOX ELEV. 409.100±
 INSTALL WATERLINE PIPE 100 mm (4") x 5.0 m
 CONNECT TO EXISTING WATERLINE PIPE 100 mm (4")(W)

STA. STA. STA. 49+961.287 = 34.544 m RT.
 STA. 49+958.469 @ ARMOUR RD.
 INSTALL-
 1- CIMJ TEE 200 mm x 200 mm (8" x 8")
 1- ANCHORED VALVE ASSEMBLY 200 mm (8")(W) (MJ GATE VALVE) VALVE BOX ELEV. 409.100±
 1- CIMJ PLUG 200 mm (8")(W)
 1- CIMJ 90° BEND 200 mm (8")(E)
 1- FIRE HYDRANT ASSEMBLY L=1.30 m
 BURY LINE ELEV. 409.100±
 VALVE BOX ELEV. 409.100±

STA. 49+895.472 = 35.673 m RT.
 STA. 49+895.169 @ ARMOUR RD.
 INSTALL 22 1/2" BEND

STA. 49+907.180 = 31.482 m RT.
 STA. 49+905.746 @ ARMOUR RD.
 INSTALL 22 1/2" BEND

INSTALL WATER LINE PIPE 200 mm (8") x 232.77 m

BY	DATE

REFERENCE NOTED	REFERENCE CHECKED

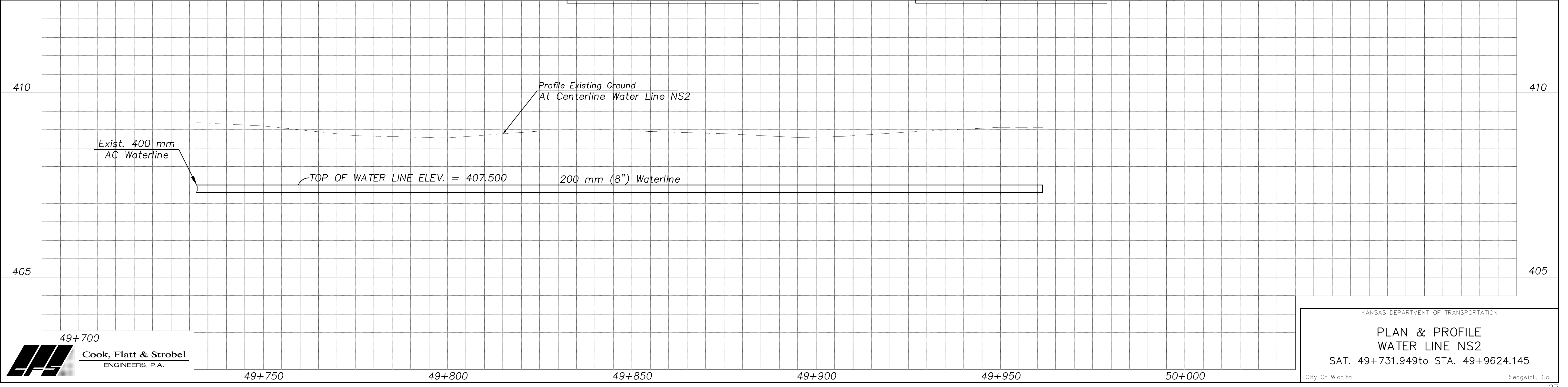
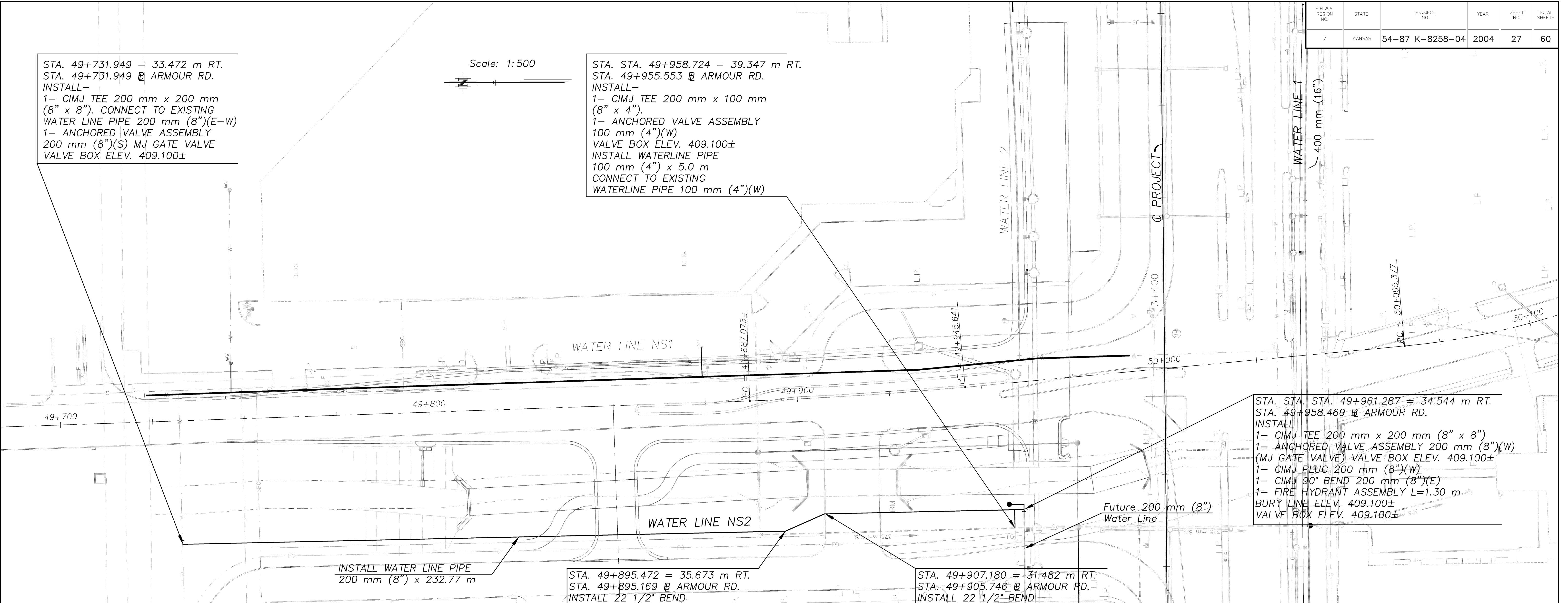

Drawn by: [Name] Plotted: [Date]
 File: J:\01026\Water\PS4
 SCALE 1:500
Cook, Flatt & Strobel
 ENGINEERS, P.A.

KANSAS DEPARTMENT OF TRANSPORTATION
PLAN & PROFILE
WATER LINE NS2
 SAT. 49+731.949to STA. 49+9624.145
 City Of Wichita Sedgwick, Co.