

STATE	PROJECT NO.	YEAR	SHEET NO.	TOTAL SHEETS
KANSAS	87N-0306-01	2005	46	111

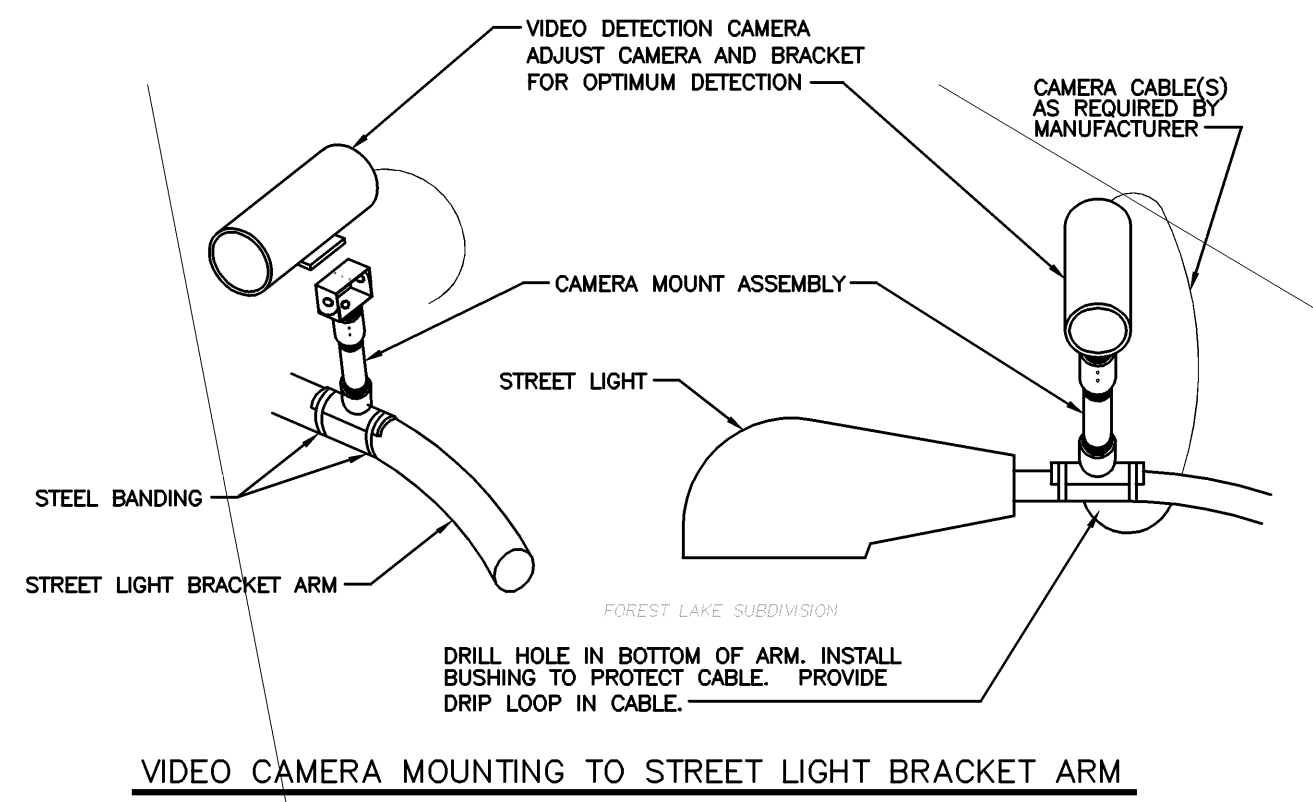

NOTES:

- The locations of existing underground utilities are shown in an approximate way only and have not been independently verified. The contractor shall be responsible for contacting all utility companies for locations of all underground lines prior to excavation and be fully responsible for any and all damages, which might be occasioned by the Contractor's failure to exactly locate and preserve any and all underground utilities. See the title sheet for telephone numbers for utility companies.
- Detection zones shall be centered in their respective lanes.
- All signal poles, cameras, detection zones, junction boxes, controllers and service boxes shall be field located by the contractor and verified by the Engineer prior to installation.
- Any conduit to be installed under existing paved areas shall be bored.
- Factory Conduit bends shall be installed into the service boxes, junction boxes and/or pole bases from conduit runs. Conduit entering service boxes, junction boxes and/or pole bases shall be continuous into the service box, junction box or pole base.
- All work and equipment shall conform to the latest edition of the City of Wichita's Standard Specifications and standard details for traffic signals.
- All areas disturbed by construction shall be sodded as directed by the construction representative.
- Forms (including rebar cages, etc.), conduit and anchor bolts shall be installed and in place for review by the Engineer.
- For stop bar locations, refer to the pavement marking plans.
- All conduit for the traffic signals shall be rigid steel.
- All pedestrian signals shall be GELcore PS6-CFL1-01A or approved equal.
- The following video detection systems are approved for use on the City of Wichita projects:
  - Vantage Edge Video Detection System
  - Variable Focal Length Video Detection Camera
  - Vantage Viewer Communication Module
  - Extension Modules
  - Processor Modules

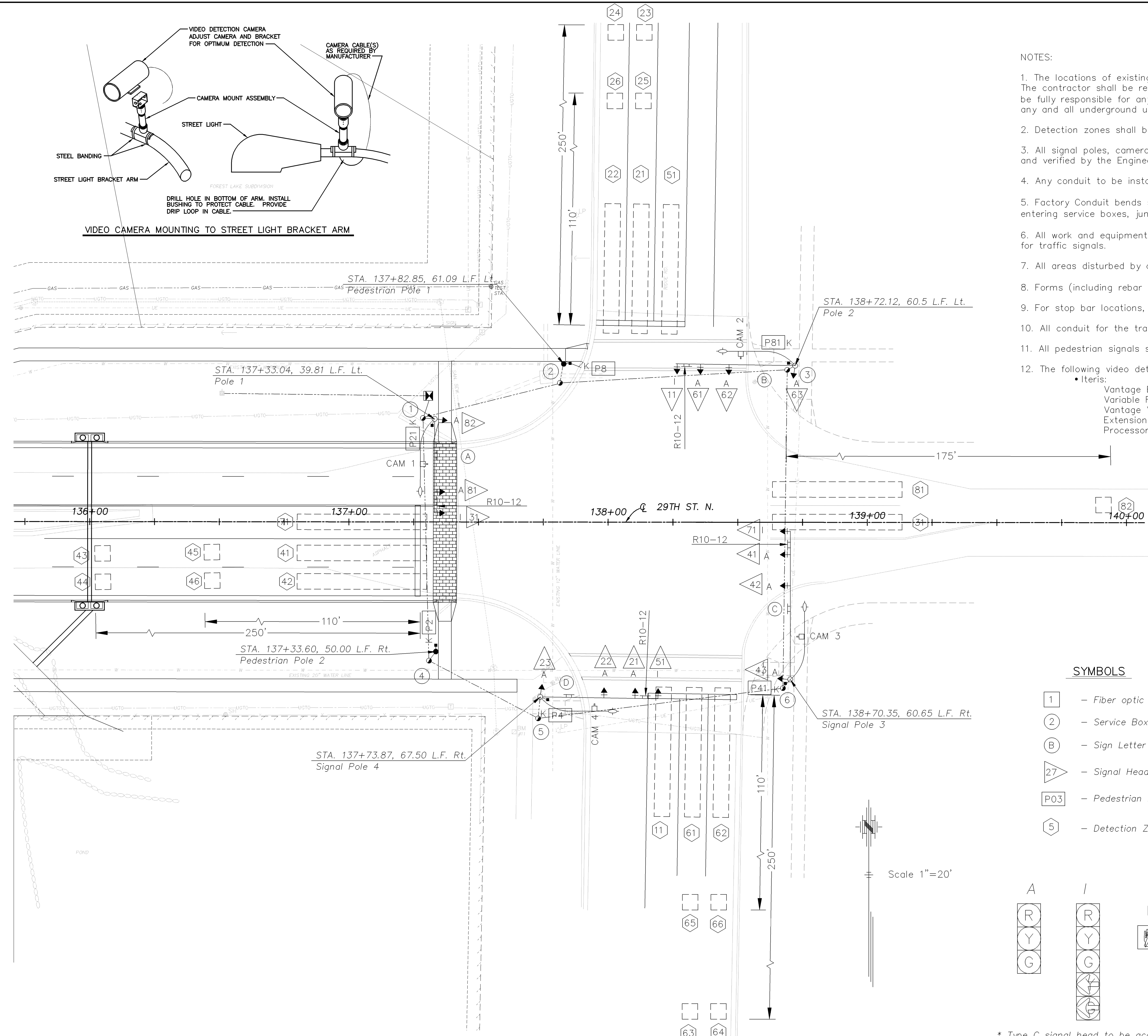

SYMBOLS

- 1 - Fiber optic Service Box Number
- 2 - Service Box Number
- B - Sign Letter
- 27 - Signal Head Number
- P03 - Pedestrian Head Number
- 5 - Detection Zone

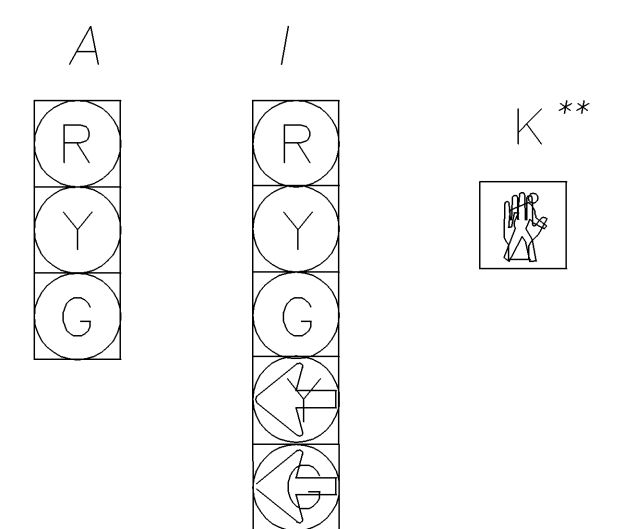

LEGEND

- Mast Arm Mounted Traffic Signal w/Backplate
- Vertical Bracket Mounted Traffic Signal
- Luminaire
- Traffic Signal Pole
- Traffic Signal Pedestal
- Traffic Signal Head w/Type Designation
- Pedestrian Head
- Controller
- Junction Box
- Service Box
- Vehicle Detector
- 75 mm Conduit
- 50 mm Conduit
- Video Camera
- Sign Mounted to Mast Arm
- Video Detection Zone

Scale 1"=20'

\* Type C signal head to be accompanied with an R10-12 sign "LEFT TURN YIELD ON GREEN"  
 \*\* Hand and person overlaid and filled.  
 Note: All signal head sections are to be 12 inch.

KANSAS DEPARTMENT OF TRANSPORTATION

29TH ST. NORTH & RIDGE ROAD  
TRAFFIC SIGNAL LAYOUT

**CFS**  
Cook, Flatt & Strobel  
ENGINEERS, P.A.

DESIGNED	SCALE
DETAILED	DATE
QUANTITIES	SHEET OF