

 PHASE I
 TRAFFIC FLOW

TRAFFIC CONTROL PHASE I
 1. Close Westbound Traffic. Carry Eastbound Traffic on North Half of Existing Roadway.
 2. Place Concrete Safety Barrier in Locations Around Proposed RCB Construction as Shown on Plans.
 3. Construct Storm Sewer System and RCB's.
 4. Construct Proposed Eastbound Through Lanes.
 5. Construct Entrances and Sidestreets on South.

NOTE:
 See Sheets 58, 59 and 60 for Additional Information on Construction Signing, Temporary Pavement Marking, Channelization Devices and Spacing for Signs and Pavement Markings.

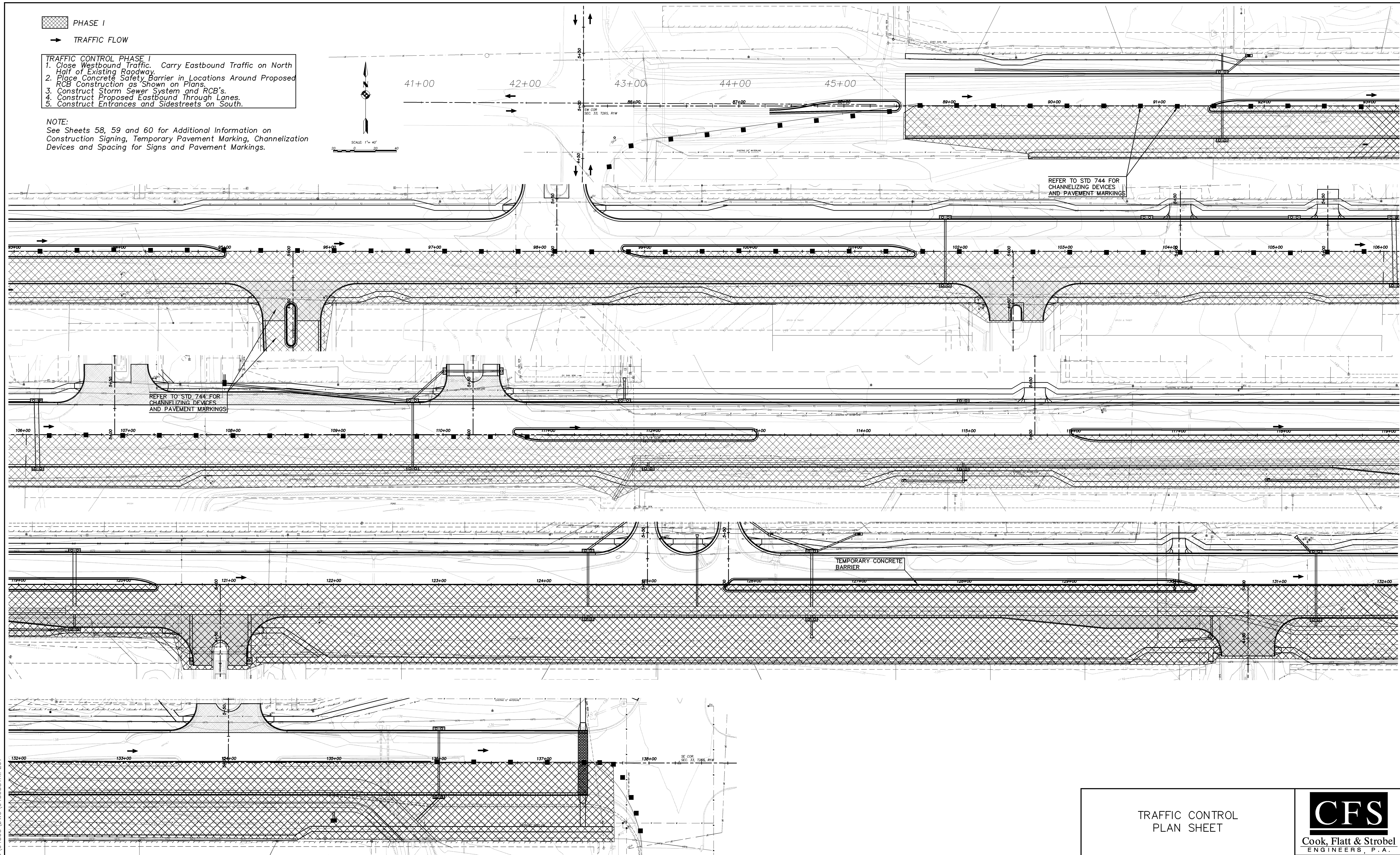
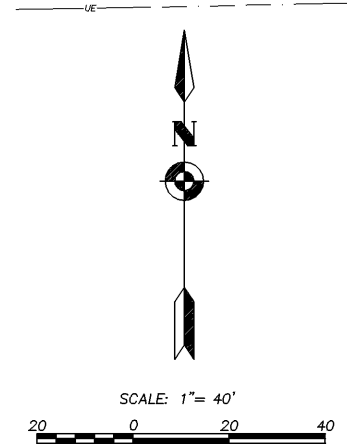

REFER TO STD 744 FOR CHANNELIZING DEVICES AND PAVEMENT MARKINGS

REFER TO STD 744 FOR CHANNELIZING DEVICES AND PAVEMENT MARKINGS

TEMPORARY CONCRETE BARRIER

TRAFFIC CONTROL
PLAN SHEET

29TH STREET NORTH

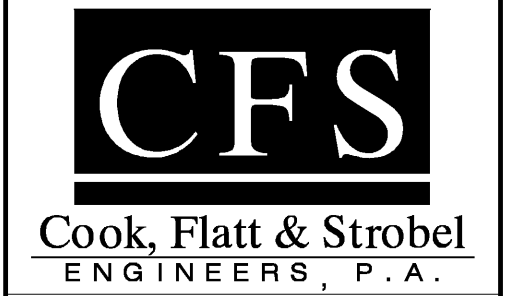

DESIGNED KKH SCALE
 DETAILED KKH DATE 3-2005
 QUANTITIES KKH SHEET 57 OF 111

CITY OF WICHITA

2004PROJ_04565_DWG_04565STRPE01