

0:35:46\DWGS\Office Check Plans\01-x41-03546-XSEC.dwg 1=5

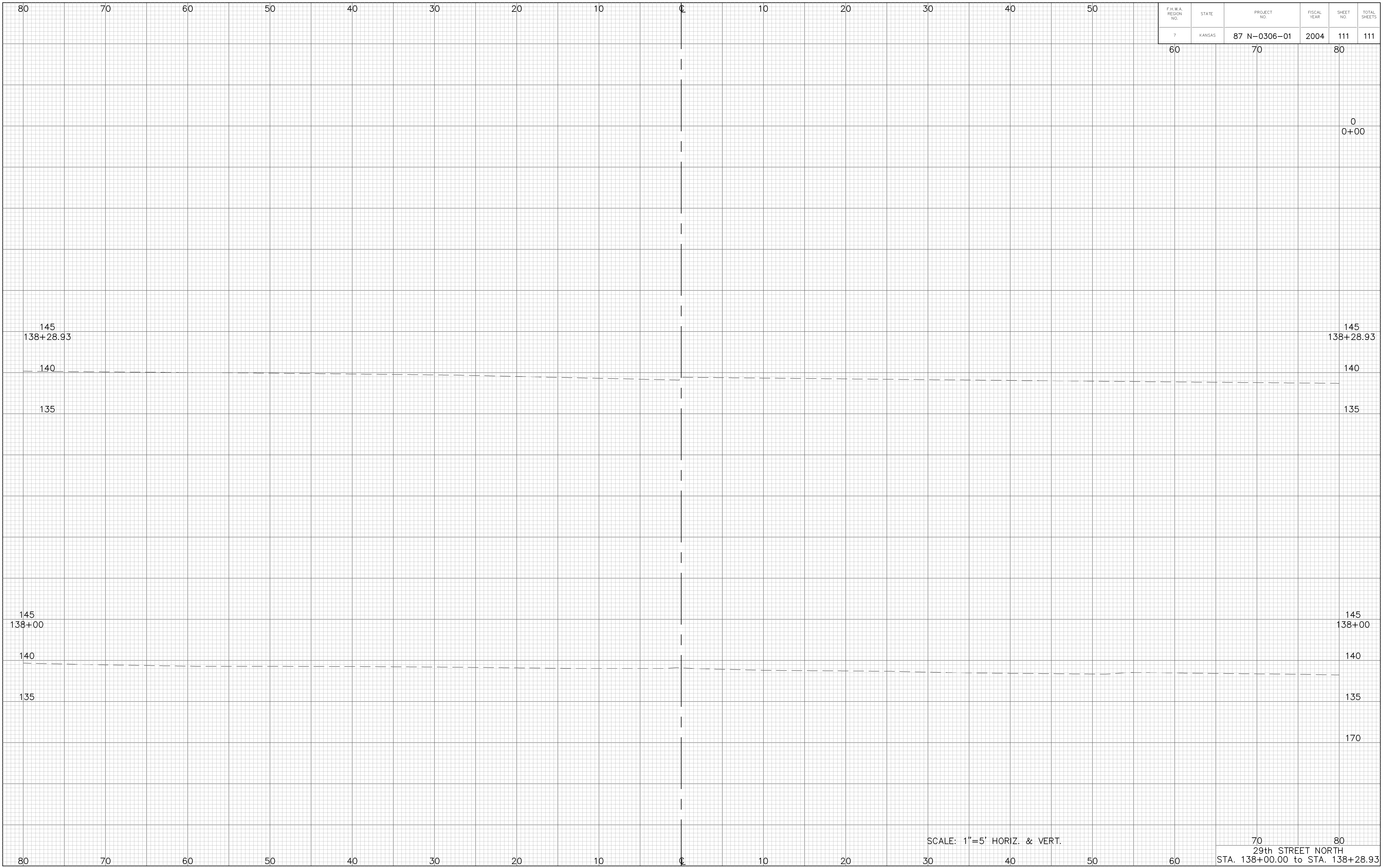

| F.H.W.A. REGION NO. | STATE | PROJECT NO. | FISCAL YEAR | SHEET NO. | TOTAL SHEETS |
|---------------------|--------|--------------|-------------|-----------|--------------|
| 7 | KANSAS | 87 N-0306-01 | 2004 | 111 | 111 |

SCALE: 1"=5' HORIZ. & VERT.

70 80
29th STREET NORTH
STA. 138+00.00 to STA. 138+28.93