

STATE OF KANSAS
DEPARTMENT OF TRANSPORTATION

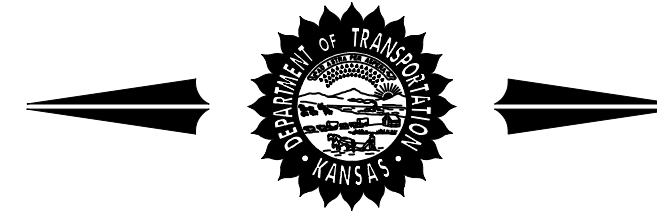

PLAN AND PROFILE OF PROPOSED

GREENWICH ROAD FROM 27TH ST. NORTH TO 1/2 MILE NORTH OF 29TH ST. NORTH

KDOT PROJECT NO. 87 N-0383-01

PART A: CITY OF WICHITA PROJECT NO. 472-84415 O.C.A. NO. 706955

FEDERAL AID PROJECT STP-N 038(301)

PART B: CITY OF WICHITA PROJECT NO. 448-90202 O.C.A. NO. 635679
(NON-PARTICIPATING)

SEDGWICK COUNTY

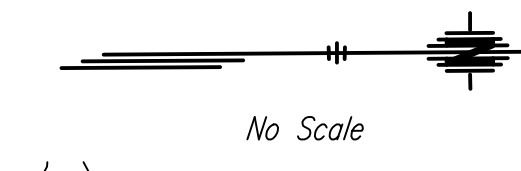
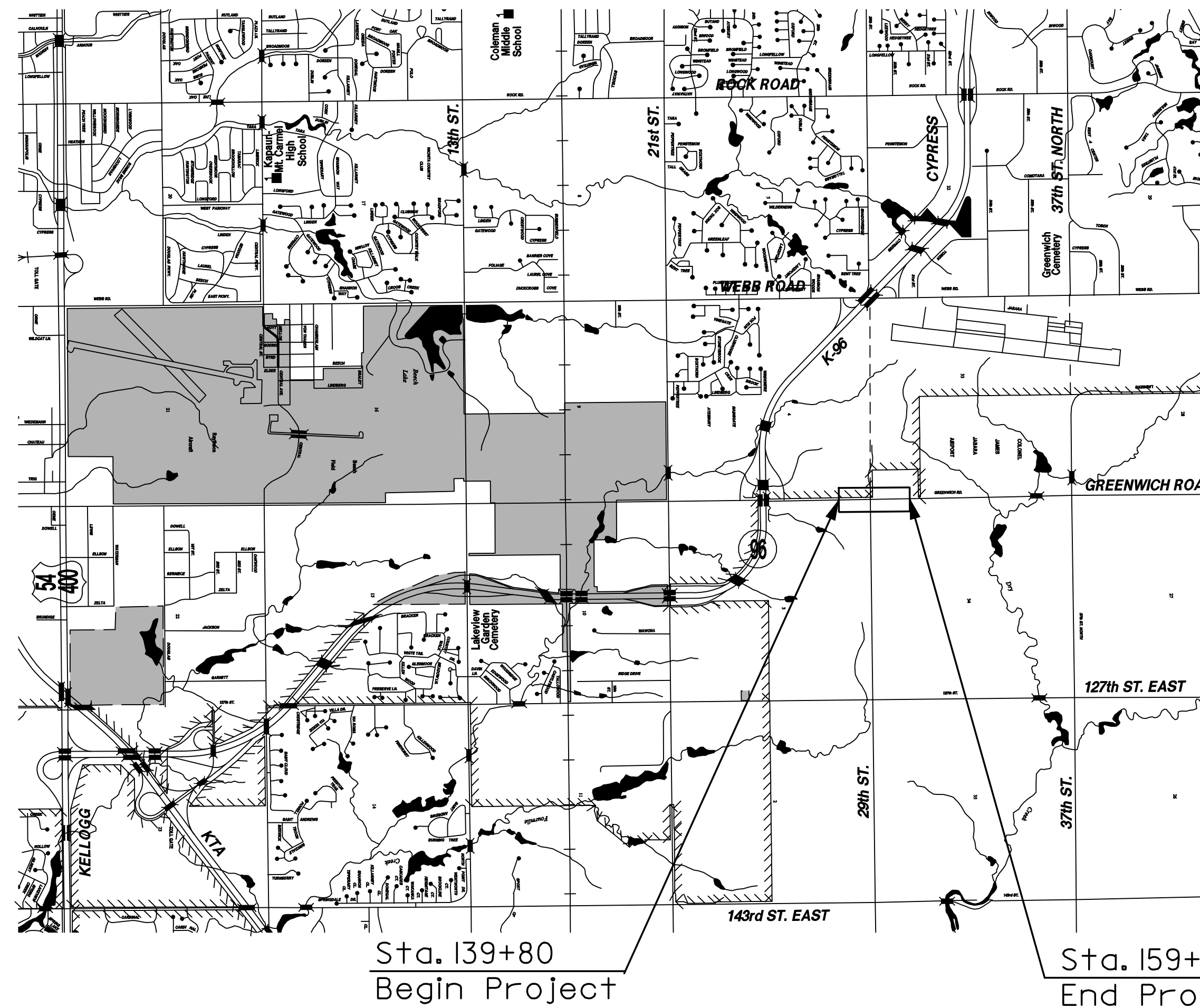

INDEX OF SHEETS

- PART A:
1. Title Sheet
 - 2.-3. Typical Sections
 - 4.-7. Greenwich Road Plans
 - 8.-9. 29th Street Plans
 - 10.-11. Coordinate Geometry Plans
 12. Curve Stake Out Tables
 - 13.-20. Storm Sewer Plan and Profiles
 - 21.-22. Intersection Details
 23. Concrete Pavement
 24. Contraction Joint Dowel Assemblies
 25. Curb, Gutter and Combined Curb and Gutter
 - 26.-27. Valley Gutter / Entrance Details
 28. Wheelchair Ramp Details
 29. Sidewalk and Steps
 30. Std. Type 1 Curb Inlet (L=10')
 31. Std. Type 1 Curb Inlet (L=15')
 32. Underdrain Details
 33. Reinforced Concrete Manhole
 34. Manhole Adjustment Detail
 35. Concrete End Sections (RCP)
 - 36.-37. Summary and Recapitulation of Quantities
 - 38.-41. Erosion Control - BMP's
 42. SWPPP Plan
 - 43.-49. Landscape Plans
 50. Traffic Signal Service Box Details
 - 51.-54. Signing and Marking Plans
 55. Traffic Handling and Construction Sequence
 - 56.-65. Traffic Control Plans
 66. Drainage Map
 - 67.-78. Cross-Sections (Greenwich Road)
 - 79.-81. Cross-Sections (29th Street)

PART B: (NON-PARTICIPATING)

- B1.-B5. Water Main

DESIGN DESIGNATION

AADT (2005)	6,600
AADT (2030)	20,000
DHV (10%)	2,000
D	60%
T	3%
V	40 MPH
C of A	Existing
Clear Zone	6'

CONVENTIONAL SIGNS

COUNTY LINE	-----	CENTER LINE OF PROJECT	----- 50
CITY LIMITS	=====	TERRACE	-----
STATE OR NATIONAL LINE	-----	CULVERTS	-----
TOWNSHIP, SECTION or GRANT LINE	-----	DROP INLET & STORM SEWER	-----
PROPERTY LINE	-----	ACCESS CONTROL	-----
HIGHWAY FENCE	-----	POWER POLE	-----
EXISTING FENCE	-----	TELEPHONE POLE	-----
GUARD FENCE	-----	MARSH	-----
CONSTRUCTION LIMITS	-----	HEDGE	-----
RIGHT OF WAY LINE	-----	TREES	-----
TRAVELED WAY	-----	PROFILE ELEVATION	-----
RAILROADS	-----	STREAM or CREEK	-----

GROSS LENGTH OF PROJECT	1990 FT.	
EXCEPTIONS	0	
ADDITIONS	0	
NET LENGTH OF PROJECT	1990 FT.	0.377 MILES
NET LENGTH OF BRIDGES	0 FT.	0 MILES
NET LENGTH OF ROAD	1990 FT.	0.377 MILES

STATE	PROJECT NO.	YEAR	SHEET NO.	TOTAL SHEETS
KANSAS	87 N-0383-01	2006	1	81
FEDERAL AID PROJ. NO. STP-N 038(301)				

GRADING & SURFACING
SEEDING & SODDING
PAVEMENT MARKING

GENERAL NOTES

ALL CONSTRUCTION WORK AND MATERIAL IN THIS PROJECT SHALL COMPLY WITH CITY OF WICHITA STANDARD SPECIFICATIONS FOR THE CONSTRUCTION OF CITY PROJECTS UNLESS OTHERWISE NOTED IN THE PLANS OR SPECIAL PROVISIONS.

UNDERGROUND UTILITY SERVICE LINES AND OVERHEAD UTILITY POLE LINES ARE TO BE ADJUSTED AS NECESSARY BY OTHERS PRIOR TO CONSTRUCTION UNLESS THE PLANS SPECIFICALLY CALL FOR THEIR ADJUSTMENT BY THE CONTRACTOR. EXISTING UTILITIES AND THEIR LOCATION, AS SHOWN ON THE PLANS, REPRESENT THE BEST INFORMATION OBTAINABLE FOR DESIGN. LOCATION INFORMATION HAS BEEN OBTAINED FROM THE VARIOUS UTILITY COMPANIES AND IS EITHER FROM COMPANY RECORD DRAWINGS OR COMPANY PROVIDED FIELD LOCATIONS. THE CONTRACTOR WILL BE REQUIRED TO WORK AROUND EXISTING UTILITIES WITHIN THE RIGHT-OF-WAY WHICH DO NOT CONFLICT WITH PROPOSED CONSTRUCTION.

TREES AND SHRUBS IN PUBLIC RIGHT-OF-WAY WHICH ARE IN DIRECT CONFLICT WITH PROPOSED NEW CONSTRUCTION SHALL BE REMOVED BY THE CONTRACTOR WITH THE ENGINEER'S APPROVAL. TREES AND SHRUBS WHICH ARE NOT IN DIRECT CONFLICT WITH PROPOSED NEW CONSTRUCTION SHALL BE SAVED AND PROTECTED FROM DAMAGE.

RUBBLE FROM THE REMOVAL OF MISCELLANEOUS STRUCTURES SHALL BE DISPOSED OF ON SITES TO BE PROVIDED BY THE CONTRACTOR AND APPROVED AS NOTED BELOW.

ALL DISPOSAL SITES MUST BE APPROVED BY THE KANSAS DEPARTMENT OF HEALTH AND ENVIRONMENT. MATERIAL EITHER STOCKPILED OR DISPOSED OF IN A FLOOD PLAIN WOULD REQUIRE A KANSAS STATE BOARD OF AGRICULTURE PERMIT. ANY MATERIAL DUMPED IN WATERS OF THE UNITED STATES OR WETLANDS IS SUBJECT TO U.S. CORPS OF ENGINEERS PERMITTING REGULATIONS. ANY MATERIAL BURIED OR STOCKPILED BEYOND APPROVED CONSTRUCTION LIMITS WOULD REQUIRE ADDITIONAL ARCHEOLOGICAL INVESTIGATIONS UNLESS BURIED IN A PREVIOUSLY APPROVED BORROW LOCATION.

CONTRACTOR SHALL SATISFY HIMSELF OF SURFACE AND SUBSURFACE CONDITIONS PRIOR TO BIDDING.

FIELD LOCATE ALL EXISTING UTILITIES PRIOR TO BEGINNING ANY EXCAVATION WORK. CONTACT THE KANSAS ONE-CALL SYSTEM AT 316-687-2470 AT LEAST 48 HOURS IN ADVANCE TO REQUEST FIELD LOCATES. FOR UTILITIES THAT ARE NOT MEMBERS OF THE KANSAS ONE-CALL SYSTEM, CONTACT THOSE COMPANIES DIRECTLY.

CONTRACTOR IS RESPONSIBLE FOR PRESERVING EXISTING PROPERTY IRONS. RE-ESTABLISH ANY EXISTING PROPERTY IRONS WHICH ARE DAMAGED OR DESTROYED BY CONSTRUCTION OPERATIONS, OR WHICH ARE COVERED BY 12" OR MORE OF FILL MATERIAL BY THIS PROJECT. SUCH IRONS SHALL BE RE-ESTABLISHED BY A LICENSED LAND SURVEYOR IN ACCORDANCE WITH STATE LAWS AND AT NO ADDITIONAL COST TO THE CITY.

THE WATER DEPARTMENT SHALL FIELD LOCATE WATER VALVES ONE TIME DURING CONSTRUCTION WHEN REQUESTED BY THE CONTRACTOR. IT SHALL BE THE CONTRACTOR'S RESPONSIBILITY TO PRESERVE SUCH FIELD LOCATIONS DURING THE CONSTRUCTION PROCESS. WATER VALVES, WATER VALVE BOXES OR FIRE HYDRANTS DAMAGED DURING CONSTRUCTION SHALL BE REPAIRED BY THE CONTRACTOR AT HIS OWN EXPENSE.

WATER VALVES AND MANHOLES SHALL BE ADJUSTED BY THE CONTRACTOR TO MEET FINAL GRADES, AS DIRECTED BY THE ENGINEER.

THE CONTRACTOR SHALL REMOVE EXISTING ROAD SIGNS THAT INTERFERE WITH CONSTRUCTION. SIGNS DAMAGED THRU NEGLIGENCE OF THE CONTRACTOR SHALL BE REPLACED BY THE CONTRACTOR AT NO COST TO THE CITY. THE CONTRACTOR SHALL STOCKPILE THE SIGNS ALONG THE R/W (AT A CENTRAL LOCATION) FOR REMOVAL BY CITY FORCES.

ALL EXISTING PAVEMENT AND CURB AND GUTTER WITHIN THE CONSTRUCTION LIMITS SHALL BE SAW CUT, FULL DEPTH, TO THE NEAT LINES SHOWN ON THE PLANS, OR TO THE NEAREST JOINT, AND REMOVED, UNLESS OTHERWISE NOTED. SAW CUTTING SHALL BE SUBSIDIARY TO THE BID ITEM "PAVEMENT REMOVED".

ALL LABOR, MATERIALS, AND EQUIPMENT NECESSARY TO MAKE CONNECTIONS TO EXISTING PIPE OR EXISTING SMALL STRUCTURES SHALL NOT BE PAID FOR DIRECTLY; BUT SHALL BE SUBSIDIARY TO OTHER ITEMS OF THE CONTRACT.

PLANS PREPARED BY



APPROVED - DATE

JAMES L. ARMOUR, P.E. CITY ENGINEER
CITY OF WICHITA, SEDGWICK COUNTY, KANSAS
CITY NO. 472-84415

DSNR: JPS OPER: DRP SCALE: 1/2005/05777/PLAN/05777-TITLE/8.DGN 2-13-2006 13:00:01 LAST REV: 8-30-2006 BY: snb

DATE	
BY	
SURVEYED	
PLOTTED	
INKED	
DESIGNED	
SOUND	