

PROJECT NO.	YEAR	SHEET NO.	TOTAL SHEETS
472-8418	2005	36	79

BM - C.O.W. Disc Top of Hub Guard
 East Side of Bridge
 (Riverside Drainage District Canal)
 15.76' East of CenterLine of Hydraulic.
 Elev. = 1265.13 MSL

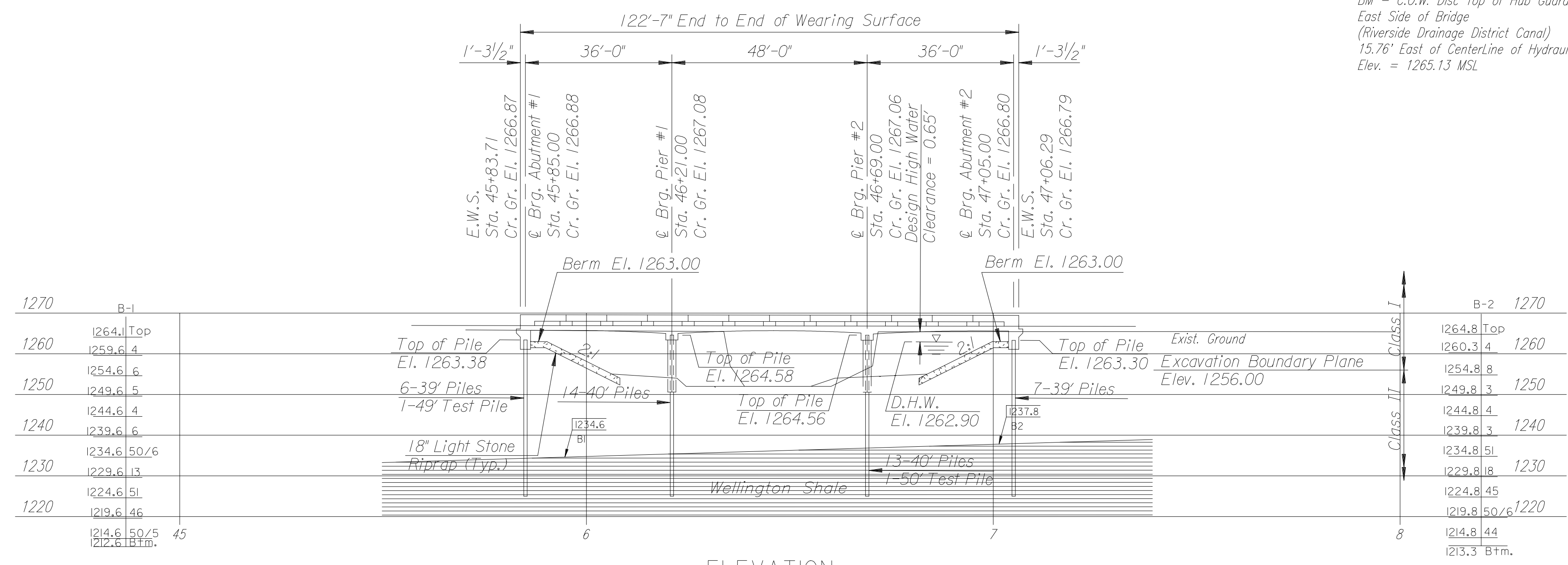

ELEVATION
 36'-48'-36' Continuous Reinforced Concrete Haunch Slab
 Pile Bent Type Abutments and Pile Bent Concrete Encased Piers
 Skew 15° Rt., 48'-0" Roadway, 6'-0" Sidewalk Lt. & Rt.

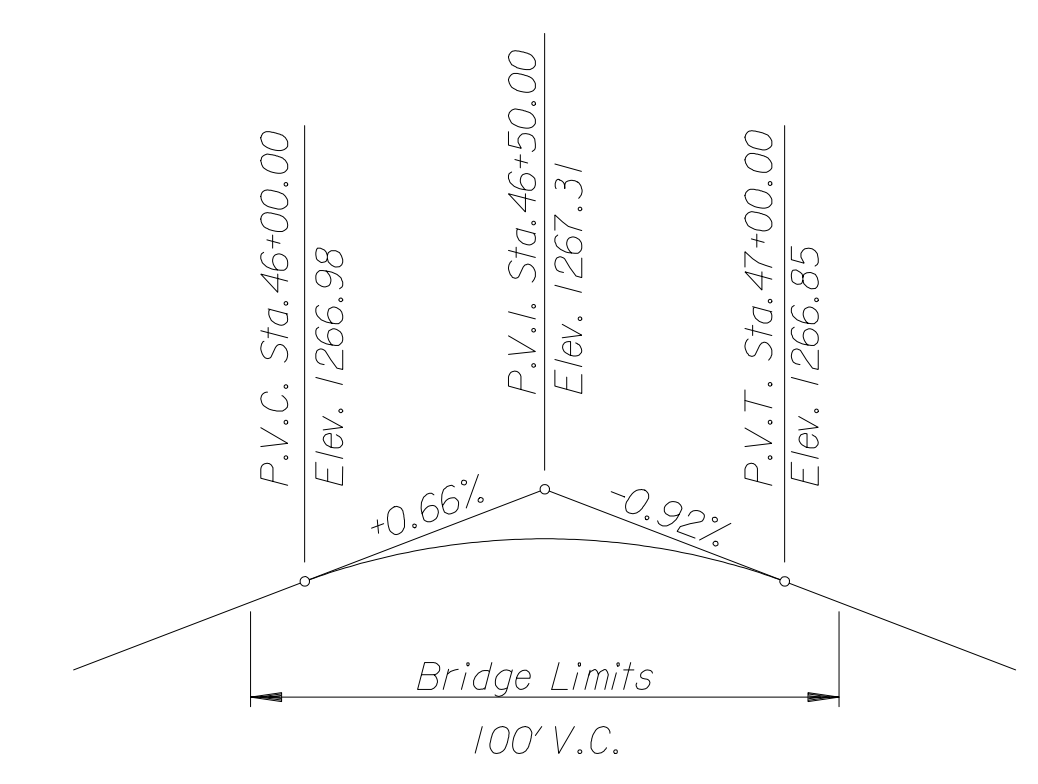

PROPOSED CROWN GRADE

DRAINAGE DATA

Drainage Area	8.4 Sq. Mi.
Design Frequency	50 Yr.
Design Discharge (Q ₅₀)	1740 CFS
Design High Water Elevation	1262.90 Ft.
Design Backwater	+0.04 Ft.
Design Backwater Elevation	1263.88 Ft.
Overtopping Elevation (Top of Levee)	1264.00 Ft.
Overtopping Discharge	2000 CFS
Overtopping Frequency	100 Yr.
Discharge at Q ₁₀₀	2010 CFS
Backwater at Q ₁₀₀	+0.03 Ft.
Backwater Elevation at Q ₁₀₀	1264.41 Ft.
Historic Highwater Elevation	Unknown Ft.
Ordinary Highwater Elevation	1255.00 Ft.
Total Waterway Provided	1066 Sq. Ft.
Design Waterway Provided	884 Sq. Ft.

Note:
 Discharges are based on those used in the Sedgwick County FEMA Flood Insurance Study.

LEGEND

- Riprap (Light Stone)
- Geotech boring location
- Thermal Expansion W=2" Type C

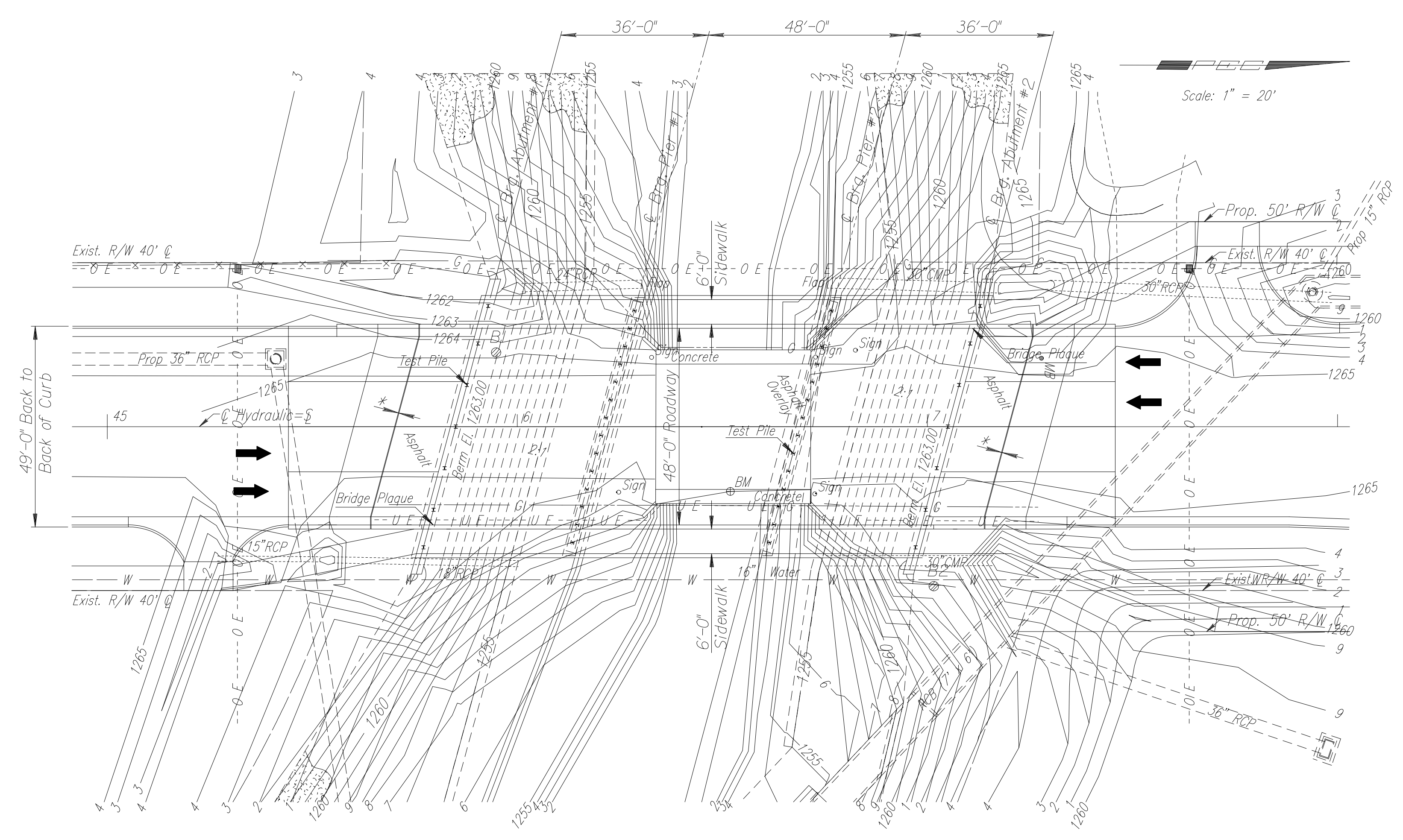

PLAN

Note: A Geotech report is available for viewing by qualified contractors at the City of Wichita Engineering office.

Drawn by: bjs/wll
 Plotted by: ras
 Drawing Name: i:\1999\99764\officecheck\99764_C-layout(EP)(18).dgn

No.	Revisions	By	Date

CITY OF WICHITA
 STRUCTURE NO. 5304008700LBS05 STA. 46+45.00
 55TH AND HYDRAULIC AVE.
CONSTRUCTION LAYOUT
 PROJECT NO. 472-8418 SEDGWICK COUNTY

Professional Engineering Consultants, P.A.
 303 S. TOPEKA • WICHITA, KANSAS 67202
 316-262-2991 • FAX 316-262-3003

Designed by	MSN	Checked by	RAS
Drawn by	WLL	Date	July 2005
		Job No.	99764