

PROJECT NO.	YEAR	SHEET NO.	TOTAL SHEETS
472-84118	2005	41	79

Roadway Width = 40'
 Longest Span Length = 48'
 Total No. of Spans = 3
 Skew and Direction = 0
 Loading = HS20
 Railing Type = Corral

Plotted By : ras
 Plot File : i:\1999\99764\officecheck\99764_C-Superd\12\EK1.dgn
 Server File : /usr2/
 Plot Date : 9-9-2005
 View: PLOT10

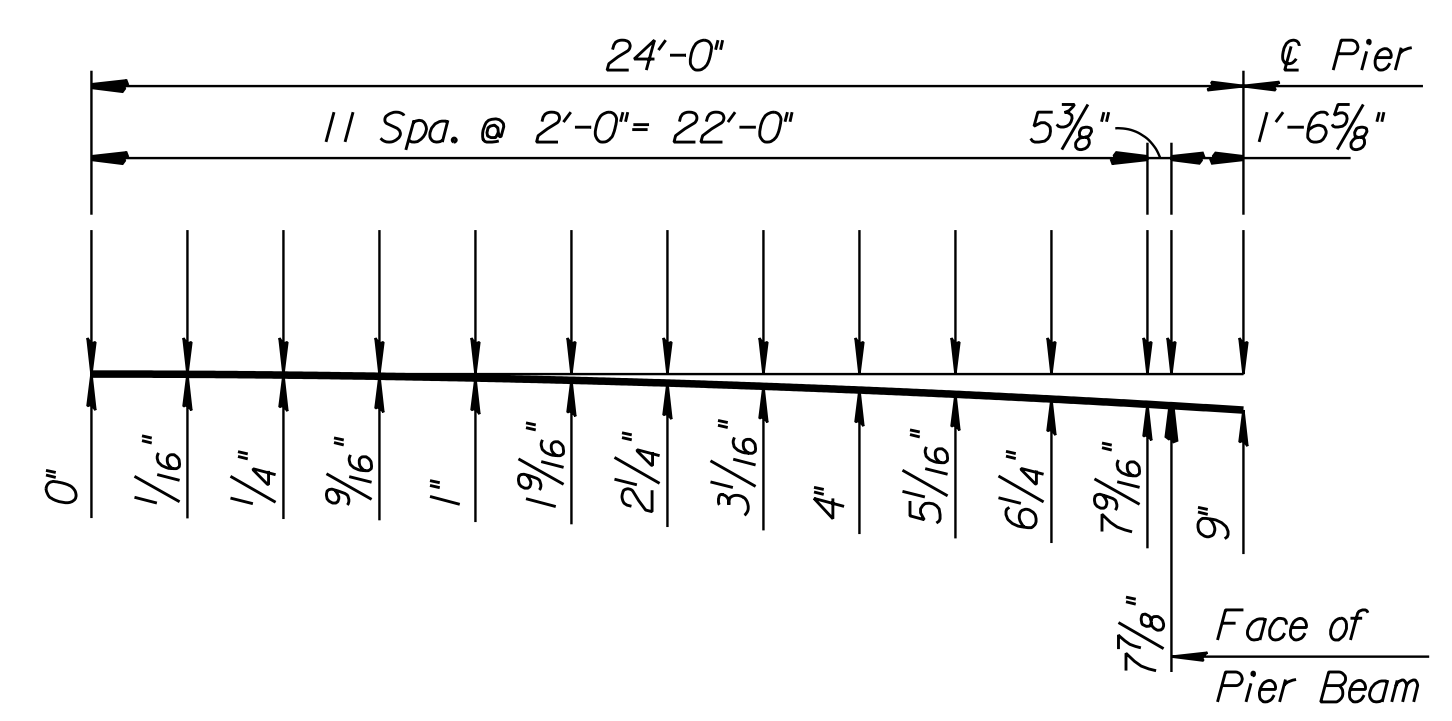

HAUNCH ORDINATES

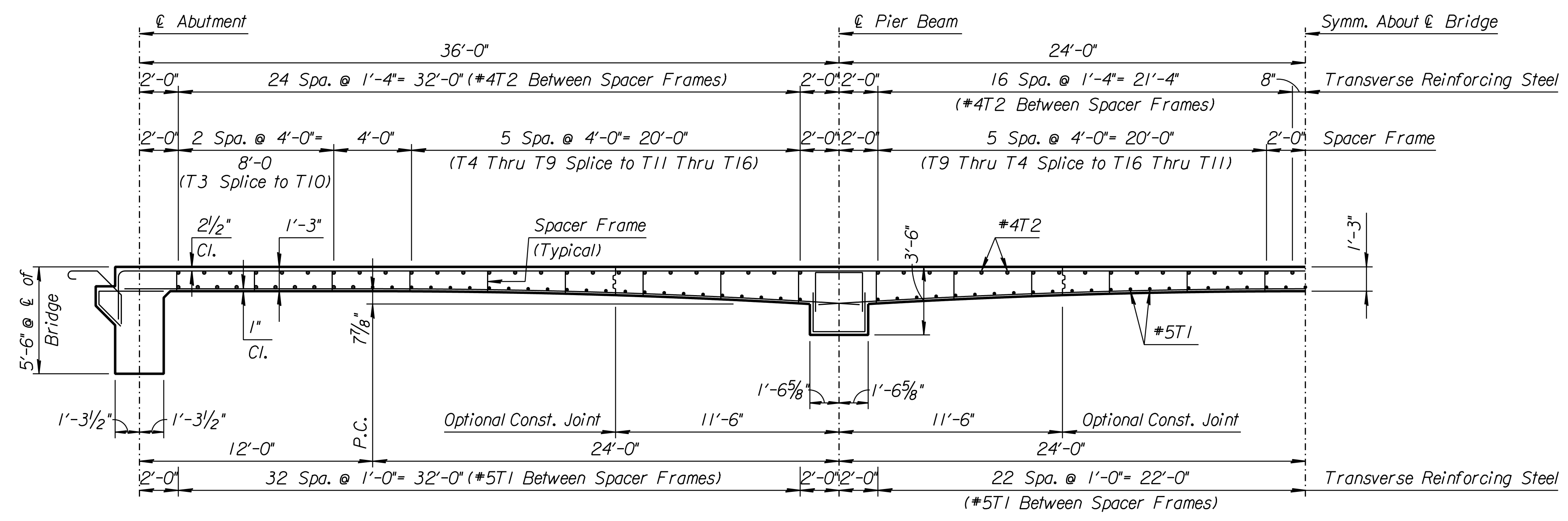

HALF LONGITUDINAL SECTION ALONG CL BRIDGE

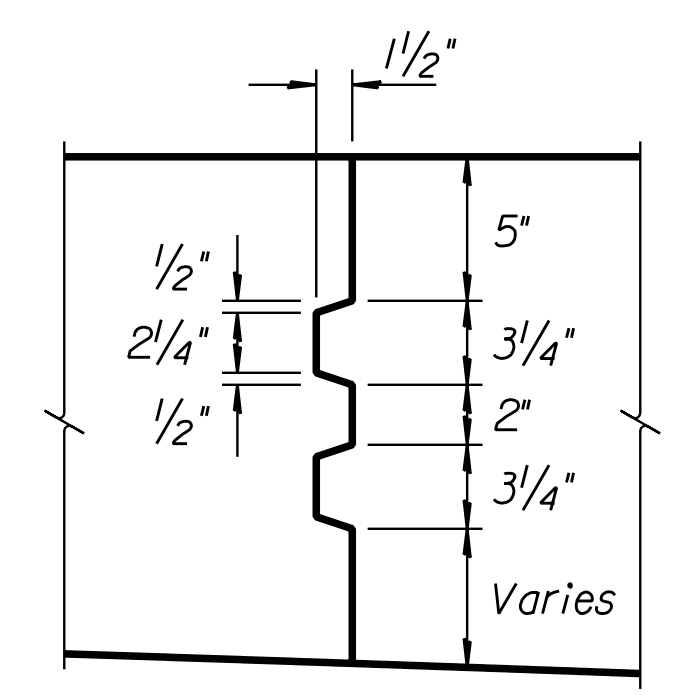

TRANSVERSE SLAB CONSTRUCTION JOINT
(Optional)

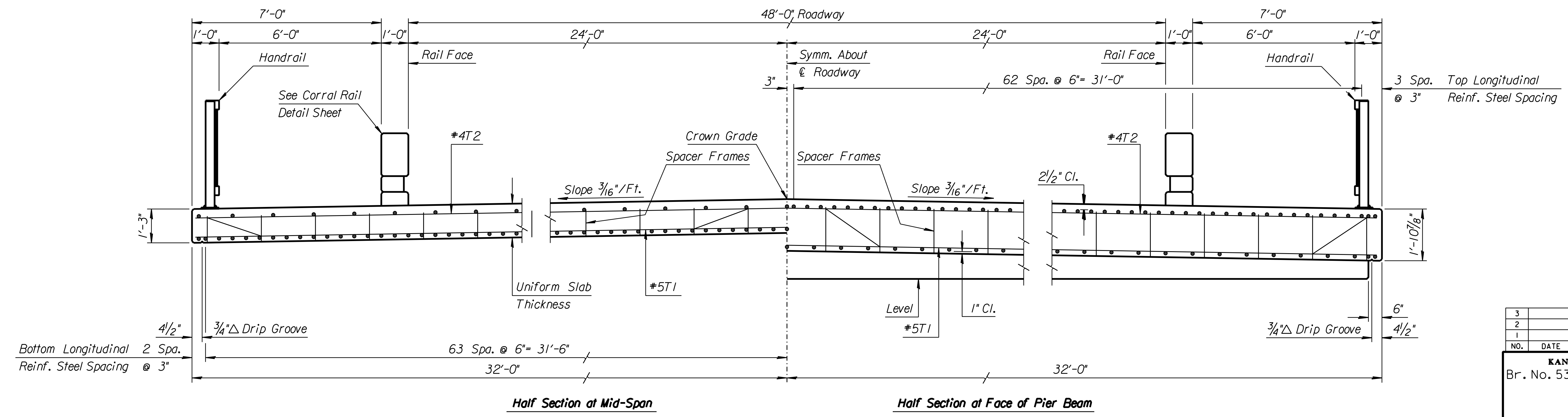

TYPICAL SECTION OF SLAB

3					
2					
1					
NO.	DATE	REVISIONS	BY	APP'D	
KANSAS DEPARTMENT OF TRANSPORTATION Br. No. 5304008700LBS05 Sta. 46+45.00 SUPERSTRUCTURE DETAILS Proj. No. 472-84118 Sedgwick Co.					
SHEET NO.	OF	SCALE	APP'D		
DESIGNED	CK.	DRT	DETAILED	DRT	QUANTITIES
DESIGN	CK.	BRI	DETAIL	CK.	MLL
			QUAN.	CK.	CADD
					BES
					CADD
					CK.