

PHASE II Continue Construction of Bridge Across the Riverside Drainage Canal.
 Detour Through Traffic to Broadway VIA 55th Street South and 63rd Street South.

PHASE IIa Construct SWS and Remove Pavement on West side of Hydraulic Ave. from the
 Riverside Drainage Canal to just North of 60th Street While maintaining 1 Lane Access
 to Properties from the Riverside Drainage Canal to 59th Street with Flagman as required,
 2 Way Traffic from 59th Street to 60th Street, and 1 Way Traffic North Bound on
 Existing Pavement from 60th Street to 63rd Street (South Bound Traffic VIA Kansas Ave).

PHASE IIb Construct SWS at Intersection of 60th Street & Hydraulic Ave. While
 Closing 60th Street just West of Hydraulic Ave. East-West Traffic on 61st Street.

PHASE IIc Construct SWS Cross Pipes to East side of Hydraulic Ave. With
 Flagman Traffic Control.

SCALE: 1" = 150'

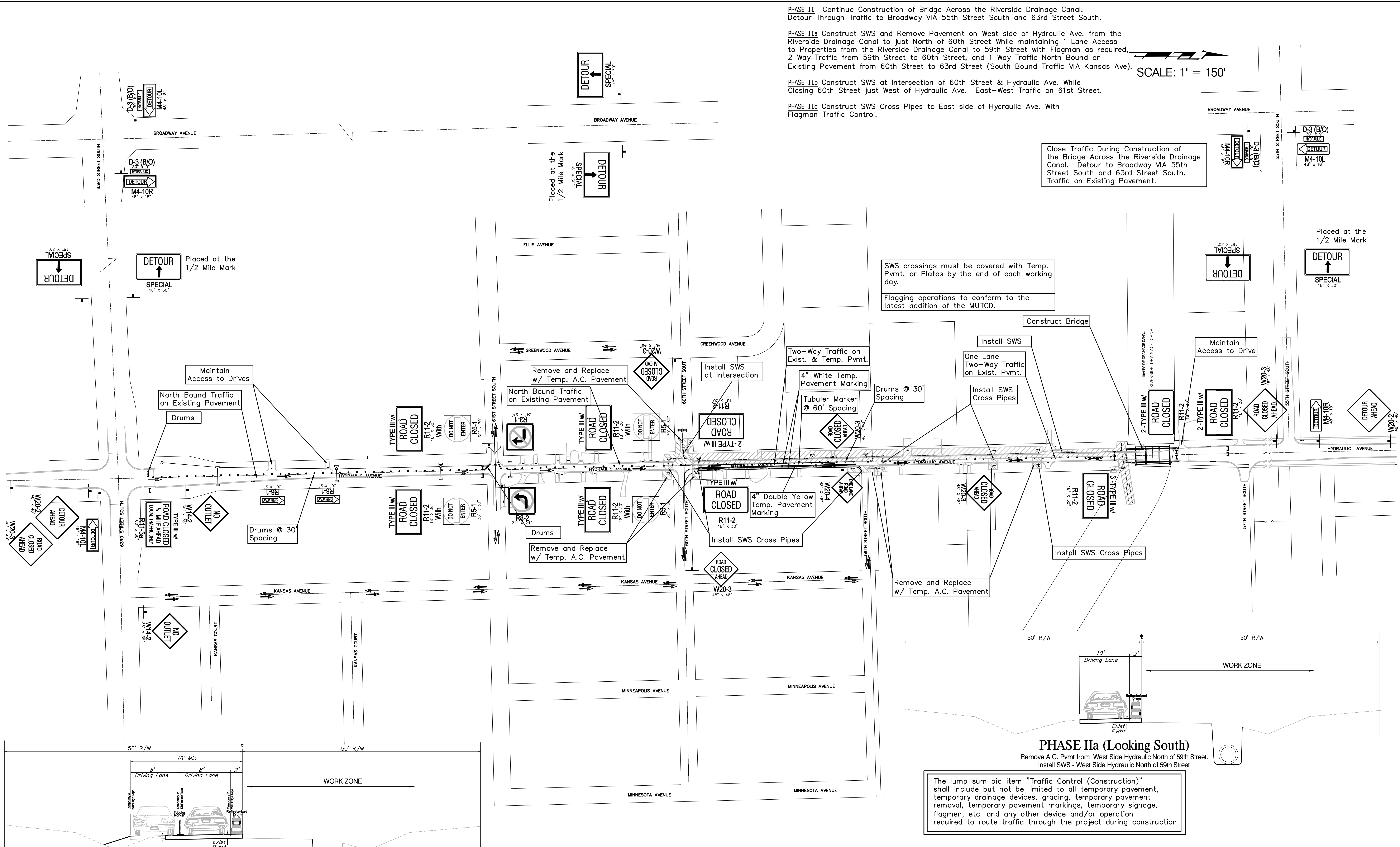

Close Traffic During Construction of
 the Bridge Across the Riverside Drainage
 Canal. Detour to Broadway VIA 55th
 Street South and 63rd Street South.
 Traffic on Existing Pavement.

SWS crossings must be covered with Temp.
 Pvmt. or Plates by the end of each working
 day.

Flagging operations to conform to the
 latest addition of the MUTCD.

Maintain
 Access to Drives
 North Bound Traffic
 on Existing Pavement
 Drums

Remove and Replace
 w/ Temp. A.C. Pavement
 North Bound Traffic
 on Existing Pavement

Install SWS
 at Intersection
 Two-Way Traffic on
 Exist. & Temp. Pvmt.
 4" White Temp.
 Pavement Marking
 Tubuler Marker
 @ 60' Spacing

Construct Bridge
 Install SWS
 One Lane
 Two-Way Traffic
 on Exist. Pvmt.
 Install SWS
 Cross Pipes

Maintain
 Access to Drive
 ROAD CLOSED
 ROAD CLOSED
 ROAD CLOSED
 ROAD CLOSED

Drums @ 30'
 Spacing

Drums

4" Double Yellow
 Temp. Pavement
 Marking

Install SWS Cross Pipes

Install SWS Cross Pipes

Remove and Replace
 w/ Temp. A.C. Pavement

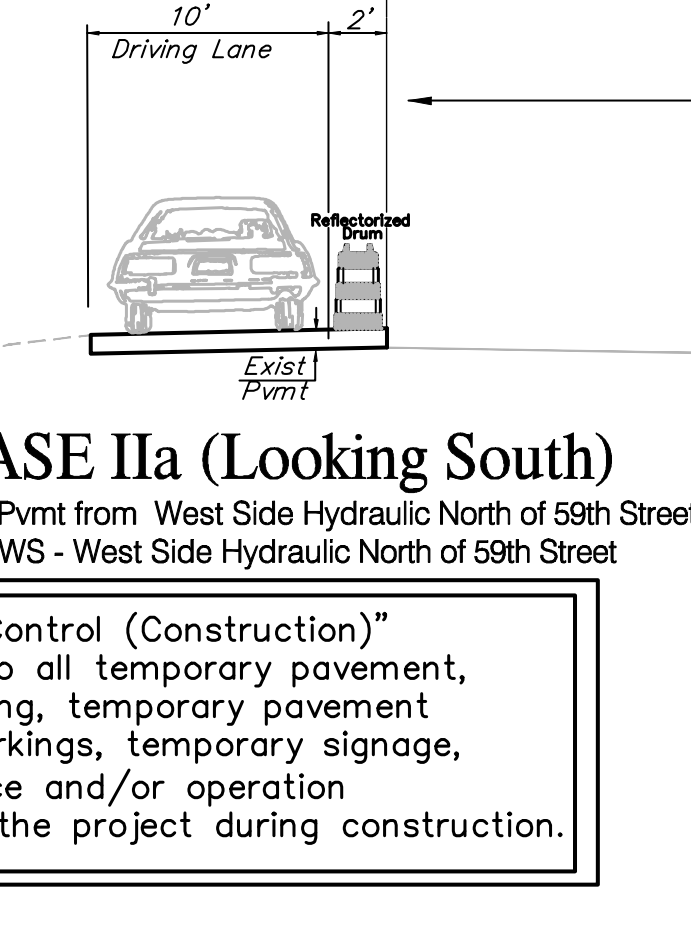
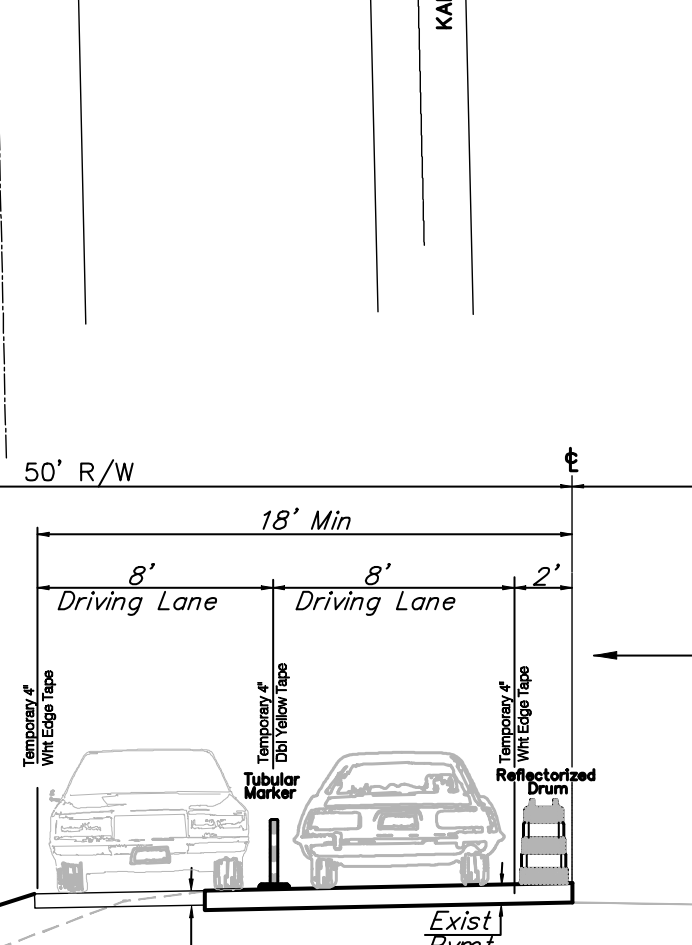
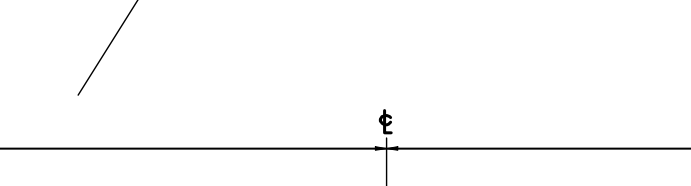
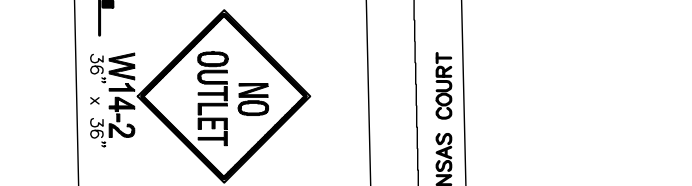

PHASE IIa (Looking South)
 Remove A.C. Pvmt from West Side Hydraulic 59th Street to 60th Street
 Install SWS - West Side Hydraulic 59th Street to 60th Street

PHASE IIa (Looking South)
 Remove A.C. Pvmt from West Side Hydraulic North of 59th Street.
 Install SWS - West Side Hydraulic North of 59th Street

The lump sum bid item "Traffic Control (Construction)" shall include but not be limited to all temporary pavement, temporary drainage devices, grading, temporary pavement removal, temporary pavement markings, temporary signage, flagmen, etc. and any other device and/or operation required to route traffic through the project during construction.