

PHASE V Continue Construction of Bridge Across the Riverside Drainage Canal.
 Detour Through Traffic to Broadway Via 55th Street South and 63rd Street South.

PHASE Va Construct Roadway on East side of Hydraulic Ave. from North of 63rd Street
 to the Riverside Drainage Canal While maintaining 2 Way Traffic on New West Side
 Pavement from 63rd Street to the Riverside Drainage Canal. East-West Traffic on
 60th Street.

SCALE: 1" = 150'

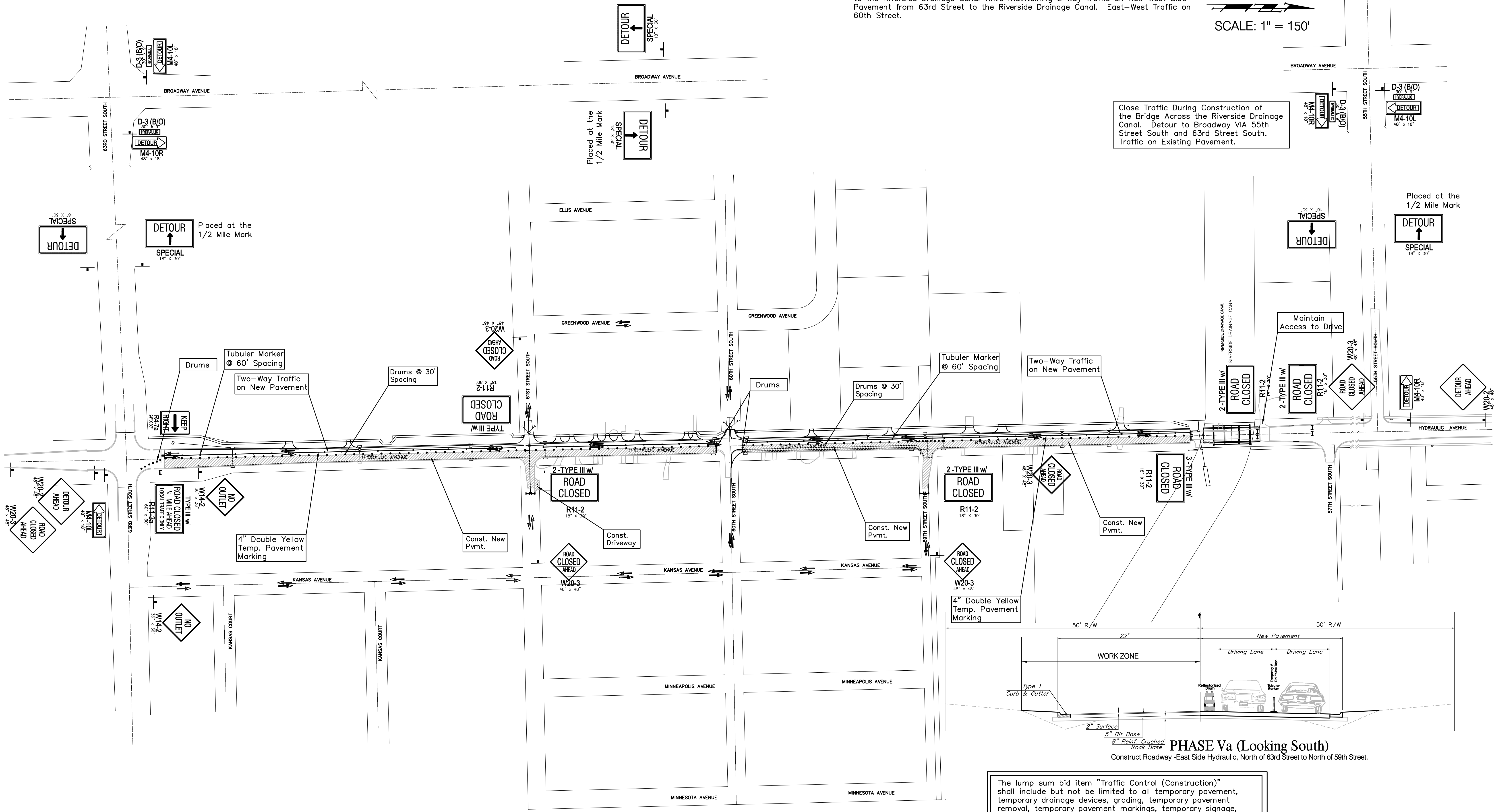

Close Traffic During Construction of the Bridge Across the Riverside Drainage Canal. Detour to Broadway VIA 55th Street South and 63rd Street South. Traffic on Existing Pavement.

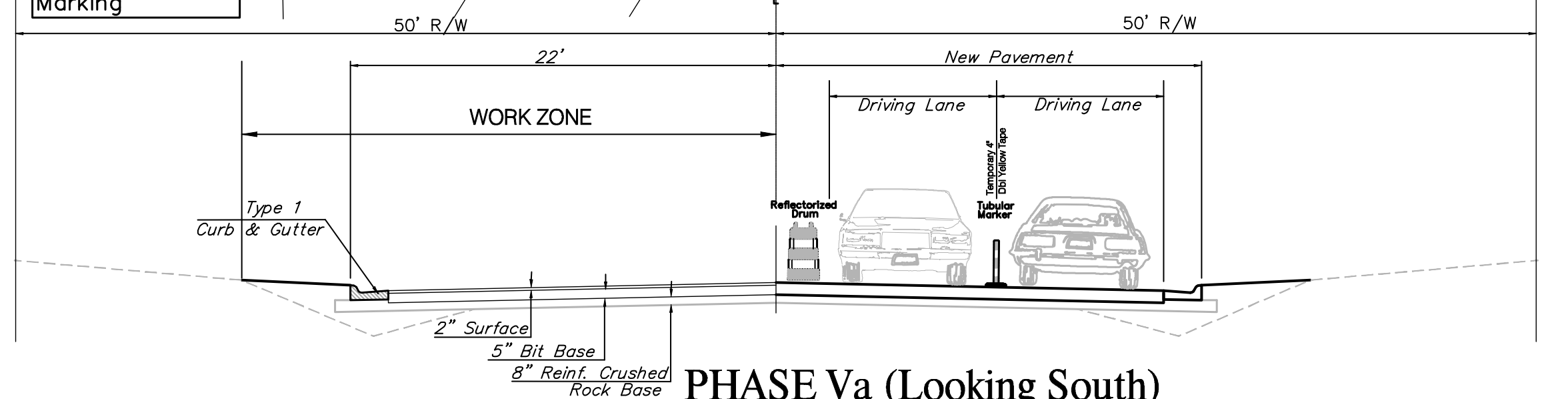

PHASE Va (Looking South)
 Construct Roadway - East Side Hydraulic, North of 63rd Street to North of 59th Street.

The lump sum bid item "Traffic Control (Construction)" shall include but not be limited to all temporary pavement, temporary drainage devices, grading, temporary pavement removal, temporary pavement markings, temporary signage, flagmen, etc. and any other device and/or operation required to route traffic through the project during construction.