

STATE	PROJECT NO.	YEAR	SHEET NO.	TOTAL SHEETS
KANSAS	87 N-0247-01	2005	13	48

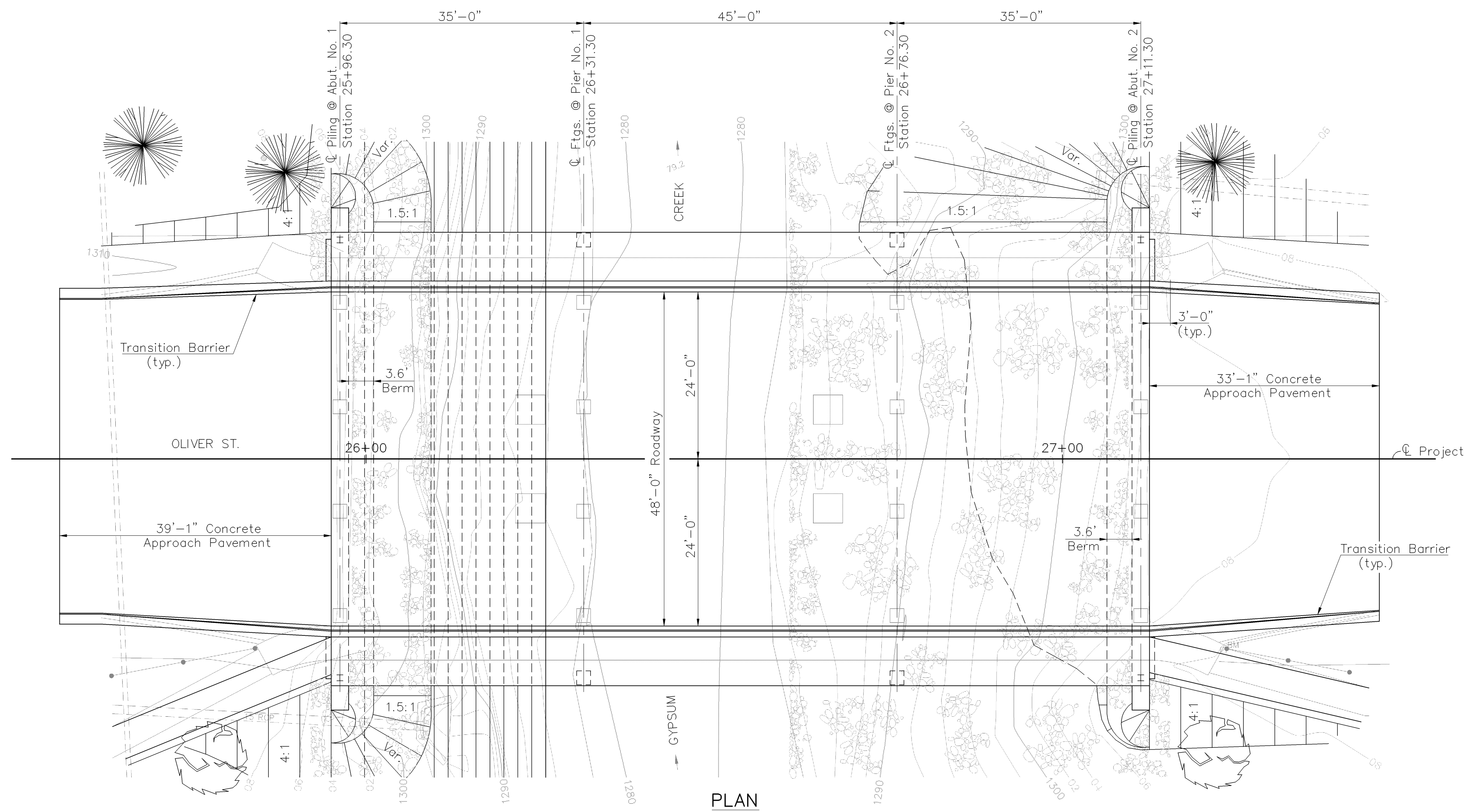
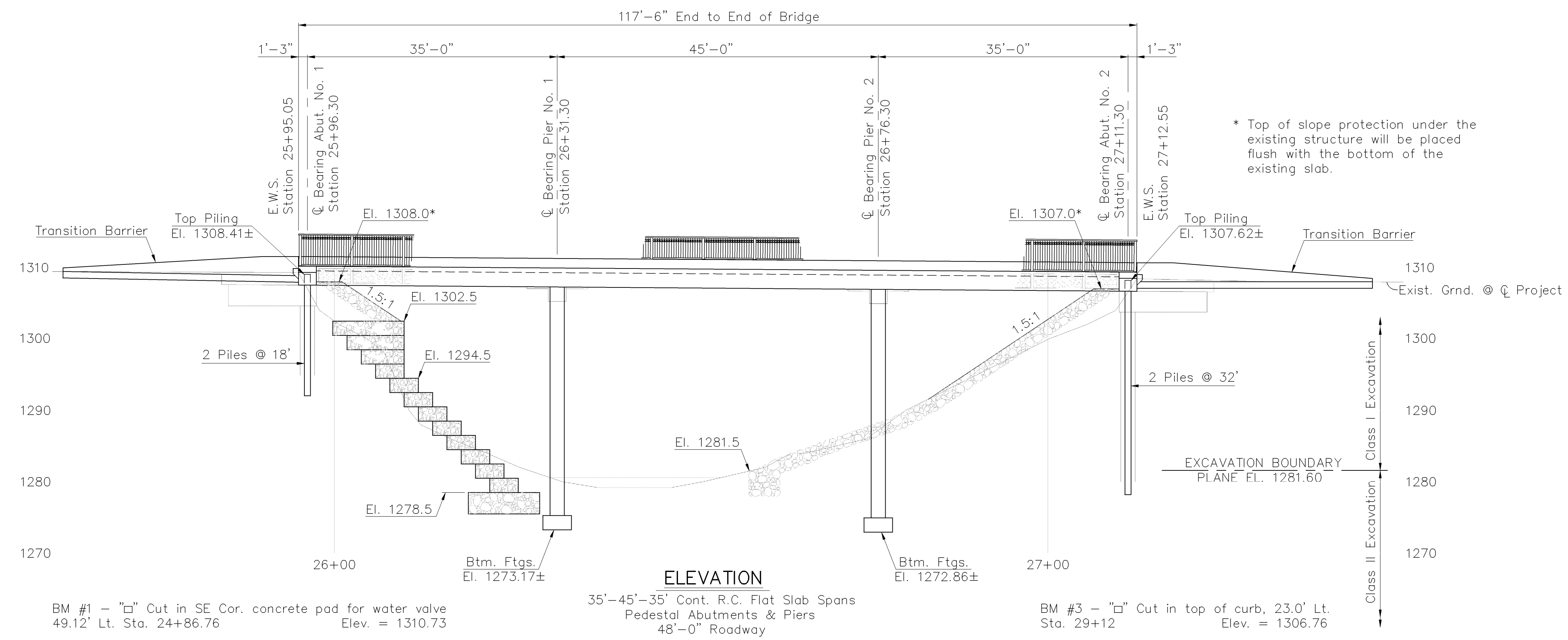

J:\2003PROJ\03548\DWGS\CL 1"=10'

PROJECT NO. 87 N-0247-01		CFS Cook, Flatt & Strobel ENGINEERS, P.A.
CONSTRUCTION LAYOUT		
OLIVER ST. BRIDGE OVER GYPSUM CREEK		DESIGNED RSC SCALE
STA. 26+53.8 CITY OF WICHITA		DETAILED DEG DATE
		QUANTITIES SHEET OF