

COUNTY	STATE	PROJECT NUMBER	FISCAL YEAR	SHEET NO.	TOTAL SHEETS
SEDGWICK	KANSAS	87 N-0237-01	2006	50	78



- LEGEND:**
- TRAFFIC FLOW (FOR PLAN USE ONLY)
 - REFLECTORIZED DRUMS @ 30' SPACING OR AS NOTED
 - REFLECTORIZED TUBULAR MARKERS @ 30' SPACING OR AS NOTED
 - ▬ TYPE III BARRICADE WITH TYPE A LOW INTENSITY FLASHERS
 - SIGN
 - ▨ PHASE I WORK AREA

REQUIRED SUB-PHASES OF CONSTRUCTION DURING PHASE I

PHASE I CONSTRUCTION WILL RESULT IN THE COMPLETION OF THE SOUTH LANES WITH CURB & GUTTER FOR PARKWAY EAST OF PALISADE AVENUE. THE ORDER OF THE SUB-PHASES OF THE PROJECT, AND PHASING OF TRAFFIC CONTROL SHALL BE APPROVED BY THE FIELD ENGINEER.

CONSTRUCTION ACTIVITY:	TRAFFIC CONTROL REQUIREMENTS:
PHASE 1A REMOVE EXISTING MEDIUM IN PARKWAY FROM MAIN TO MARKET, EXISTING MEDIUM IN PARKWAY FROM MARKET TO APPROX. 230' EAST OF CL MARKET. REPLACE WITH TEMPORARY ASPHALT PAVEMENT.	MAINTAIN ONE WEST BOUND LANE AND ONE EAST BOUND LANE IN PARKWAY (UNIDIRECTIONAL).
PHASE 1B CONSTRUCT SOUTH LANES WITH COMBINED CURB & GUTTER EAST OF PALISADE.	MAINTAIN ONE WEST BOUND LANE AND ONE EAST BOUND LANE IN PARKWAY USING NORTH HALF OF EXIST. PAVEMENT.
PHASE 1C CONSTRUCT SOUTH LANES AND CENTER MEDIAN, WITH COMBINED CURB & GUTTER FROM EAST EDGE OF PALISADE TO APPROX. 230' EAST OF CL MARKET. RE-CONSTRUCT PARK ENTRANCE.	MAINTAIN ONE WEST BOUND LANE AND ONE EAST BOUND LANE IN PARKWAY USING NORTH HALF OF EXIST. PAVEMENT. COORDINATE TRAFFIC FLOW INTO PARK.
PHASE 1D CONSTRUCT SOUTH LANES WITH COMBINED CURB & GUTTER FROM MARKET TO THE EAST EDGE OF MAIN STREET.	MAINTAIN ONE WEST BOUND LANE AND ONE EAST BOUND LANE IN PARKWAY USING NORTH HALF OF EXIST. PAVEMENT.
PHASE 1E CONSTRUCT SOUTH LANES WITH COMBINED CURB & GUTTER FROM MARKET TO THE WEST EDGE OF MARKET.	MAINTAIN ONE WEST BOUND LANE AND ONE EAST BOUND LANE IN PARKWAY USING NORTH HALF OF EXIST. PAVEMENT.
PHASE 1F CONSTRUCT SOUTH LANES WITH COMBINED CURB & GUTTER FROM MARKET TO WEST EDGE OF MARKET TO EAST END OF PROJECT.	MAINTAIN ONE WEST BOUND LANE AND ONE EAST BOUND LANE IN PARKWAY. CONTACT WICHITA POLICE DEPARTMENT AND POLICE SUBSTATION.

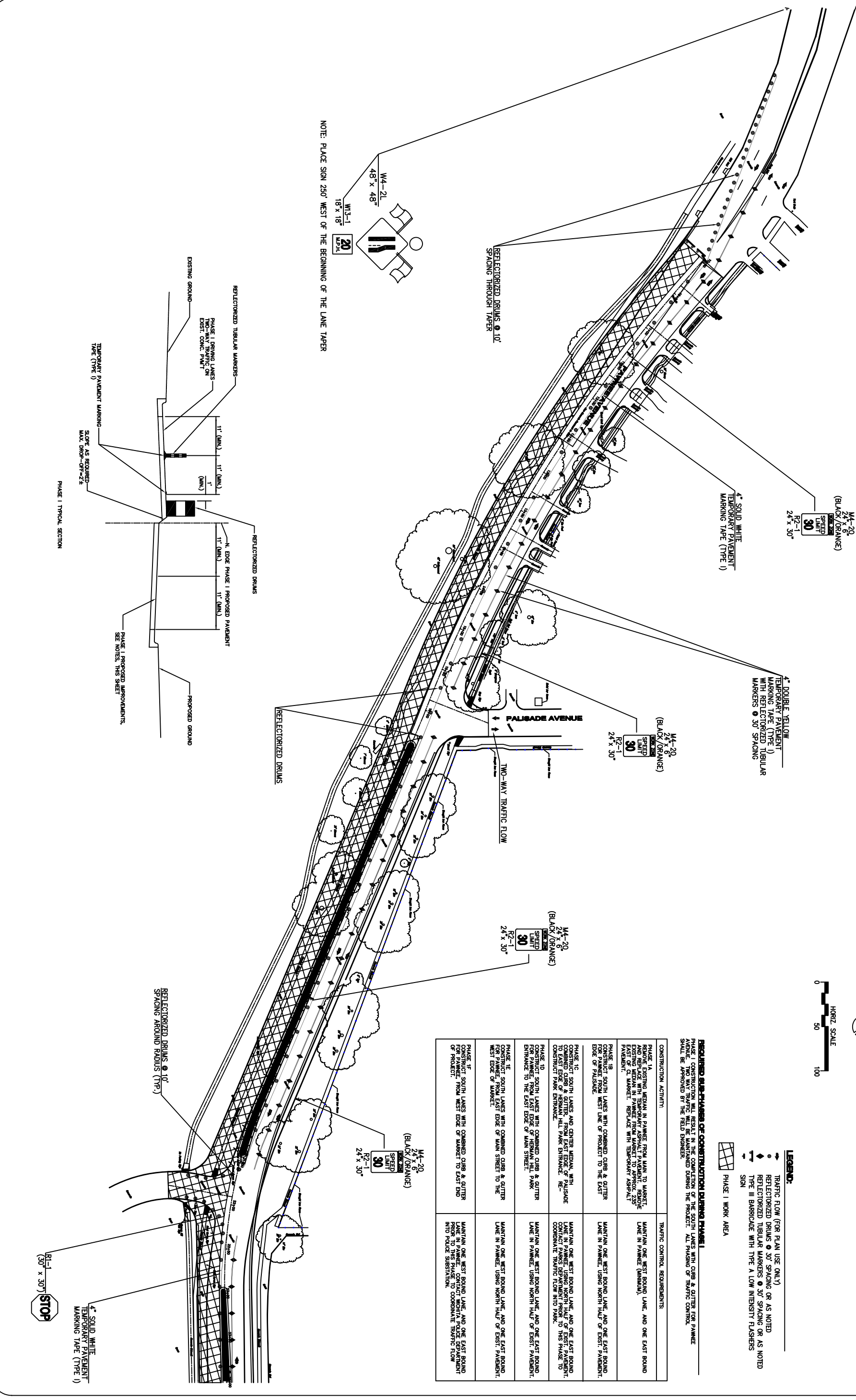

NOTE: PLACE SIGN 250' WEST OF THE BEGINNING OF THE LANE TAPER

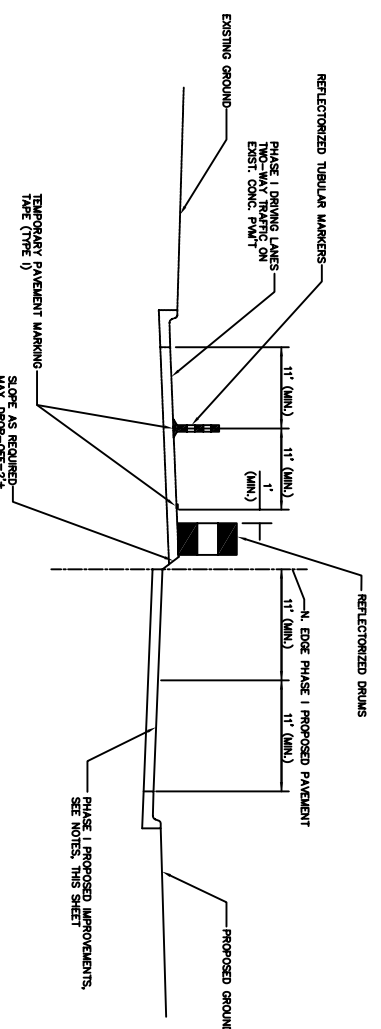

scale: as noted
 drawn by: dds
 checked by: cry
 date: Mar. 2006
 P/N: 04-179
 revisions:

**TRAFFIC CONTROL PLAN
 PHASE I**

Paving & Storm Sewer Improvements
 City of Wichita
 Sedgwick County, Kansas

YOUNG & ASSOCIATES, P.A.
 Civil and Environmental Engineers

100 S. Georgie, Derby, KS 67037
 Tel: (316)788-2552
 Fax: (316)788-4408

Sheet No.
 50 of 78