

GENERAL NOTES

- 1) **CONCRETE**
SHALL HAVE A MINIMUM COMPRESSIVE STRENGTH OF 4,000 PSI AT 28 DAYS. CONTRACTOR SHALL SUBMIT CONCRETE MIX DESIGN TO ENGINEER FOR APPROVAL PRIOR TO CONSTRUCTION.
- 2) **CONCRETE**
SHALL CONFORM TO THE CURRENT "ACI MANUAL OF CONCRETE PRACTICE".
- 3) **CONCRETE COVER**
SHALL BE 3" IN BOTTOM OF FOOTING CAST AGAINST SOIL. ALL OTHER COVER SHALL BE 3".
- 4) **PORTLAND CEMENT**
SHALL CONFORM TO ASTM C-150, TYPE I OR III.
- 5) **AGGREGATE**
FOR NORMAL WEIGHT CONCRETE SHALL MEET ASTM C33.
- 6) **REINFORCING**
SHALL MEET ASTM A615 OR GR 60.
- 7) **FOOTINGS**
SHALL BEAR ON UNDISTURBED EARTH OR ENGINEERED FILL AT ELEVATIONS SHOWN ON DETAILS.
- 8) **EARTHWORK**
SHALL BE CONSIDERED SUBSIDIARY TO WEIR CONSTRUCTION.

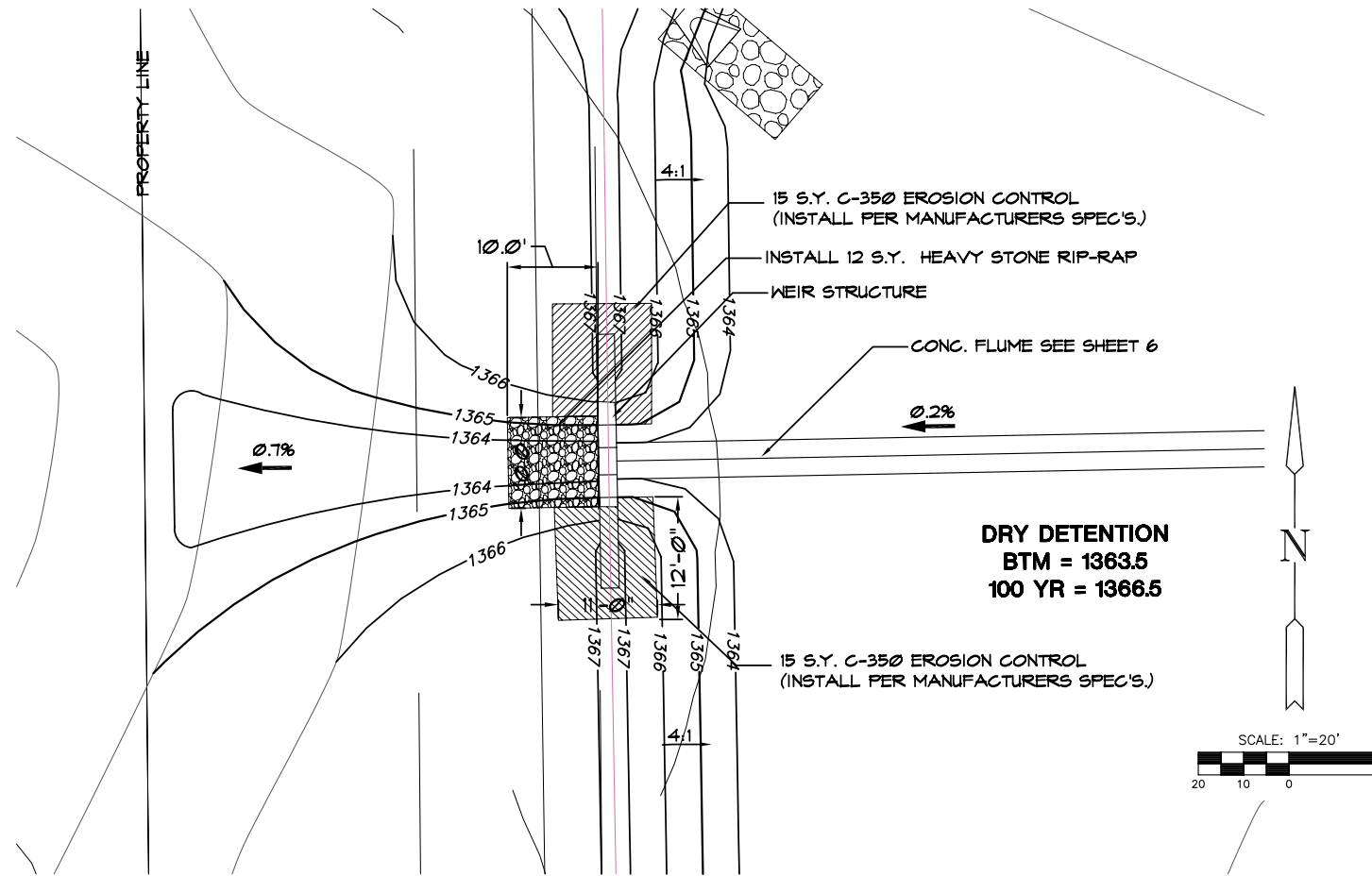

WEIR PLAN VIEW

1"=20'

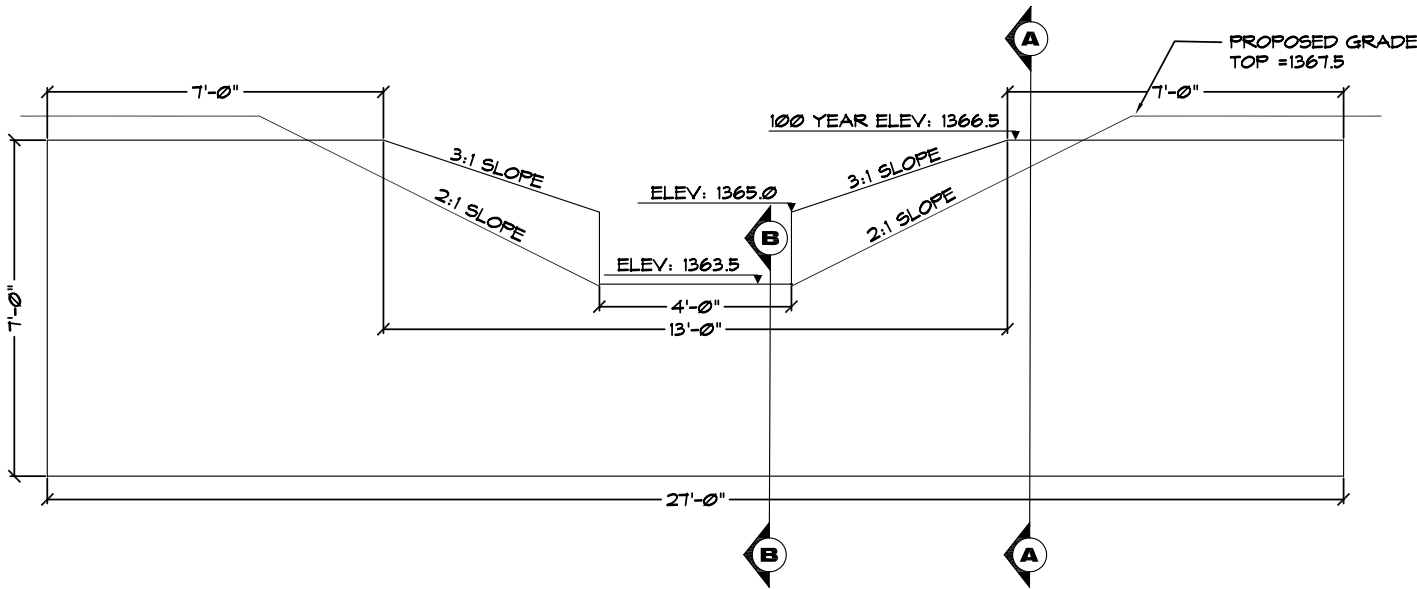

WEIR WALL ELEVATION -UPSTREAM

1/2"=1'-0"

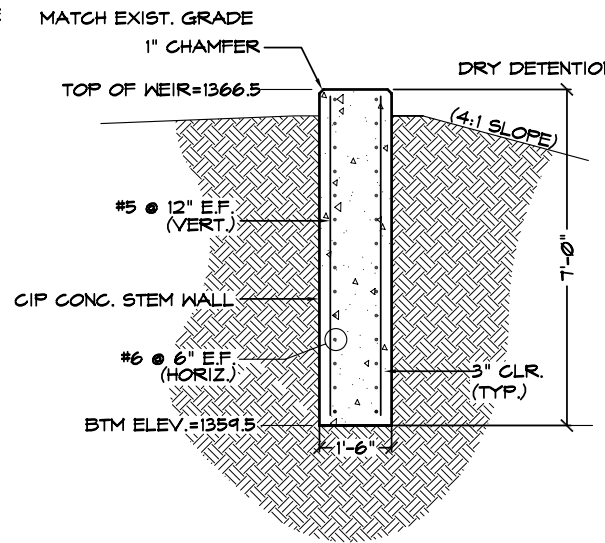

SECTION A

1/2"=1'-0"

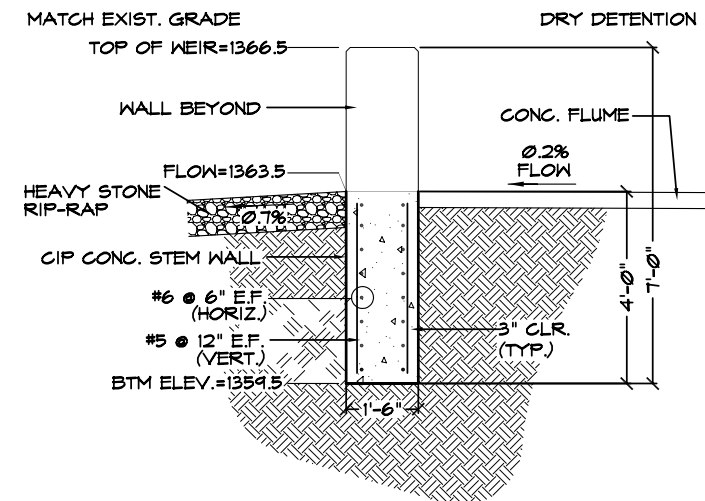

SECTION B

1/2"=1'-0"

**WEIR
STRUCTURE
DETAIL**

SHEET TITLE
468-84318
PROJECT NUMBER

MLP
DESIGN BY
MLP
DRAWN BY
GJA
CHECKED BY

ISSUED
March 07
REVISED

SHEET NO.
7 of 16