

**GRADING PLANS**  
**MONARCH LANDING ADDITION**  
**PHASE 1**

1. EROSION CONTROL IS TO MEET ALL FEDERAL, STATE, COUNTY & LOCAL CODE STANDARDS.
2. CONTRACTOR SHALL PROVIDE AND PRESERVE EROSION PROTECTION THROUGHOUT PROJECT CONSTRUCTION. THE PLAN PROVIDED HERE IS FOR FINAL PROTECTION, VARIOUS PHASES OF THIS PLAN SHALL BE IMPLEMENTED OR MODIFIED TO CONTROL EROSION. MODIFICATIONS OF THE PLAN SHALL BE APPROVED BY THE OWNERS REPRESENTATIVE.
3. SEEDING AREAS SHALL BE PREPARED FOR PLANTING WITH COMMON AGRICULTURAL TECHNIQUES. ALL RESERVE AREAS SHALL BE FINE GRADED USING SMALL EQUIPMENT. REMOVE EXISTING GRASS, VEGETATION AND TURF. DO NOT MIX INTO SURFACE SOIL. LOOSEN SOIL TO A DEPTH OF AT LEAST 6 INCHES. GRADE AREAS TO A SMOOTH UNIFORM SURFACE PLANE. ROLL, RAKE, AND REMOVE RIDGES AND FILL DEPRESSIONS. THE SURFACE SHALL BE FREE FROM STICKS, SMALL STONES, AND OTHER EXTRANEOUS MATERIALS. APPROVE WITH OWNER'S REPRESENTATIVE BEFORE PLANTING.
4. CONTRACTOR IS RESPONSIBLE FOR MAINTAINING AND IMPLEMENTING ALL EROSION CONTROL. COST IS SUBSIDIARY TO CHECK DAMS AND STABILIZED CONSTRUCTION ENTRANCE.
5. ALL SEED SHALL BE DISTRIBUTED WITH AN ACCEPTABLE DRILL INTENDED FOR SUCH OPERATIONS, OR OTHER EQUIPMENT APPROVED BY THE OWNER'S REPRESENTATIVE. SEEDING DEPTH SHALL BE 1/4".
6. SEED AND FERTILIZE AS FOLLOWS:  
PERENNIAL RYE @ 200 LBS./ACRE  
10-20-10 @ 350 LBS./ACRE
7. ALL SEEDED AREAS SHALL BE IMMEDIATELY MULCHED W/ PRAIRIE HAY AT 2 TONS/ACRE. ANCHOR MULCH BY CRIMPING INTO TOPSOIL WITH SUITABLE MECHANICAL EQUIPMENT.
8. TREE PROTECTION FENCE: SEE INDIVIDUAL GRADING SHEETS FOR TREE PROTECTION FENCE LOCATION. TOTAL QUANTITY OF TREE PROTECTION FENCE TO BE INSTALLED = 2,900 LF.

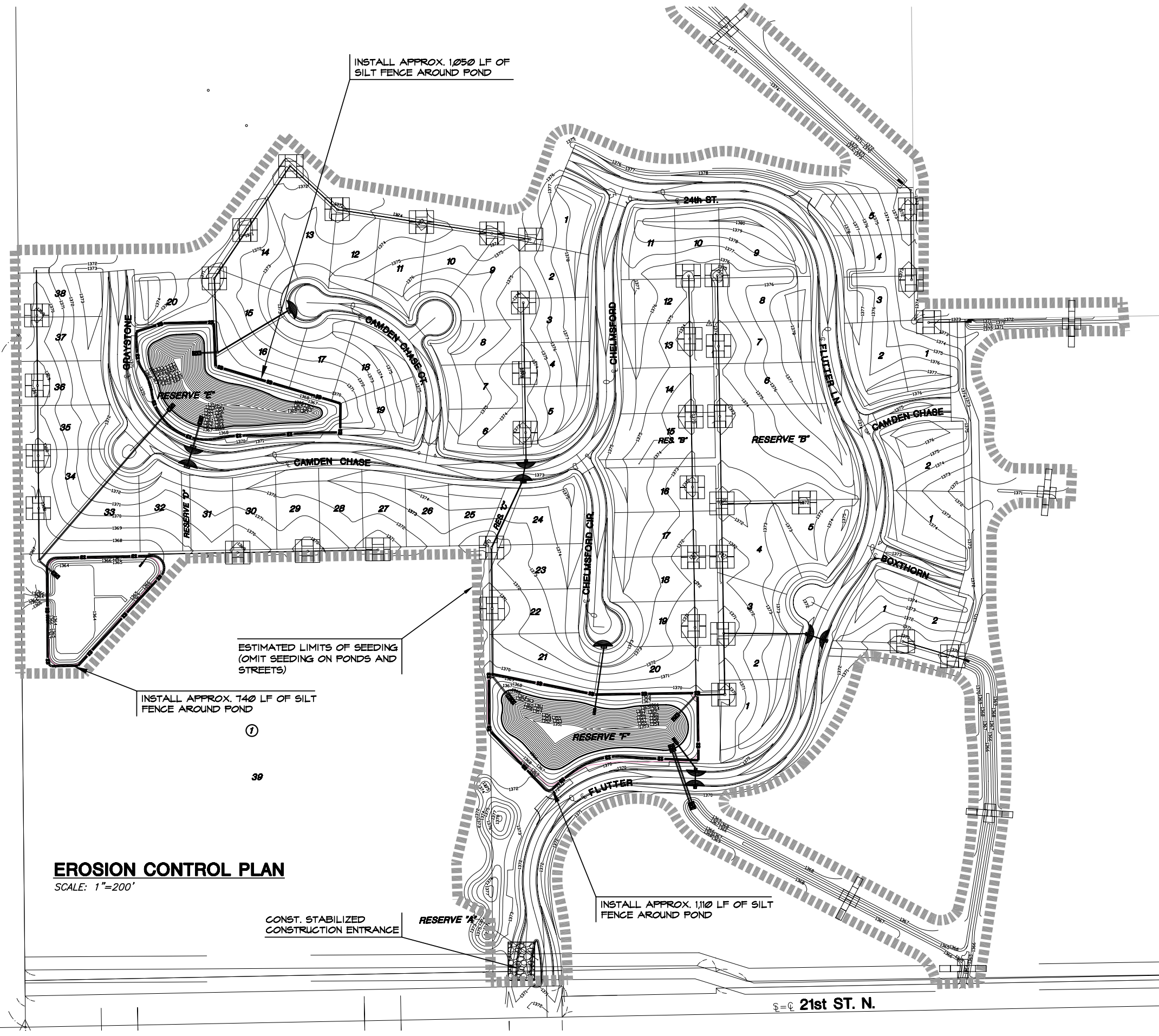

INSTALL APPROX. 1050 LF OF SILT FENCE AROUND POND

ESTIMATED LIMITS OF SEEDING (OMIT SEEDING ON PONDS AND STREETS)

INSTALL APPROX. 740 LF OF SILT FENCE AROUND POND

INSTALL APPROX. 1,110 LF OF SILT FENCE AROUND POND

CONST. STABILIZED CONSTRUCTION ENTRANCE

**EROSION CONTROL PLAN**  
SCALE: 1"=200'



**EROSION CONTROL LEGEND**

- ESTIMATED SEEDING LIMIT (44.5 AC.) (OMIT SEEDING FROM PONDS AND STREETS)
- PROPOSED STORM SEWER LINE
- PROPOSED CONTOURS
- CURB INLET FILTER
- INLET PROTECTION
- TEMPORARY SWALE PROTECTION
- SILT FENCE PROTECTION (2,900 LF)

**EROSION CONTROL/SEEDING PLAN**

SHEET TITLE  
468-84318  
PROJECT NUMBER

MLP  
DESIGN BY  
MLP  
DRAWN BY  
GJA  
CHECKED BY

ISSUED  
March 07  
REVISED

SHEET NO.  
8 of 16