

FHWA REGION NO.	STATE	PROJECT NUMBER	FISCAL YEAR	SHEET NUMBER	TOTAL SHEETS
7	KANSAS	87N-0385-01	2006	32	43

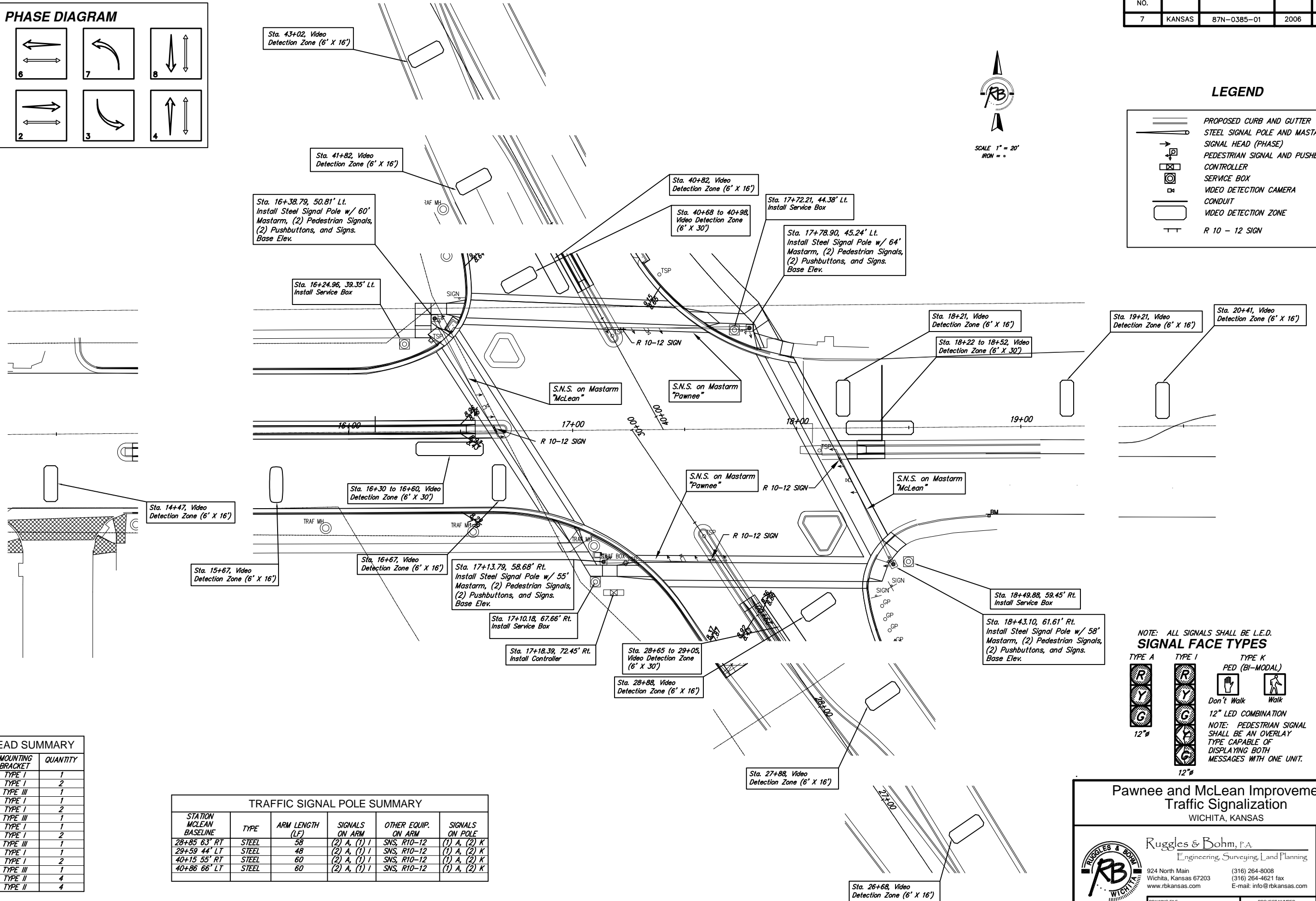
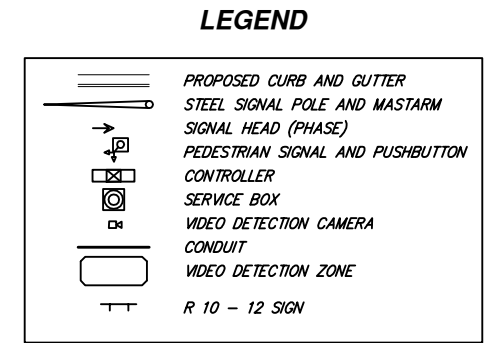
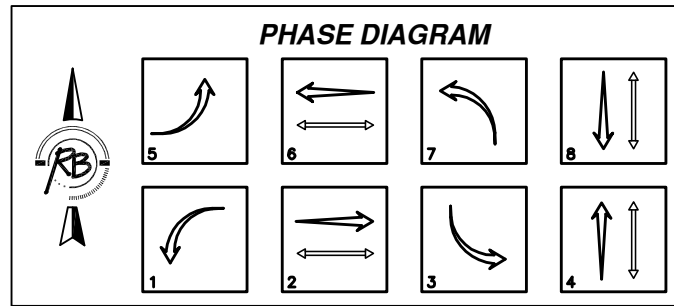

#### TRAFFIC SIGNAL HEAD SUMMARY

SIGNAL PHASE	TYPE	MOUNTING BRACKET	QUANTITY
1	I	TYPE I	1
2	A	TYPE I	2
2	A	TYPE III	1
3	I	TYPE I	1
4	A	TYPE I	2
4	A	TYPE III	1
5	I	TYPE I	1
6	A	TYPE I	2
6	A	TYPE III	1
7	I	TYPE I	1
8	A	TYPE I	2
8	A	TYPE III	1
2-6P	K	TYPE II	4
4-8P	K	TYPE II	4

#### TRAFFIC SIGNAL POLE SUMMARY

STATION MCLEAN BASELINE	TYPE	ARM LENGTH (LF)	SIGNALS ON ARM	OTHER EQUIP. ON ARM	SIGNALS ON POLE
28+85 63' RT	STEEL	58	(2) A, (1) I	SNS, R10-12	(1) A, (2) K
29+59 44' LT	STEEL	48	(2) A, (1) I	SNS, R10-12	(1) A, (2) K
40+15 55' RT	STEEL	60	(2) A, (1) I	SNS, R10-12	(1) A, (2) K
40+86 66' LT	STEEL	60	(2) A, (1) I	SNS, R10-12	(1) A, (2) K

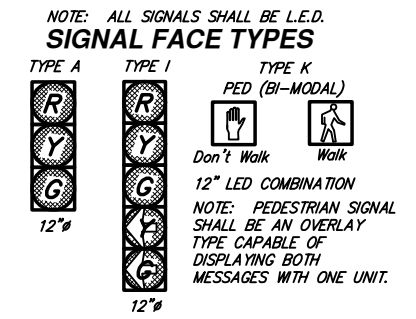

### Pawnee and McLean Improvements Traffic Signalization

WICHITA, KANSAS

**Ruggles & Bohm, P.A.**  
Engineering, Surveying, Land Planning

924 North Main  
Wichita, Kansas 67203  
www.rbkansas.com

(316) 264-8008  
(316) 264-4621 fax  
E-mail: info@rbkansas.com

DESIGN: PDC  
DRAWN: PDC  
REVIEW: 11/10/05  
UTILITY: 32 OF 43

DRAWING FILE: Traffic Cont/Traffic Signal  
PROJECT NUMBER: 472-84007  
DATE: Oct. 22, 2005