

STATE	PROJECT NO.	YEAR	SHEET NO.	TOTAL SHEETS
KANSAS	54-87 K-8258-02	2003	12	76

- N 1/4. Cor Sec. 30, T27S, R2E
1. Cross Cut in Top of Light Ploe Base 15.859 m S.W.
  2. Cross Cut in Top of Median Curb 15.633 m W.S.W.
  3. Cross Cut in Top of Median Curb 15.619 m E.S.E.
  4. 0.013 m Rebar with Plastic Cap 25.189 m S.S.E.

- Ctr. Cor Sec. 19, T27S, R2E
1. Spike and Washer in Power Pole 15.567 m S.
  2. Cross Cut in Top of Curb 8.028 m N.E.
  3. Cross Cut in Top of Curb 8.701 m S.E.
  4. Cross Cut in Top of Curb 7.007 m S.W.

- Ctr. Cor. Sec. 30, T27S, R2E
1. Cross Cut in Corner of Sidewalk 21.000 m N.E.
  2. Cross Cut in Top of Curb 12.532 m N.W.
  3. Cross Cut in Corner of Sidewalk 17.070 m S.W.
  4. Cross Cut in Corner of Sidewalk 20.962 m S.E.

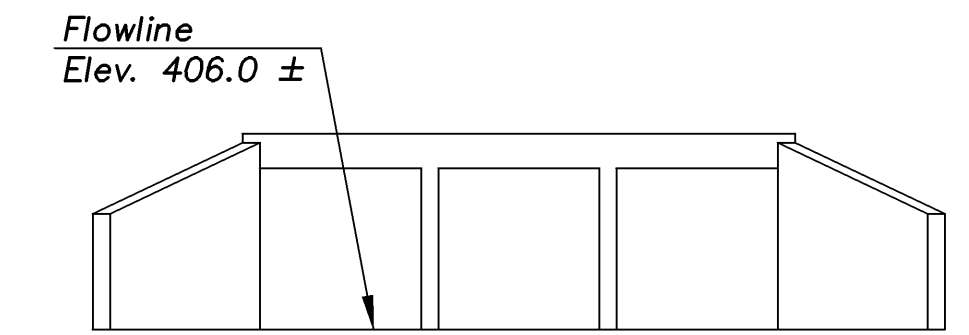

**SKETCH OF EXISTING STRUCTURE**

Triple 2.13 x 2.13 m Reinf. Concrete Box Bridge  
 Waterway Opening = 13.61 sq. m ±  
 Exist. Br. No. 54-87-30.80(146)

**DRAINAGE DATA**

Drainage Area	2.9 Km <sup>2</sup>
Design Frequency	50 Year
Design Discharge (Q Des.)	56 m <sup>3</sup> /s
Design High Water Elevation	408.00
Overtopping Elevation	409.13
(Sta. 50+00 @ Armour = Sta. 3+378.750 @ Kellogg)	
Overtopping Discharge	89 m <sup>3</sup> /s
Overtopping Frequency	> 500 Year

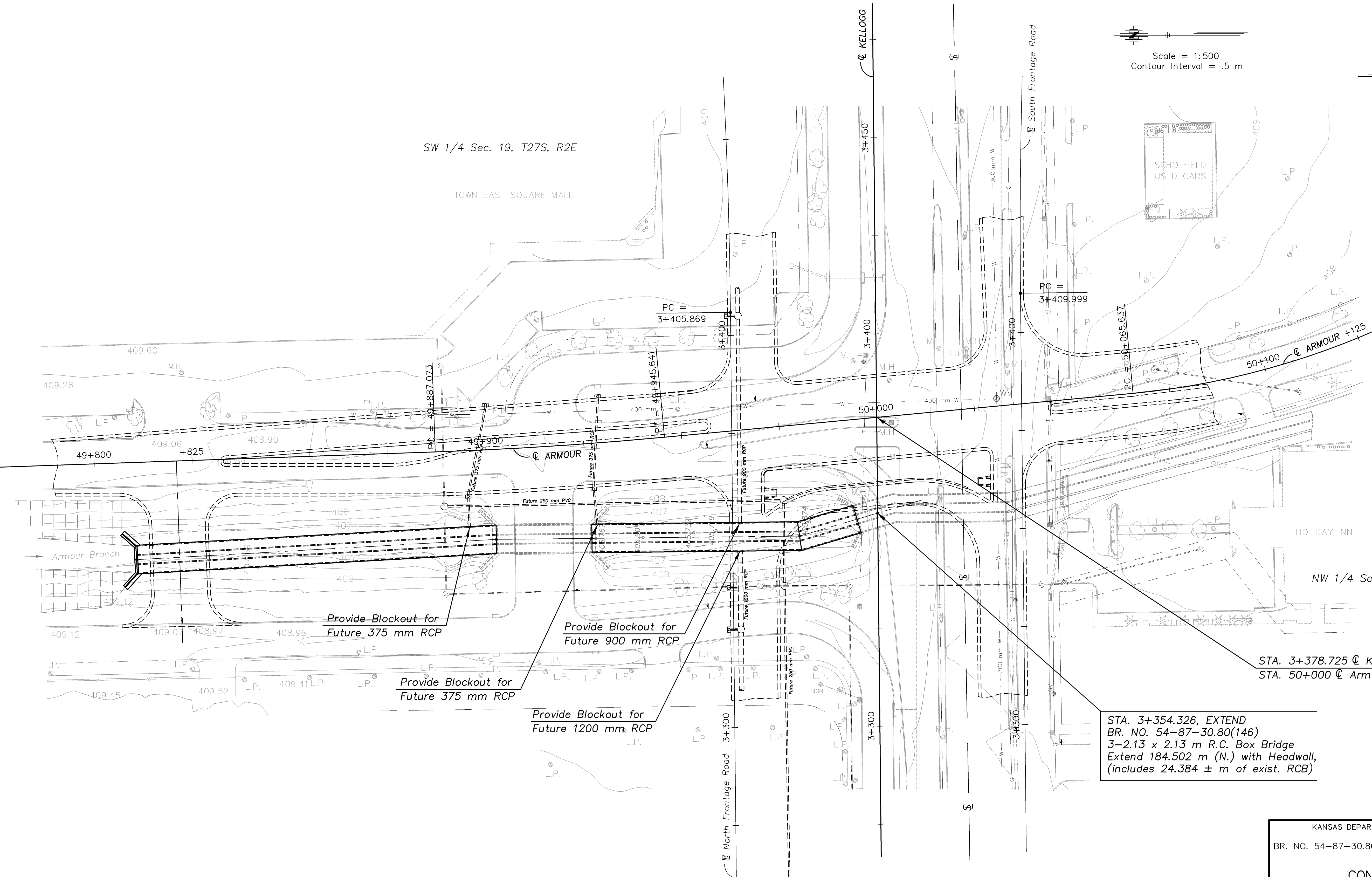
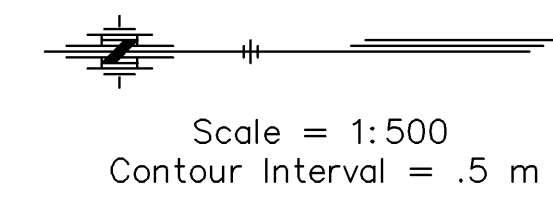

**NOTE:** Armour Road and Frontage Road Improvements are shown "For Information Only" and are not part of this Project.

STA. 3+378.725 @ Kellogg =  
 STA. 50+000 @ Armour

STA. 3+354.326, EXTEND  
 BR. NO. 54-87-30.80(146)  
 3-2.13 x 2.13 m R.C. Box Bridge  
 Extend 184.502 m (N.) with Headwall,  
 (includes 24.384 ± m of exist. RCB)

**UTILITY OWNERS**

- Telephone - U.S. Sprint
- Telephone - Southwestern Bell
- Pipe Line - J Hawk Pipe Line
- Gas - KPL
- Gas - Kansas Gas Service
- Cable TV - Cox Communication
- Water - City of Wichita
- Power - KG&E

BM #15 "□" Cut S.W. Cor. Bridge 26.3 m W. & 12.6 m S. of @ of Intersection Armour & Kellogg  
 27.6 m Rt. Armour @ Sta. 49+925.087 Elev. = 409.006

BM #16 - "□" Cut Top of Curb on the E. Curb Line of the Men's Warehouse, 35.0 m N. of @ of N. Frontage Rd.  
 42.9 m Lt @ Sta. 3+504.4 Elev. = 410.195

KANSAS DEPARTMENT OF TRANSPORTATION  
 BR. NO. 54-87-30.80(146) STA. 3+354.326  
**CONTOUR MAP**  
 KELLOGG AVENUE OVER ARMOUR BRANCH  
 Proj. No. 54-87 K-8258-02 SEDGWICK COUNTY

DESIGNED R.S.C. SCALE 1:500  
 DETAILED T.R.G. DATE  
 QUANTITIES SHEET OF

ARMOUR-RCB CONTOUR 1:500