

SBC has Poured a Concrete Cap Over the West Ex. SBC Duct Run from Sta. 0+795 to Sta. 0+855. The Contractor shall Use Caution When Excavating in the Area of the Duct Run.

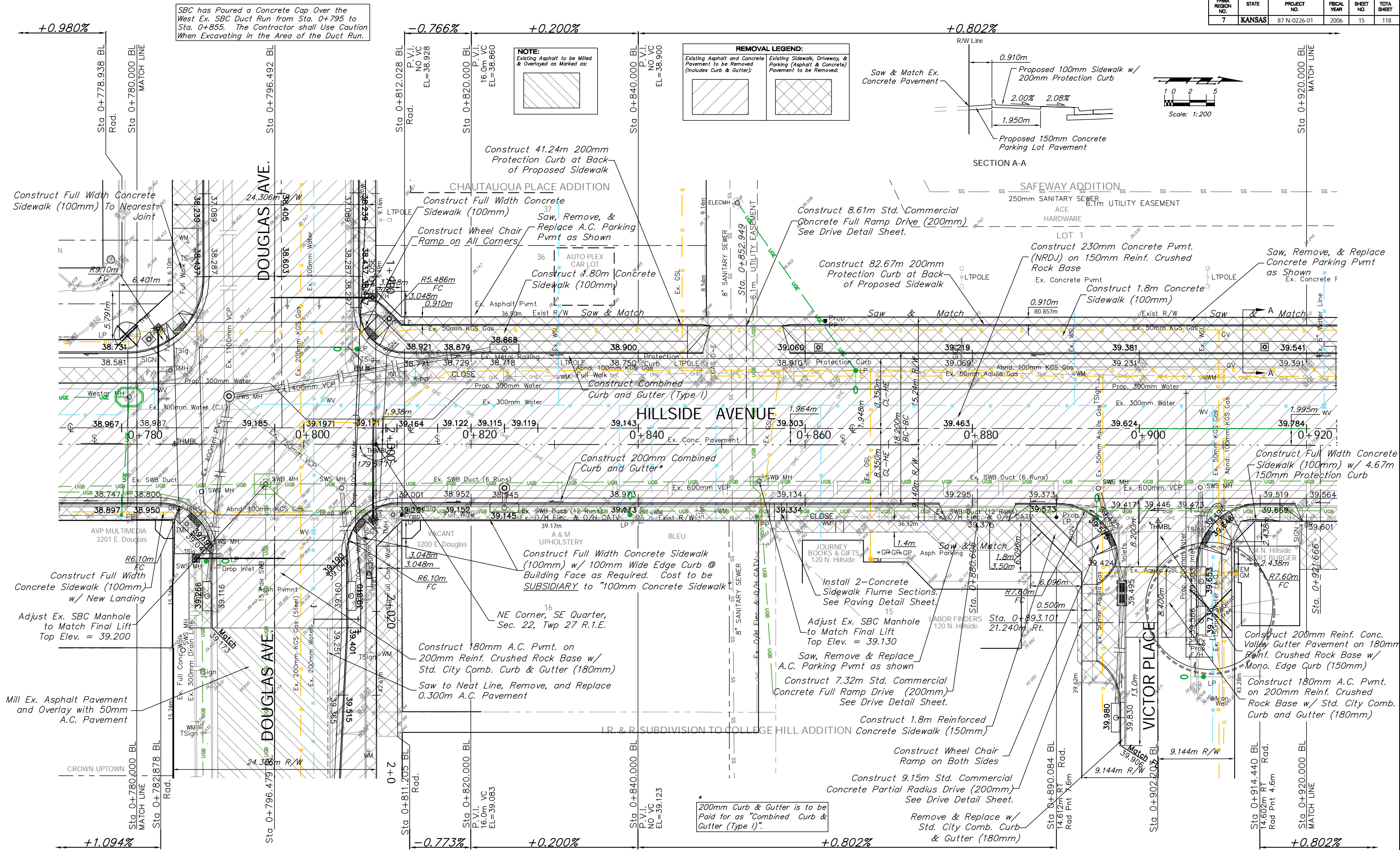

BENCHMARK
 BM #4 - "U" Top of Curb of SW Parking Lot NW Corner of Hillside & Douglas Sta. 0+807.632, 9.048m Lt. Elev. = 38.030 SI Units (124.77 City Datum)
 BM #5 - Top of Brick NW Corner of Brick Planter NW Corner Bldg. #162 SE Corner of Hillside & 1st. Sta. 0+988.819, 22.336m Rt. Elev. = 40.685 SI Units (133.48 City Datum)

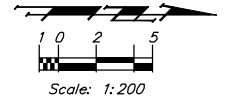
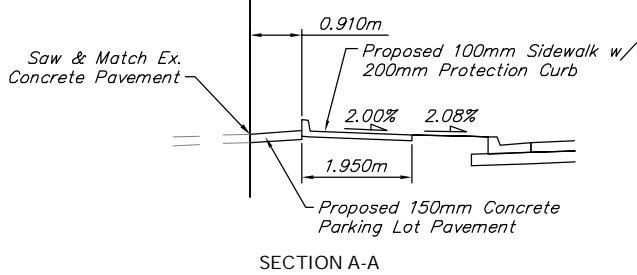
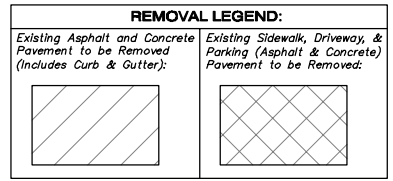
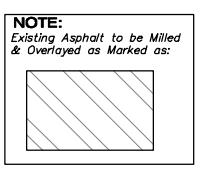
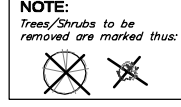

PROJECT NUMBER 472-83862	SHEET NAME PAV05	ENGINEERING DIRECTORY F:\HillsideLand\dwg
DESIGN ATD	DRAWN Sonny	APPROVED JFB
DATE May 2006	SCALE Noted	BAUGHMAN NO 01-03-E947

CAPITAL IMPROVEMENT PROJECT
HILLSIDE AVENUE PAVING
 Sta. 0+780.000 to Sta. 0+920.000

BAUGHMAN COMPANY, P.A.
 ENGINEERING, SURVEYING, & PLANNING
 316-262-7271 • 315 ELLIS • WICHITA, KANSAS 67211

SHEET 15 OF 118