

SCALE:
1:200 HORIZONTAL
1:40 VERTICAL

BENCHMARK
BM #2 - "□" SW Corner of SW Pump Isle NE
Corner of Hillside & Waterman
Sta. 0+436.899, 20.113m Rt.
Elev. = 36.268 SI Units (118.99 City Datum)

Sta. 0+234.866, Line 1 =
B.L. Sta. 0+420.000, 10.843m Rt.
Construct Gutter Inlet (Drive Inlet)(Double)
Flow Line Elev (Grate) = 35.538
(Match Grate Flow to Gutter Flow Line)

The Cost of the 2-150mm PVC Pipes and the Concrete Flume End Shall be SUBSIDIARY to the Inlet Installation.

Sta. 0+333.310, End SWS Line 1 =
B.L. Sta. 0+518.446, 11.313m Rt.
LOT 1 Construct Inlet (Double)(Type 1)
(3.454m X 1.321)
SCHAEFER ADDITION
Connect 2-150mm PVC Pipes (E)
& Grout in Place
Top Elev. = 35.938

KDOT METRIC

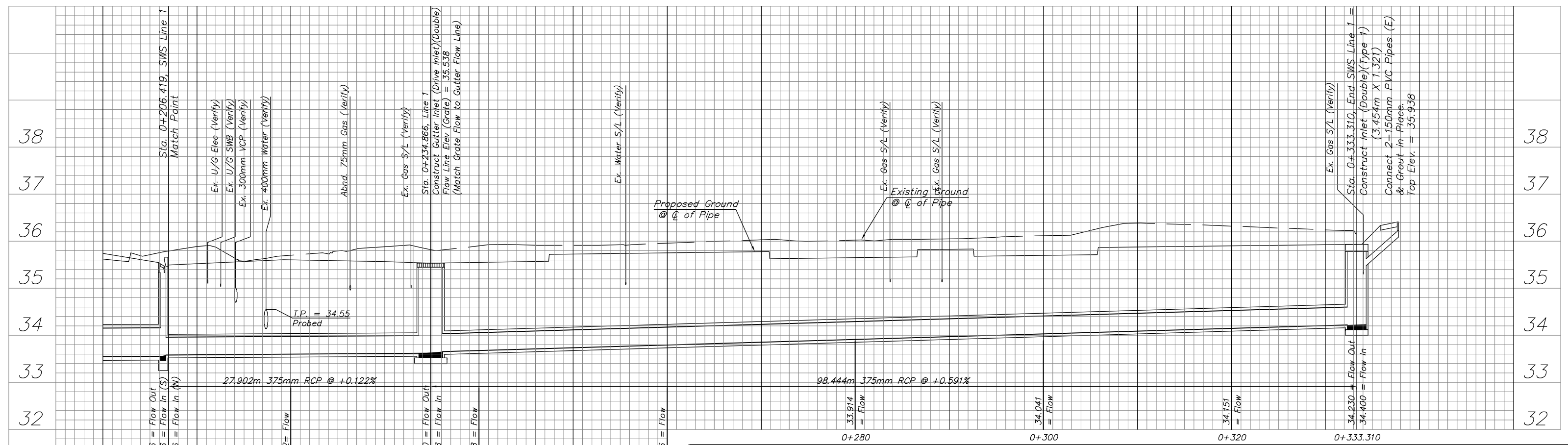

PROJECT NUMBER 472-83862		SHEET NAME SWS03		ENGINEERING DIRECTORY F:\HillsideLand\dwg	
DESIGN STAFF	DRAWN STAFF	APPROVED JFB	DATE May 2006	SCALE Noted	BAUGHMAN NO 01-03-E947

CAPITAL IMPROVEMENT PROJECT
STORM WATER SEWER PLAN & PROFILE
LINE 1
HILLSIDE AVENUE - KELLOGG TO 3RD STREET NORTH

BAUGHMAN COMPANY, P.A.
ENGINEERING, SURVEYING, & PLANNING
316-262-7271 • 315 ELLIS • WICHITA, KANSAS 67211

SHEET 33 OF 118