

**BENCHMARKS:**  
 BM #4 - 1" Top of Curb of SW Parking Lot NW Corner of Hillside & Douglas Sta. 26+49.73, 29.60 feet Lt. Elev. = 1312.17 MSL  
 BM #5 - Top of Brick NW Corner of Brick Planter NW Corner Bldg. #162 SE Corner of Hillside & 1st. Sta. 32+43.83, 73.26 feet Rt. Elev. = 1320.88 MSL

Abandon Existing 12" Water Line In Place In Accordance With City of Wichita Specs. Cap All Loose Ends. All Services Must Be Connected To New Main Prior To Abandonment.

W.L. Sta. 16+88.07, Line 1 =  
 W.L. Sta. 0+00.00, Begin Line 8 =  
 B.L. Sta. 29+70.98, 21.70' Lt.  
 Install 1-12" x 8" CMJ Tee (E)  
 Install 1-8" Anch Valve Assy. (Gate Valve)(E)  
 Valve Box Elev. = 1316.96

LINE 9  
 W.L. Sta. 17+47.04, Line 1 =  
 W.L. Sta. 0+00.00, Line 9 =  
 B.L. Sta. 30+29.97, 21.68' Lt.  
 Install 1-12" x 6" CMJ Anchored Tee (W)  
 Valve Box Elev. = 1317.39

**Note:**  
 See Water Meter Table For Service Locations.

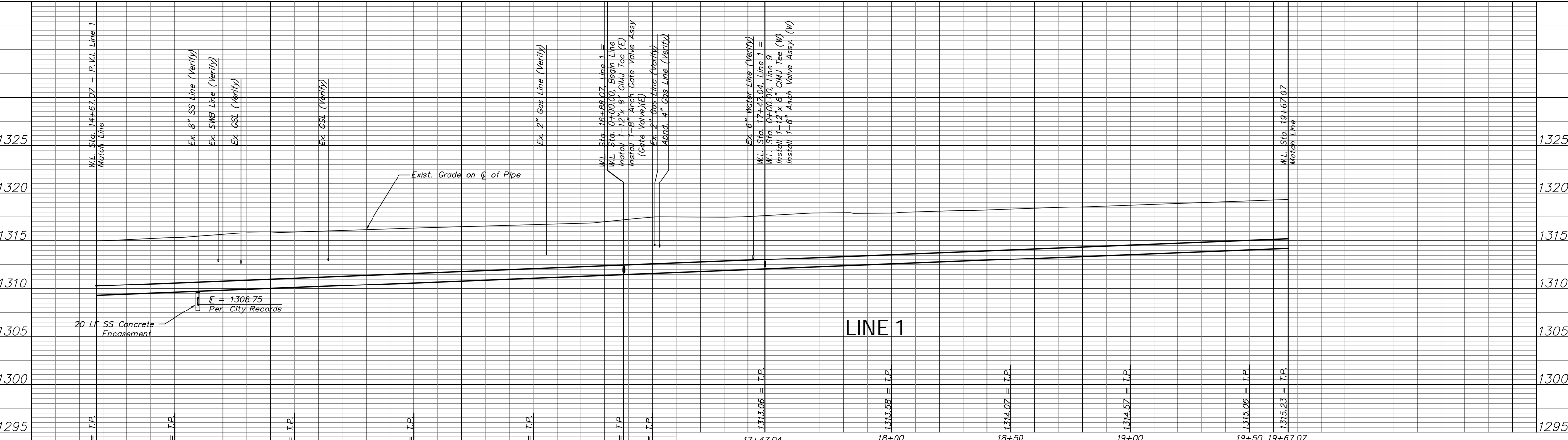
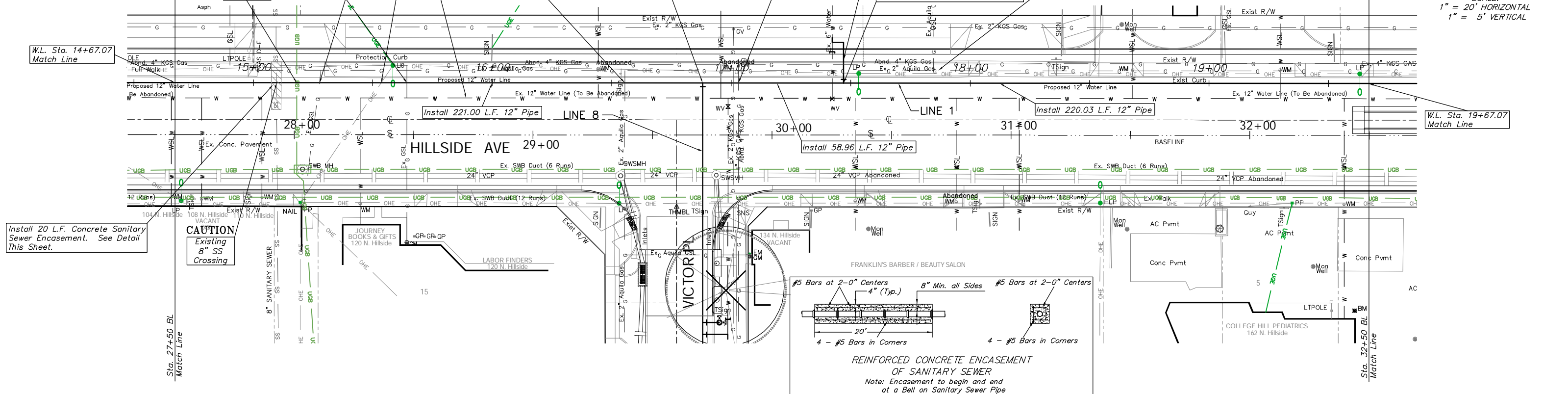
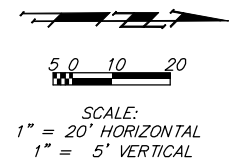

PROJECT NUMBER 448-89557		SHEET NAME H204		ENGINEERING DIRECTORY F:\Eng\Hillside\Water	
DESIGN ATD	DRAWN ATD	APPROVED JFB	DATE May 2006	SCALE NOTED	BAUGHMAN NO 01-03-E947

CAPITAL IMPROVEMENT PROJECT  
**HILLSIDE WATERLINE IMPROVEMENTS**  
 Line 1, W.L. Sta. 14+67.07 to W.L. Sta. 19+67.07  
 HILLSIDE AVENUE - KELLOGG TO 3RD STREET NORTH

<b>BAUGHMAN COMPANY, P.A.</b>	ENGINEERING, SURVEYING, & PLANNING
	316-262-7271 • 315 ELLIS • WICHITA, KANSAS 67211

SHEET OF	50 118
-------------	-----------