

Temp. A.C. Pavement (125mm) 170 Sq. m.
For Information Only

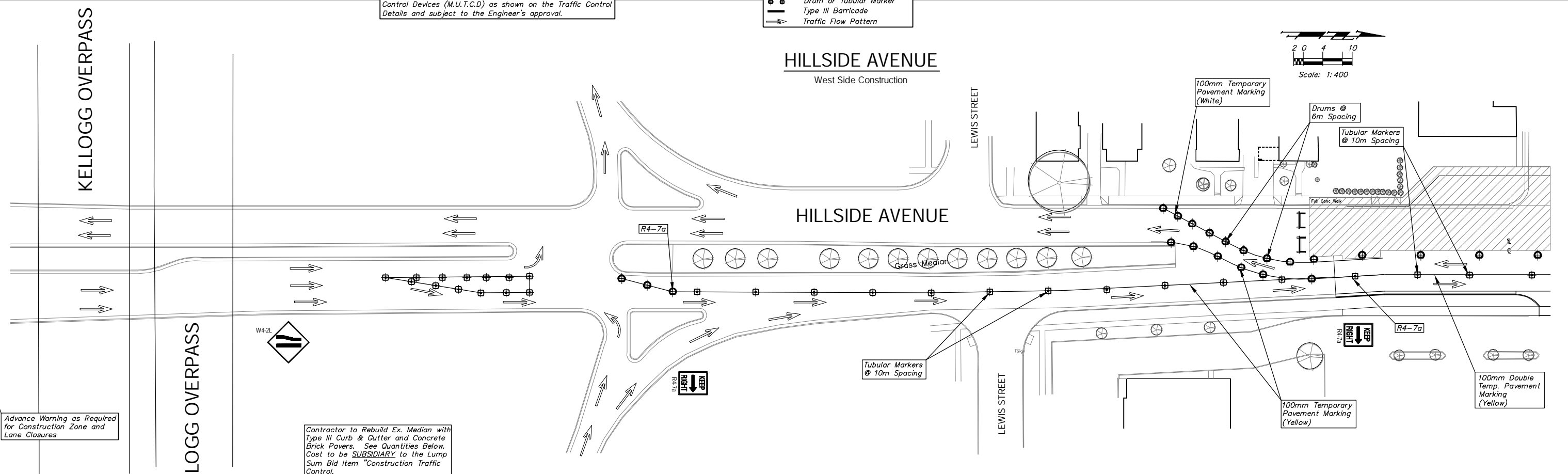
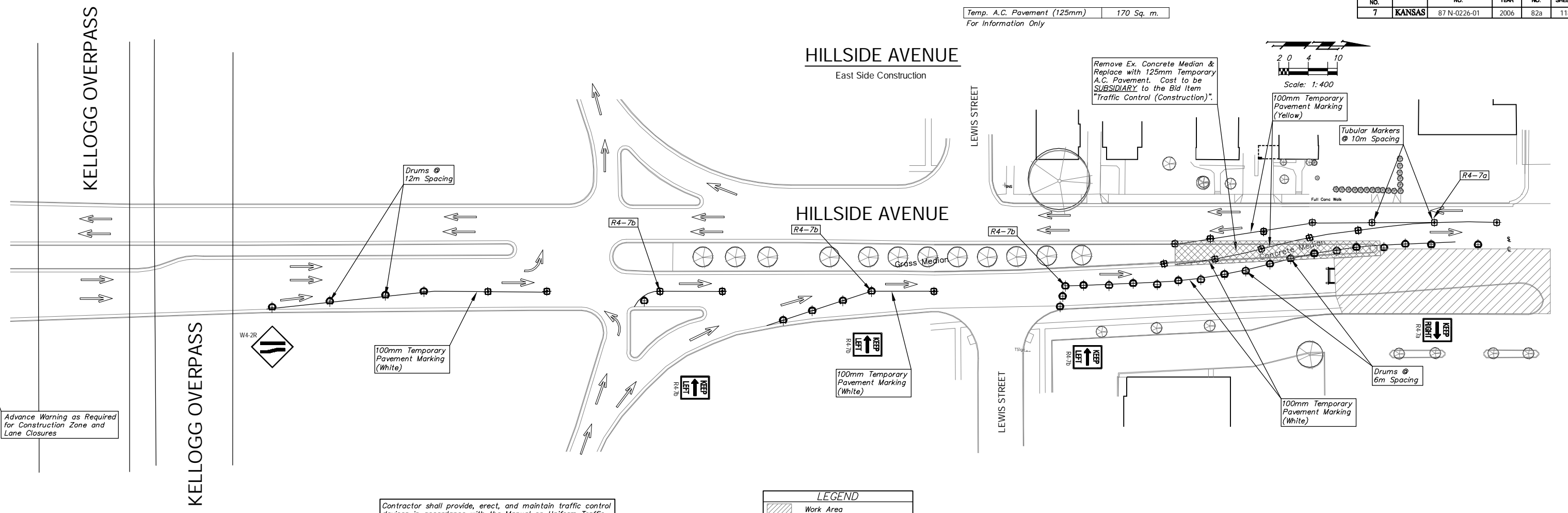

Contractor shall provide, erect, and maintain traffic control devices in accordance with the Manual on Uniform Traffic Control Devices (M.U.T.C.D.) as shown on the Traffic Control Details and subject to the Engineer's approval.

Contractor to Rebuild Ex. Median with Type III Curb & Gutter and Concrete Brick Pavers. See Quantities Below. Cost to be **SUBSIDIARY** to the Lump Sum Bid Item "Construction Traffic Control."

Type III Curb & Gutter (200mm)	60.12m
Paving Brick (60mm)	79.18 Sq. m.
For Information Only	



PROJECT NUMBER 472-83862		SHEET NAME ConSeq		ENGINEERING DIRECTORY F:\Hillside\Land\dwg	
DESIGN TPV	DRAWN TPV	APPROVED JFB	DATE May 2006	SCALE Noted	BAUGHMAN NO 01-03-E947

CAPITAL IMPROVEMENT PROJECT
HILLSIDE AVENUE PAVING
TRAFFIC CONTROL DETAILS

BAUGHMAN COMPANY, P.A.
ENGINEERING, SURVEYING, & PLANNING
315-262-7271 • 315 ELLIS • WICHITA, KANSAS 67211