

FHWA REGION NO.	STATE	PROJECT NO.	FISCAL YEAR	SHEET NO.	TOTAL SHEET
7	KANSAS	87 N-0226-01	2006	85	118

REFER TO STD. TE710SI FOR ADDITIONAL INFORMATION ON TRAFFIC CONTROL SIGNS AND SIGN SPACING.
 REFER TO STD. TE702SI FOR INFORMATION ON TAPERS AND CHANNELIZING DEVICES.
 REFER TO STD. TE700SI FOR LENGTH OF BUFFER SPACE.

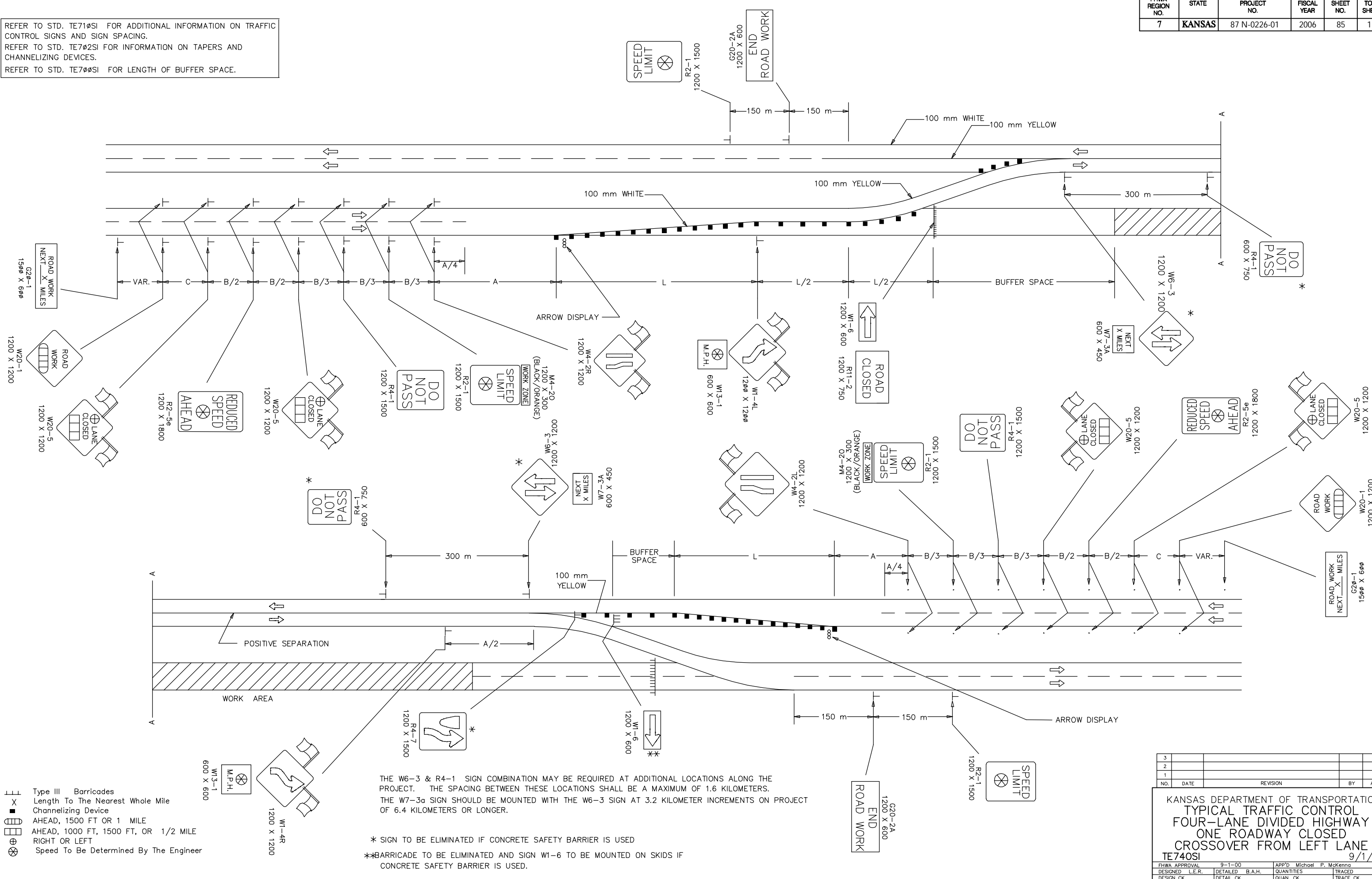

- TTT Type III Barricades
- X Length To The Nearest Whole Mile
- Channelizing Device
- ▨ AHEAD, 1500 FT OR 1 MILE
- ▩ AHEAD, 1000 FT, 1500 FT, OR 1/2 MILE
- ⊕ RIGHT OR LEFT
- ⊗ Speed To Be Determined By The Engineer

THE W6-3 & R4-1 SIGN COMBINATION MAY BE REQUIRED AT ADDITIONAL LOCATIONS ALONG THE PROJECT. THE SPACING BETWEEN THESE LOCATIONS SHALL BE A MAXIMUM OF 1.6 KILOMETERS.
 THE W7-3a SIGN SHOULD BE MOUNTED WITH THE W6-3 SIGN AT 3.2 KILOMETER INCREMENTS ON PROJECT OF 6.4 KILOMETERS OR LONGER.

* SIGN TO BE ELIMINATED IF CONCRETE SAFETY BARRIER IS USED
 **BARRICADE TO BE ELIMINATED AND SIGN W1-6 TO BE MOUNTED ON SKIDS IF CONCRETE SAFETY BARRIER IS USED.

3					
2					
1					
NO.	DATE	REVISION	BY	APP'D	
KANSAS DEPARTMENT OF TRANSPORTATION TYPICAL TRAFFIC CONTROL FOUR-LANE DIVIDED HIGHWAY ONE ROADWAY CLOSED CROSOVER FROM LEFT LANE TE740SI 9/1/00					
FHWA APPROVAL	9-1-00	APP'D	Michael P. McKenna		
DESIGNED	L.E.R.	DETAILED	B.A.H.	QUANTITIES	TRACED
DESIGN CK.	DETAIL CK.	QUAN. CK.	TRACE CK.		