

HORIZONTAL AND VERTICAL CONTROL PROVIDED BY JOHNSON AND ASSOCIATES, INC. +9999

Number	Northing	Eastng	Elevation	Description
1	10000.000	10000.000	1296.88	Cut X
3	9630.128	10000.249	1297.31	Cut X
4	9630.074	9940.287	-	Cut X
5	9630.048	9901.825	-	#4 Mid Kansas Cap
6	10069.918	10000.047	-	Cut X
7	10069.888	10770.251	-	2" Open End Iron Pipe
8	10034.359	10770.139	-	Metal in Thimble
9	10034.302	11072.766	-	Conc. Nail in Shiner
10	10034.232	11142.779	-	#4 Bar in Thimble
22	9095.988	9970.311	-	1.5" Open End Iron Pipe in Thimble
24	9250.970	9940.304	-	#6 Bar
28	8652.805	10011.332	-	Cut X
29	8965.939	9999.944	-	1" Open End Iron Pipe
30	9065.937	10000.073	-	1" Open End Iron Pipe
31	9065.293	10300.241	-	1.5" Open End Iron Pipe
32	9125.862	10000.209	-	1" Open End Iron Pipe
33	9380.228	10164.195	-	1" Open End Iron Pipe
34	9175.526	10164.369	-	1" Open End Iron Pipe
35	9125.534	10164.378	-	1" Open End Iron Pipe
36	9095.277	10300.330	-	1.5" Open End Iron Pipe in Thimble
37	9095.986	10340.422	-	PK Nail
38	9095.419	10380.449	-	1.5" Open End Iron Pipe in Thimble
39	9110.933	10379.136	-	Cut X
40	9130.423	10380.603	-	1" Open End Iron Pipe
41	9130.266	10522.259	-	1" Open End Iron Pipe
42	9095.086	10770.317	-	#4 Mid Kansas Cap in Thimble
43	9094.803	11072.393	-	Cut X
44	9094.686	11142.684	-	#4 Mid Kansas Cap in Thimble
45	9329.722	10770.296	-	Cut V
46	9180.028	10770.289	-	#4 Mid Kansas Cap
47	9179.968	10874.938	-	#4 LS#59 Cap
48	9241.681	10909.901	-	Cut X
49	9279.580	10926.043	-	1.5" Open End Iron Pipe
50	9129.930	10874.922	-	#4 LS#59 Cap
51	9129.957	10909.951	-	#4 MKEC Cap
52	9129.834	10925.862	-	#4 MKEC Cap
53	9094.192	11442.357	-	Cut X
54	9094.378	11517.419	-	1" Open End Iron Pipe in Thimble
55	9094.342	11107.320	-	Cut X
56	8760.528	11472.074	-	#5 MKEC Cap
57	10037.237	11517.333	-	Thimble
58	9014.251	10288.295	-	1.5" Open End Iron Pipe
59	8922.487	10380.160	-	2" Open End Iron Pipe
60	9230.287	10380.491	-	1" Open End Iron Pipe
61	9355.132	10380.248	-	1" Open End Iron Pipe
62	8653.340	10286.011	-	1" Closed End Iron Pipe
63	8576.699	10302.052	-	#3 Bar
75	9404.578	10770.162	-	Cut X
76	9529.323	10769.115	-	Cut X
77	9564.334	10770.096	-	#4 Mid Kansas Cap in Thimble
78	9599.163	11072.777	-	Cut X
79	9564.178	11142.742	-	1.75" Bar in Conc. in Thimble
81	9775.114	10299.958	-	1" Open End Iron Pipe
82	9329.951	10538.224	-	#6 Bar
83	9279.531	11072.757	-	#4 Baughman Cap
84	9329.273	11072.455	-	1.5" Open End Iron Pipe
85	9329.640	10909.880	-	#4 MKEC Cap
86	9329.566	10925.984	-	1.5" Open End Iron Pipe
87	8668.255	10373.982	-	#3 Broken Cap
88	9689.413	10909.740	-	Cut X
100	9769.294	10362.423	1297.34	BM Cut X
101	10000.034	10769.525	1298.80	BM Cut X
106	9258.327	10133.787	1296.41	BM Mag Nail in parking stripe
108	9240.928	10303.080	1297.92	BM Cut X
109	9334.438	10521.089	1298.47	BM Mag Nail
114	10000.034	10769.525	1298.80	BM
118	8736.769	10258.653	1297.08	BM Cut X
124	8788.955	10489.048	1302.34	#3 Bar with J&A control cap
202	10072.836	10687.890	1298.72	BM Cut X
208	9124.353	9997.984	1295.06	BM Cut X
209	9065.745	10355.640	1297.73	BM Cut X
210	9541.655	10373.762	-	Cut X
212	8660.201	10718.888	-	60d Nail control point
213	9597.261	10670.795	-	Cut X
214	8756.533	11246.260	-	60d Nail control point
218	8988.040	9673.154	1296.47	BM Cut X
219	9294.578	9679.369	1299.55	BM Cut X
220	9112.168	9680.883	1296.46	BM Cut X
222	8812.048	9934.875	-	60d Nail control point

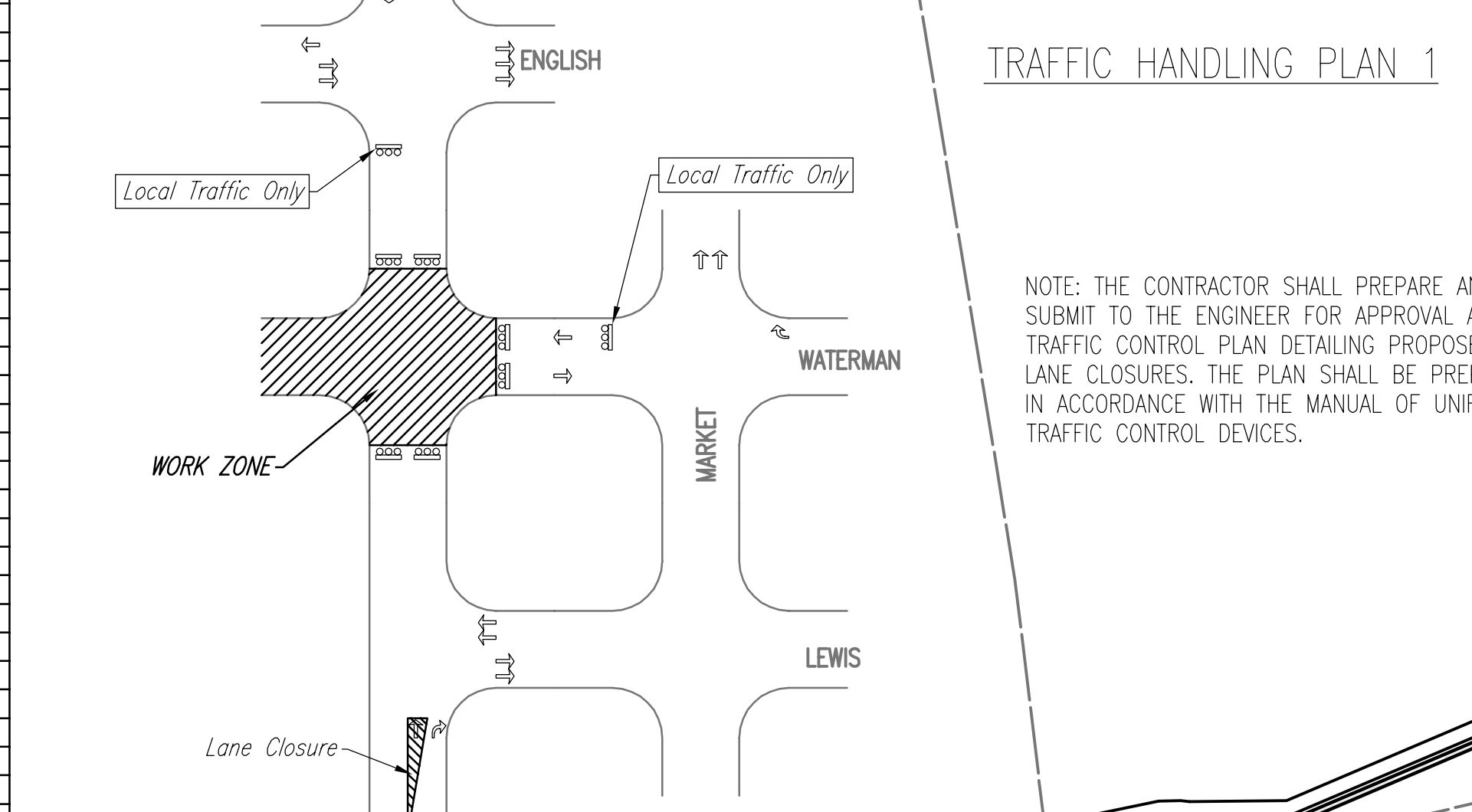

NOTE: THE CONTRACTOR SHALL PREPARE AND SUBMIT TO THE ENGINEER FOR APPROVAL A TRAFFIC CONTROL PLAN DETAILING PROPOSED LANE CLOSURES. THE PLAN SHALL BE PREPARED IN ACCORDANCE WITH THE MANUAL OF UNIFORM TRAFFIC CONTROL DEVICES.

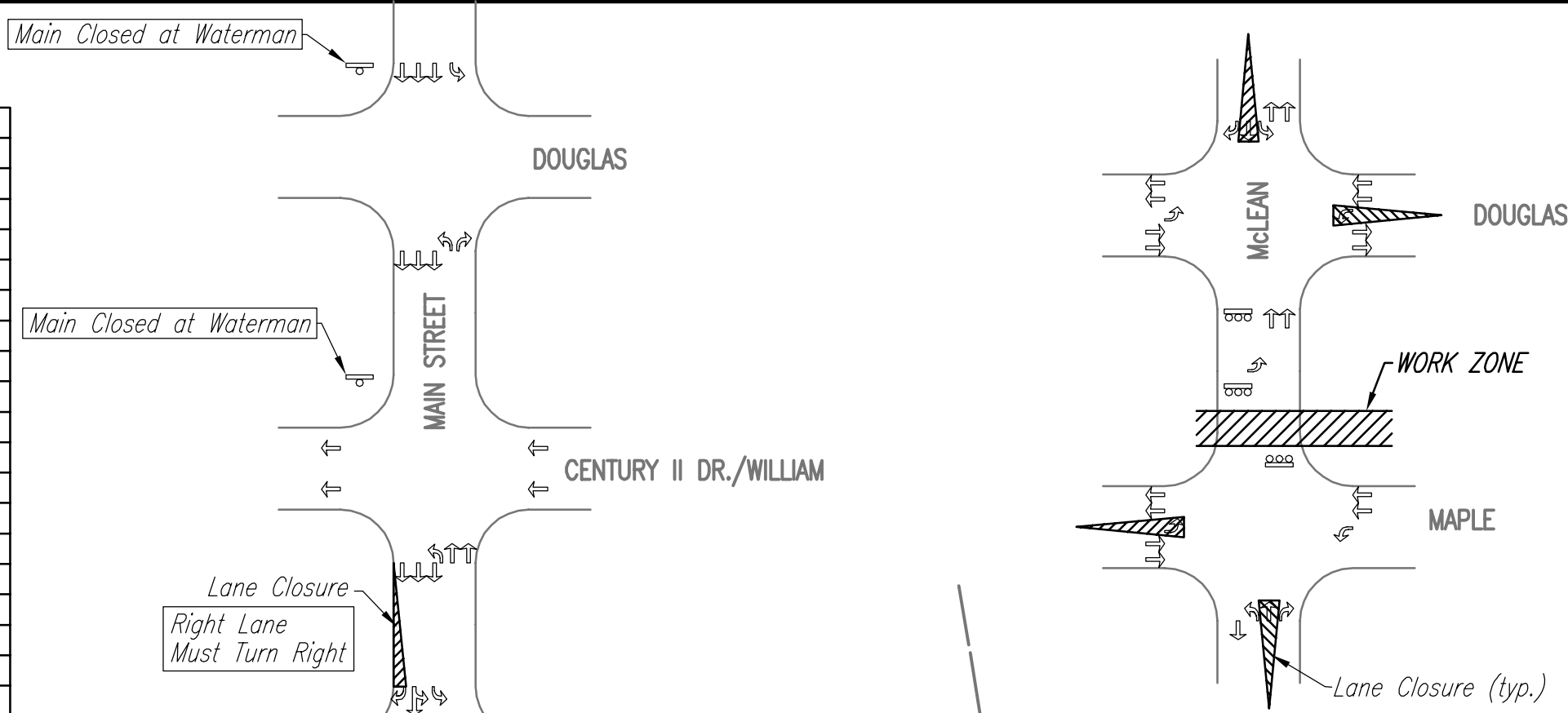