

N-10,010.7513, E-10,651.0539
 WL 1, Sta. 27+64.08
 1-Purging Hydrant Assembly
 See detail sheet no. 36

CAUTION!!!
 15" RCP Storm Sewer
 to be abandoned

CAUTION!!!
 2"x2" Electrical Duct Bank**
 Contractor shall support in place
 and protect from damage.
 Coordinate with Westar Energy
 Mr. Ray Lara - Distribution Supervisor
 at 261-6630.
 (Provide at least 2 weeks notice)
 Costs if any to be borne
 by Westar Energy.

N-10,033.0699, E-10,761.1191
 WL 1, Sta. 28+76.39
 1-48" RJ 11 1/4" Bend
 Defl.= 11" 31' 20"

N-10,033.0507, E-10,779.7302
 WL 1, Sta. 28+95.00***
 Connect to existing 16" water main
 See detail sheet no. 35

N-10,033.0100, E-10,819.0602
 WL 1, Sta. 29+34.33
 1-48" Line Valve Assembly
 (Butterfly Valve)
 Top Valve Box EL.= match existing
 1-48" RJ Cap (E)

N-10,009.7576, E-10,646.1537
 WL 1, Sta. 27+59.08
 48" RJ 11 1/4" Bend

CAUTION !!!
 Existing 16" Waterline

CAUTION !!!
 Existing 8" Waterline

Sta. 0+00.00
 Existing 16" Waterline*
 Cut In 1-16" CI CL MJ 45° Bend
 Defl.= 45° 00' 00"

Sta. 0+50.72
 Existing 16" Waterline*
 Cut In 1-16" CI CL MJ 45° Bend
 Defl.= 45° 13' 11"

** PRIOR TO BEGINNING CONSTRUCTION, THE CONTRACTOR SHALL EXCAVATE THE EXISTING ELECTRICAL DUCT BANK TO VERIFY HORIZONTAL AND VERTICAL LOCATION. THE CONTRACTOR SHALL REPORT HIS FINDINGS TO THE ENGINEER SO THAT ANY NECESSARY PLAN MODIFICATIONS MAY BE MADE. ANY ADDITIONAL LABOR OR MATERIALS NECESSARY SHALL BE CONSIDERED SUBSIDIARY TO THE PROJECT.

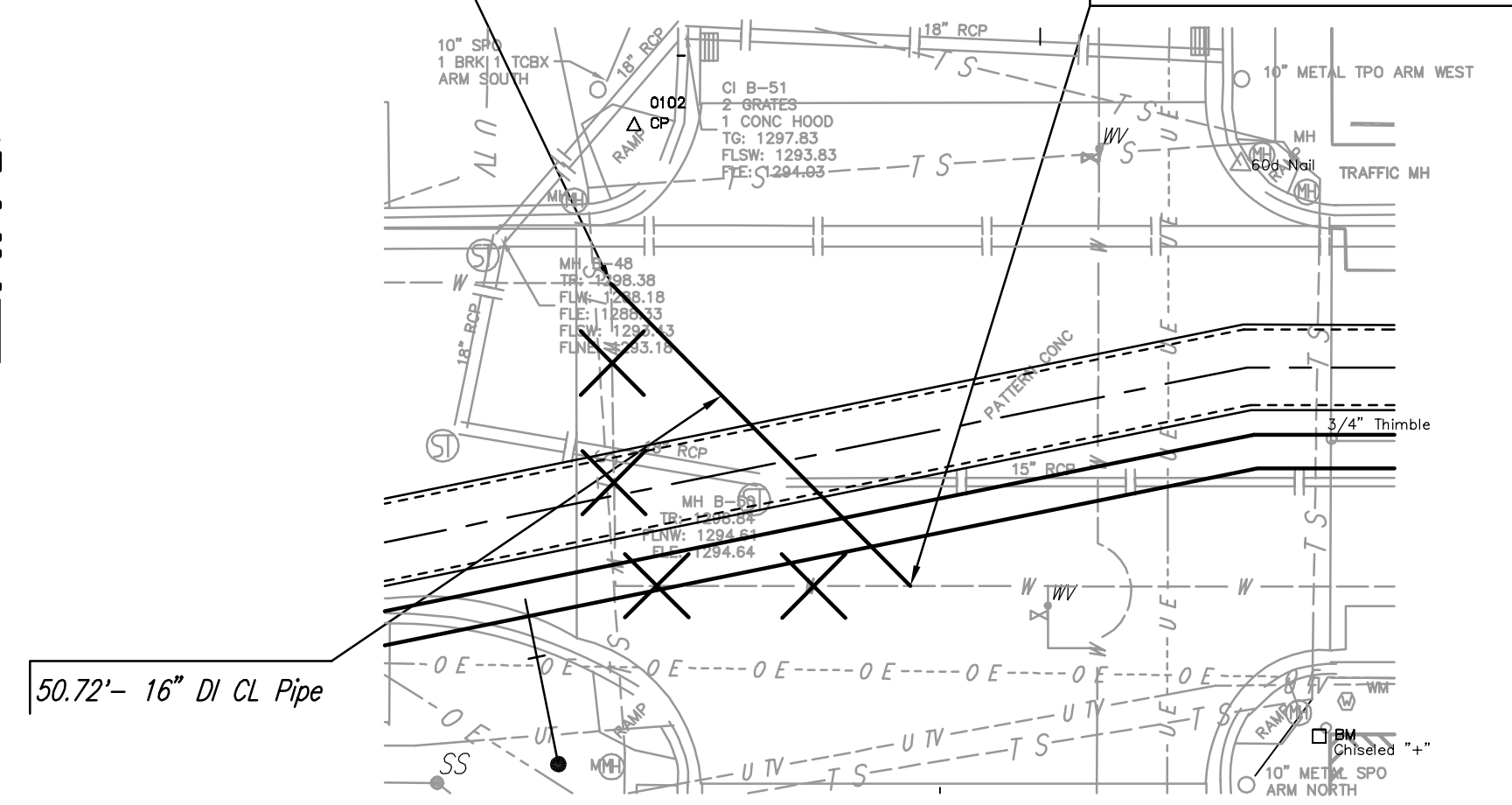
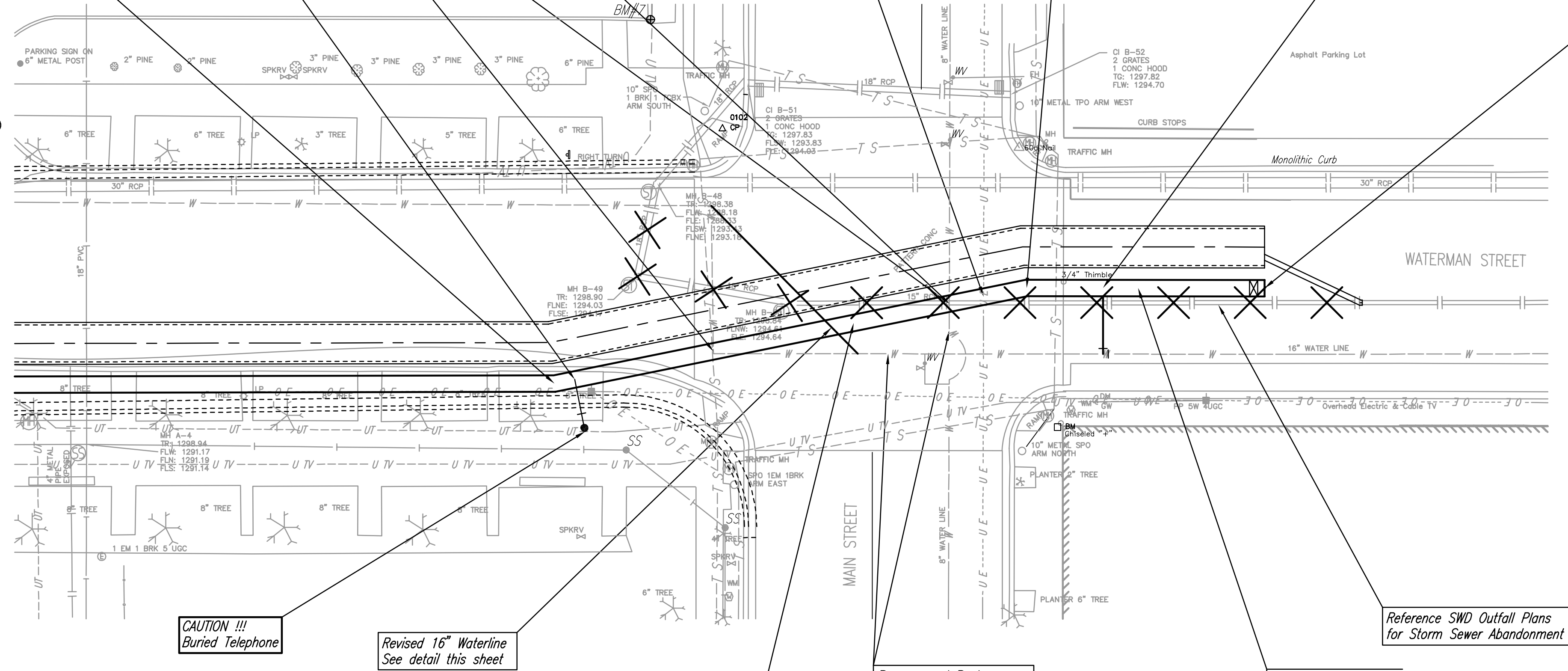

EXISTING 16" WATERLINE

CAUTION !!!
 Buried Telephone

Revised 16" Waterline
 See detail this sheet

Remove and Replace Existing Waterline* as necessary for construction

Reference SWD Outfall Plans for Storm Sewer Abandonment

X = PIPE REMOVAL

* PRIOR TO BEGINNING CONSTRUCTION, THE CONTRACTOR SHALL EXCAVATE THE EXISTING WATERLINE TO VERIFY PIPE SIZE, TYPE, FITTINGS, AND HORIZONTAL AND VERTICAL LOCATION. THE CONTRACTOR SHALL REPORT HIS FINDINGS TO THE ENGINEER SO THAT ANY NECESSARY PLAN MODIFICATIONS MAY BE MADE. ANY ADDITIONAL LABOR OR MATERIALS NECESSARY SHALL BE CONSIDERED SUBSIDIARY TO THE PROJECT.

***CONTRACTOR SHALL INSTALL VALVE ON EXISTING 16" WATERLINE PRIOR TO RELOCATING EXISTING WATERLINE ACROSS MAIN STREET

Unless noted otherwise, elevations shown are top of pipe

WATERLINE NO. 1

EXISTING 16" WATERLINE

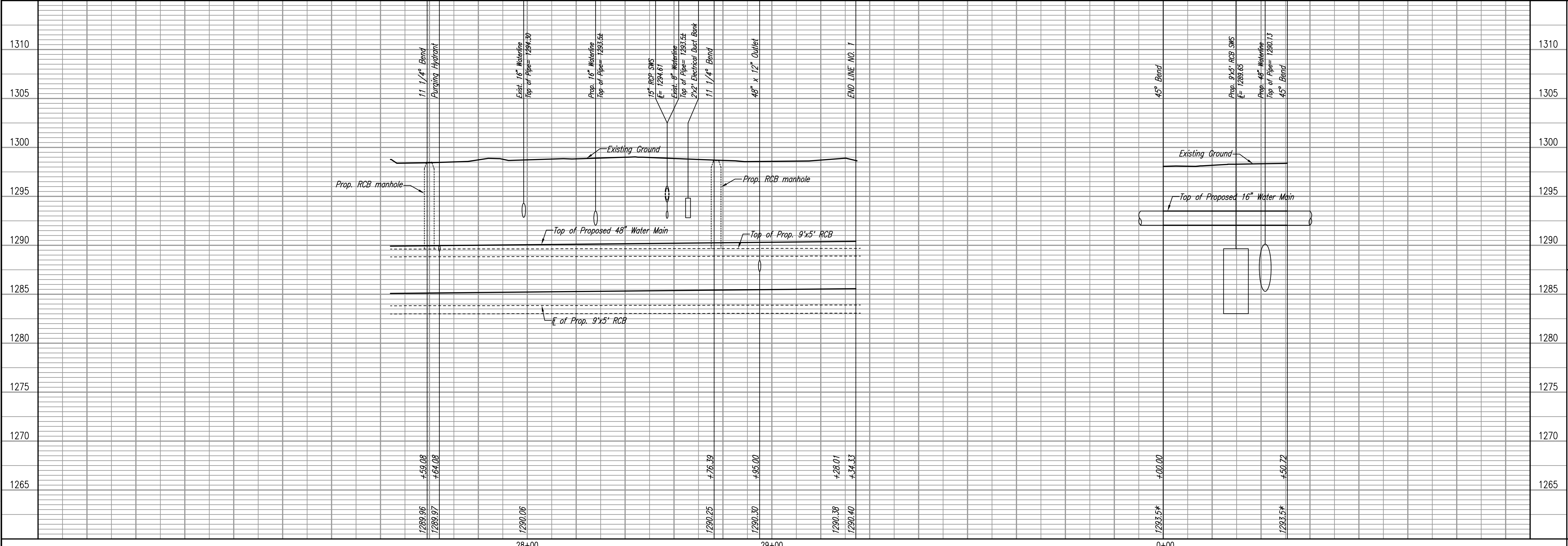

PLAN	CHECKED	CHECKED
DATE		

PROFILE	CHECKED	CHECKED
DATE		

Saved: 05-26-2006 3:05:10 PM by JCA
 Plot Scale: 1/2" = 10'-0" (05-26-2006 3:07:33 PM by JCA)
 C:\PROJECTS\2005\0529\001\Phase1\2005-05-26 to COM\DWG\33-WL Line 01

Professional Engineering Consultants, P.A.
 303 S. TOPEKA • WICHITA, KANSAS 67202
 316-262-2691 • FAX 316-262-3003

Job No. 35-05787-001-042
 Date March 2006

Designed By MDK
 Drawn By JCA

WATERMAIN PUBLIC IMPROVEMENTS - PHASE 2 PACKAGE 2
 (SOUTHEAST 48" WATERLINE - PHASE 1A)

WATERLINE NO. 1
 JAMES L. ARNOVA, P.E. - CITY ENGINEER
 CITY OF WICHITA PROJECT NO. 448-00182

Sheet 33 of 47