

F.H.W.A. REGION NO.	STATE	PROJECT NO.	YEAR	SHEET NO.	TOTAL SHEETS
7	KANSAS	54-87 K-8258-08	2005	12	223

DATE	BY

REFERENCE NOTED	REFERENCE CHECKED

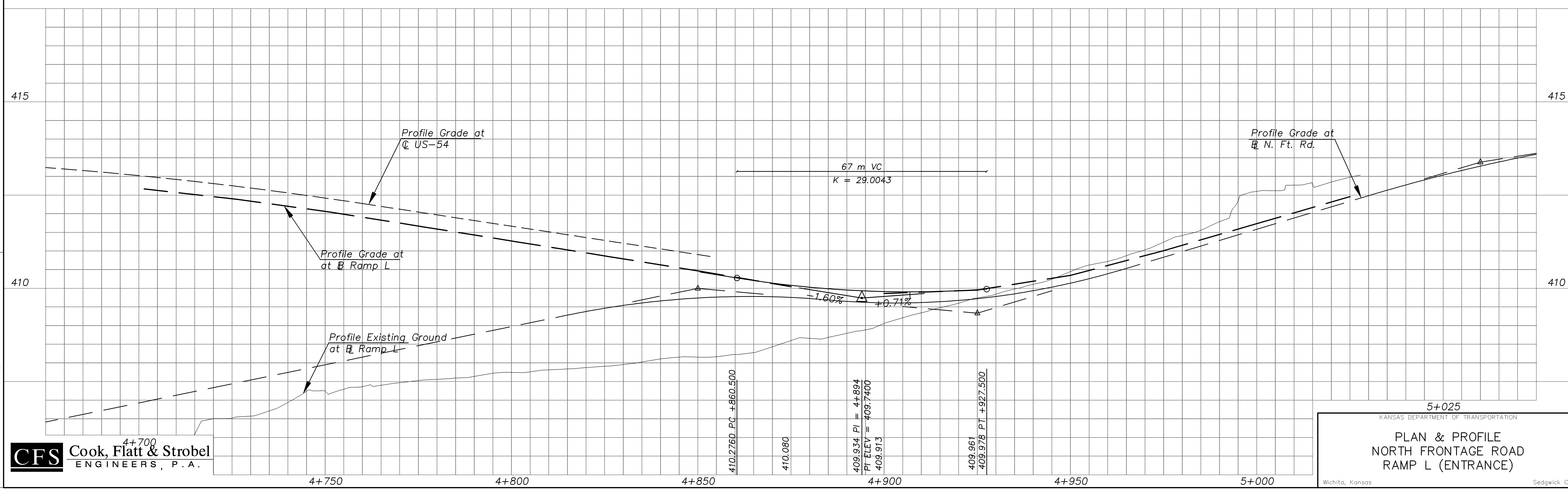
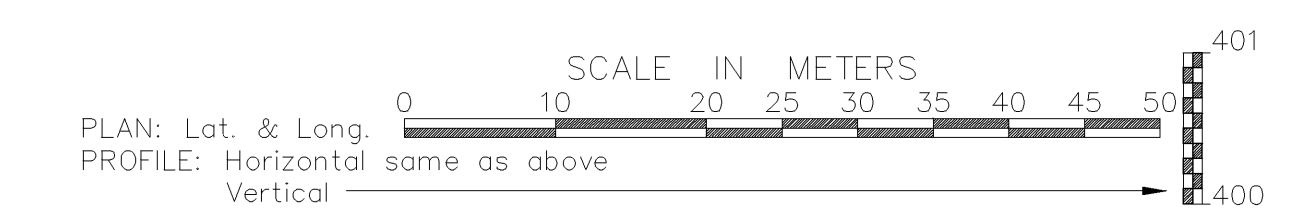
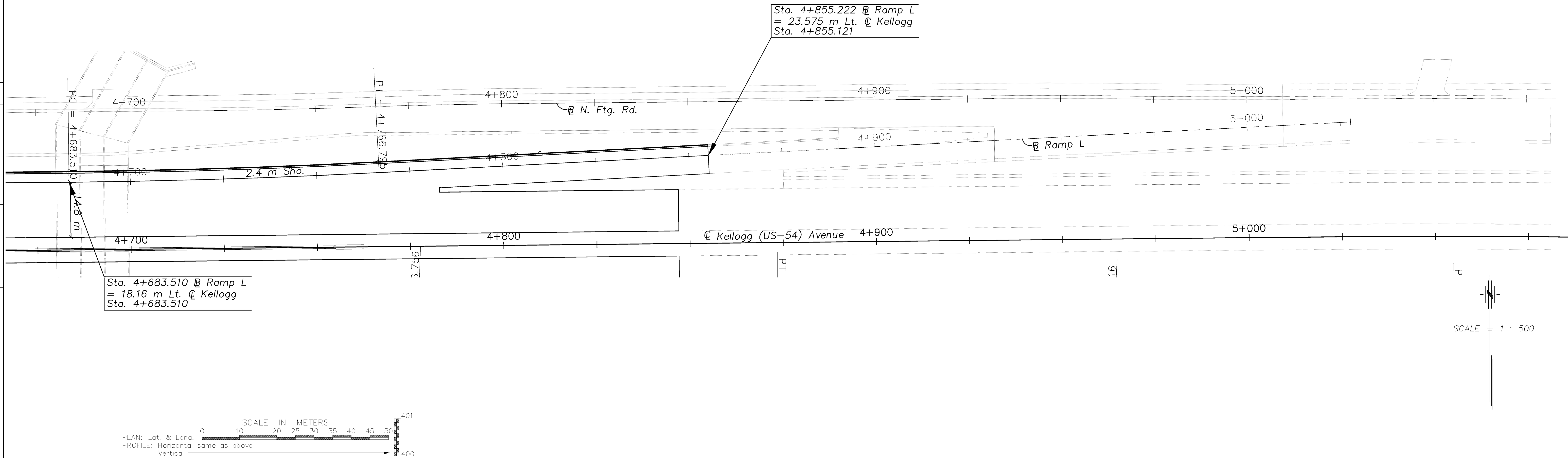

**CFS** Cook, Flatt & Strobel  
 ENGINEERS, P.A.

5+025  
 KANSAS DEPARTMENT OF TRANSPORTATION  
**PLAN & PROFILE**  
 NORTH FRONTAGE ROAD  
 RAMP L (ENTRANCE)  
 Wichita, Kansas Sedgwick Co.