

STATE	PROJECT NO.	YEAR	SHEET NO.	TOTAL SHEETS
KANSAS	54-87 K-8258-08	2005	123	223

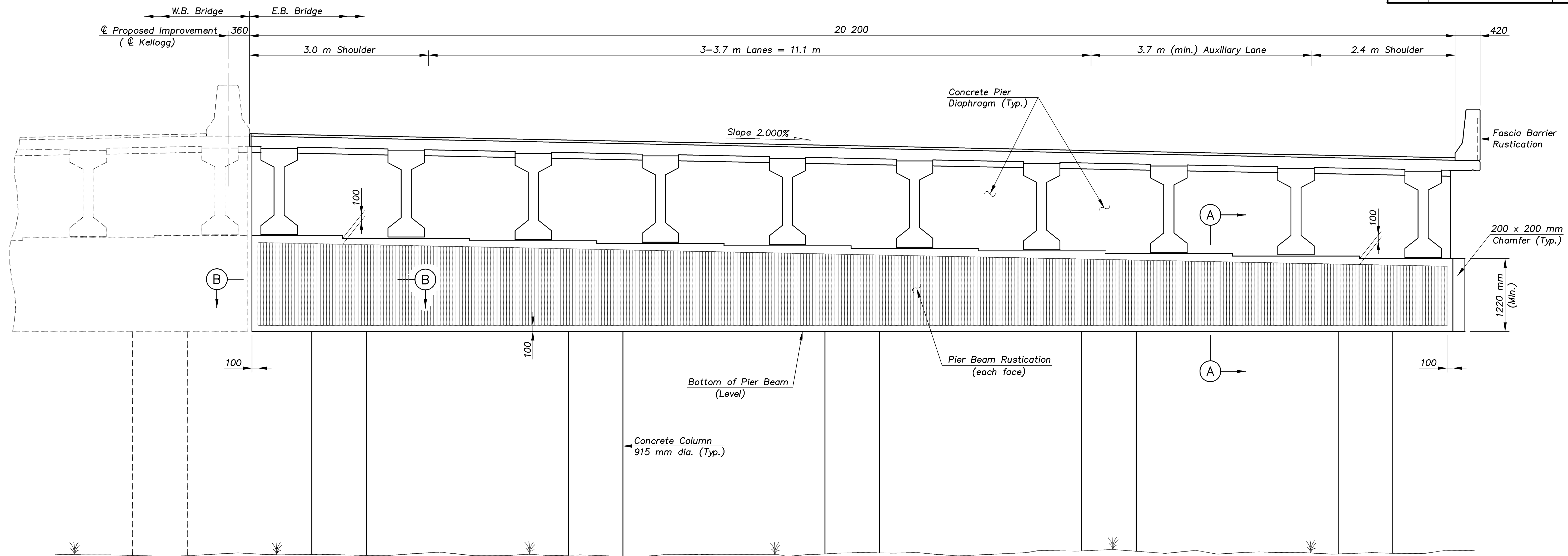

TYPICAL ELEVATION VIEW OF PIER
(E.B. Bridge shown, W.B. Bridge similar)

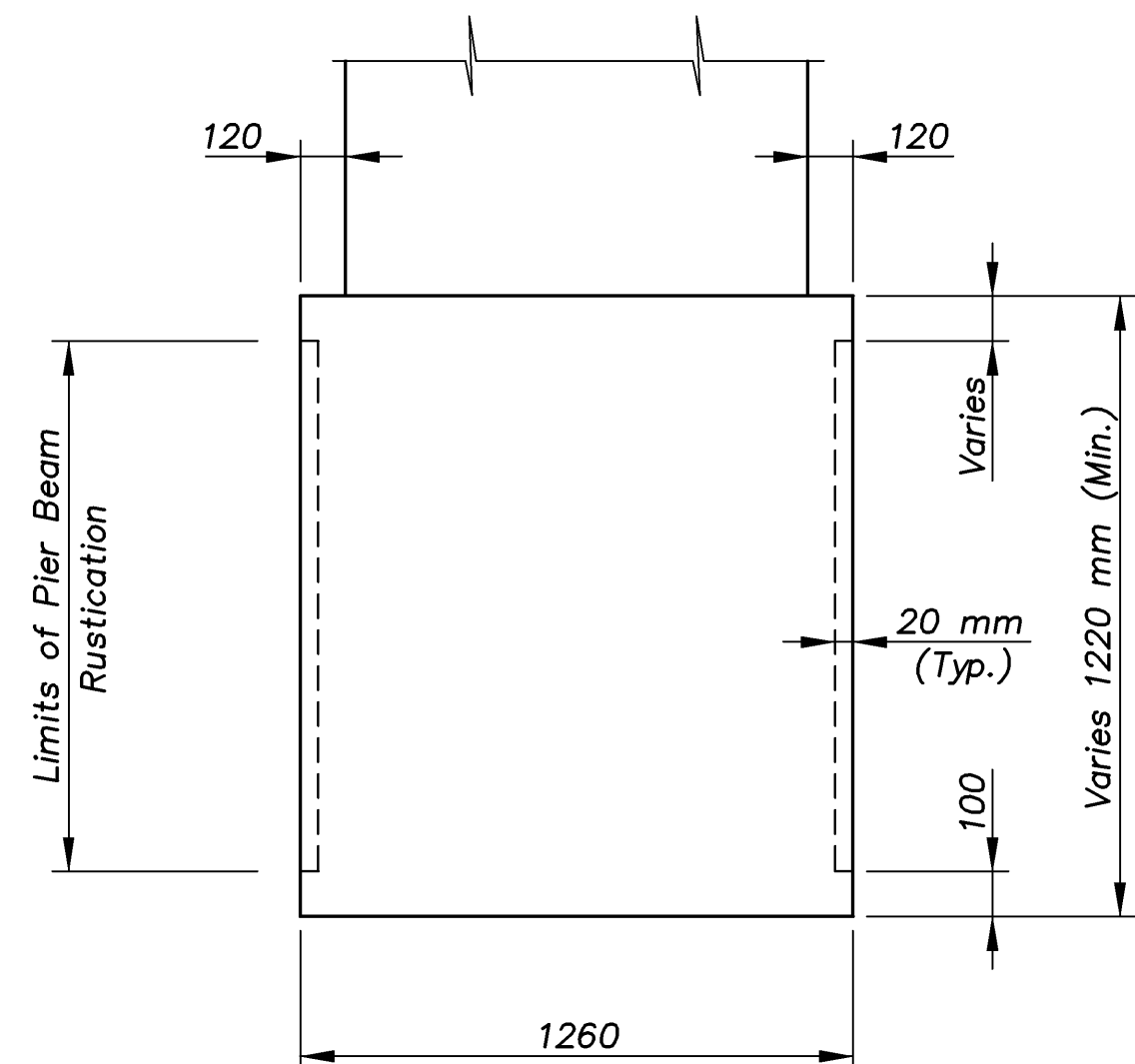

SECTION A-A

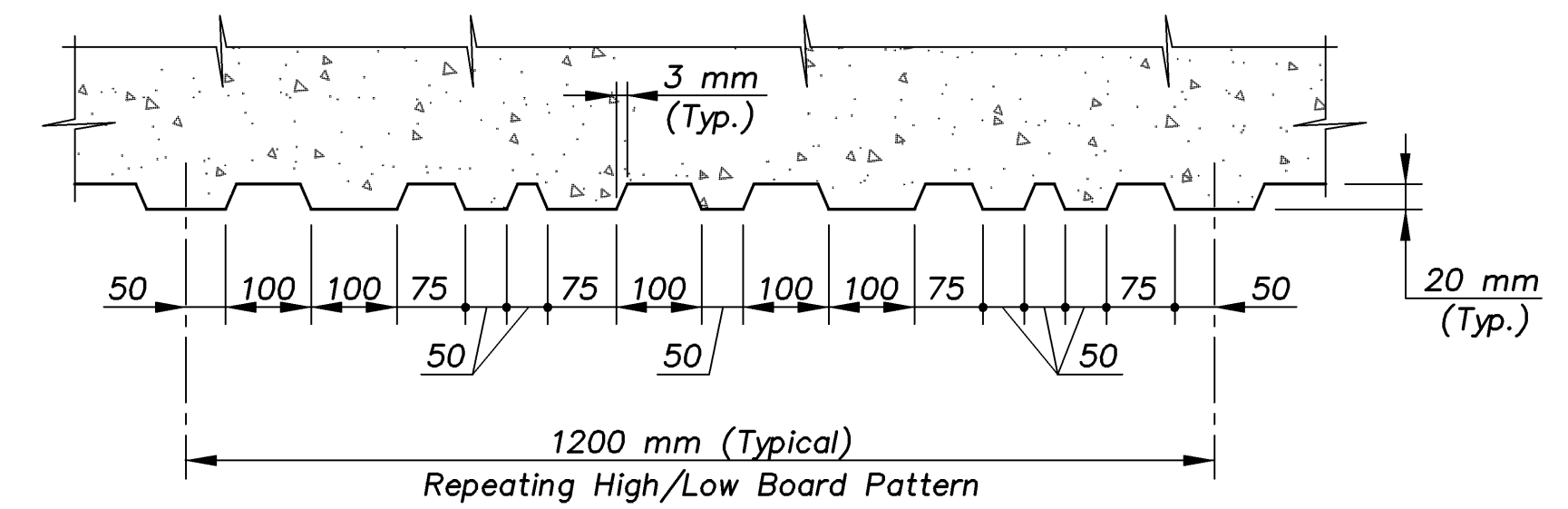

SECTION B-B

KANSAS DEPARTMENT OF TRANSPORTATION
BR. NO. 54-87-31.55(704) W.B. STA. 4+575.138
BR. NO. 54-87-31.56(705) E.B.

PIER RUSTICATION DETAILS

KELLOGG AVENUE OVER EASTERN

Proj. No. 54-87 K-8258-08 SEDGWICK COUNTY



Cook, Flatt & Strobel
ENGINEERS, P. A.

DESIGNED	R.S.C.	SCALE	Varies
DETAILED	T.R.G.	DATE	
QUANTITIES	T.R.G.	SHEET	45 OF 47

EASTERN/RUSTICATION 1:100