

GENERAL SEQUENCE OF CONSTRUCTION:

STAGE 3

- A. Shift westbound and eastbound Kellogg to the new roadway.
- B. Complete construction of Ramp I and removal of temporary asphalt.

STATE	PROJECT NO.	YEAR	SHEET NO.	TOTAL SHEETS
KANSAS	54-87 K-8258-08	2005	202	233

DATE	BY

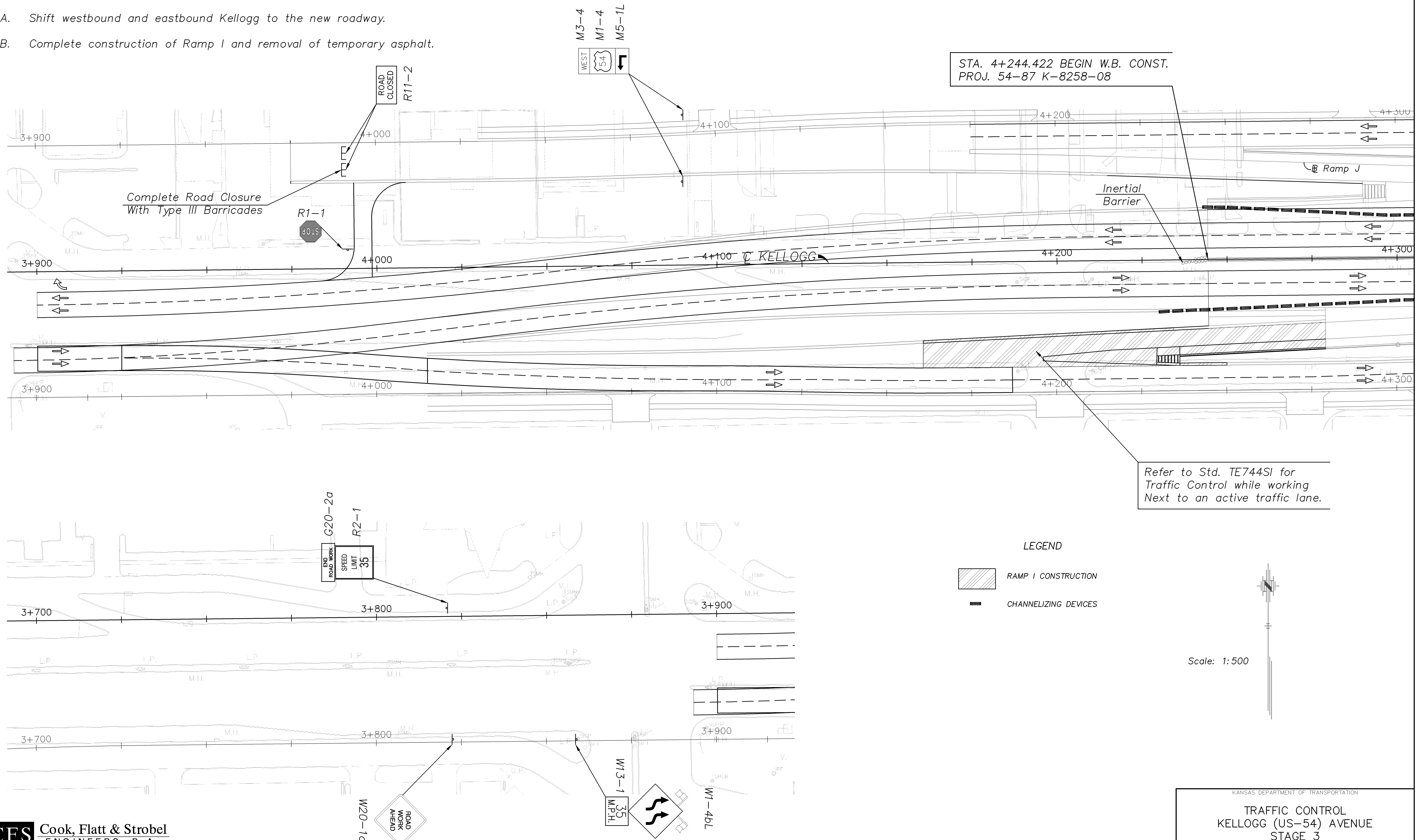

REFERENCE NOTED	REFERENCE CHECKED



STA. 4+244.422 BEGIN W.B. CONST.
PROJ. 54-87 K-8258-08

Refer to Std. TE744SI for
Traffic Control while working
Next to an active traffic lane.

LEGEND

-  RAMP I CONSTRUCTION
-  CHANNELIZING DEVICES

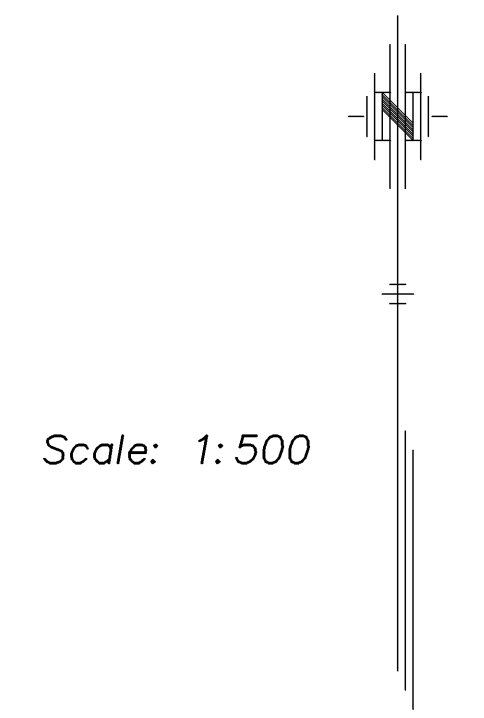

KANSAS DEPARTMENT OF TRANSPORTATION
**TRAFFIC CONTROL
KELLOGG (US-54) AVENUE
STAGE 3**