

119TH ST. WEST

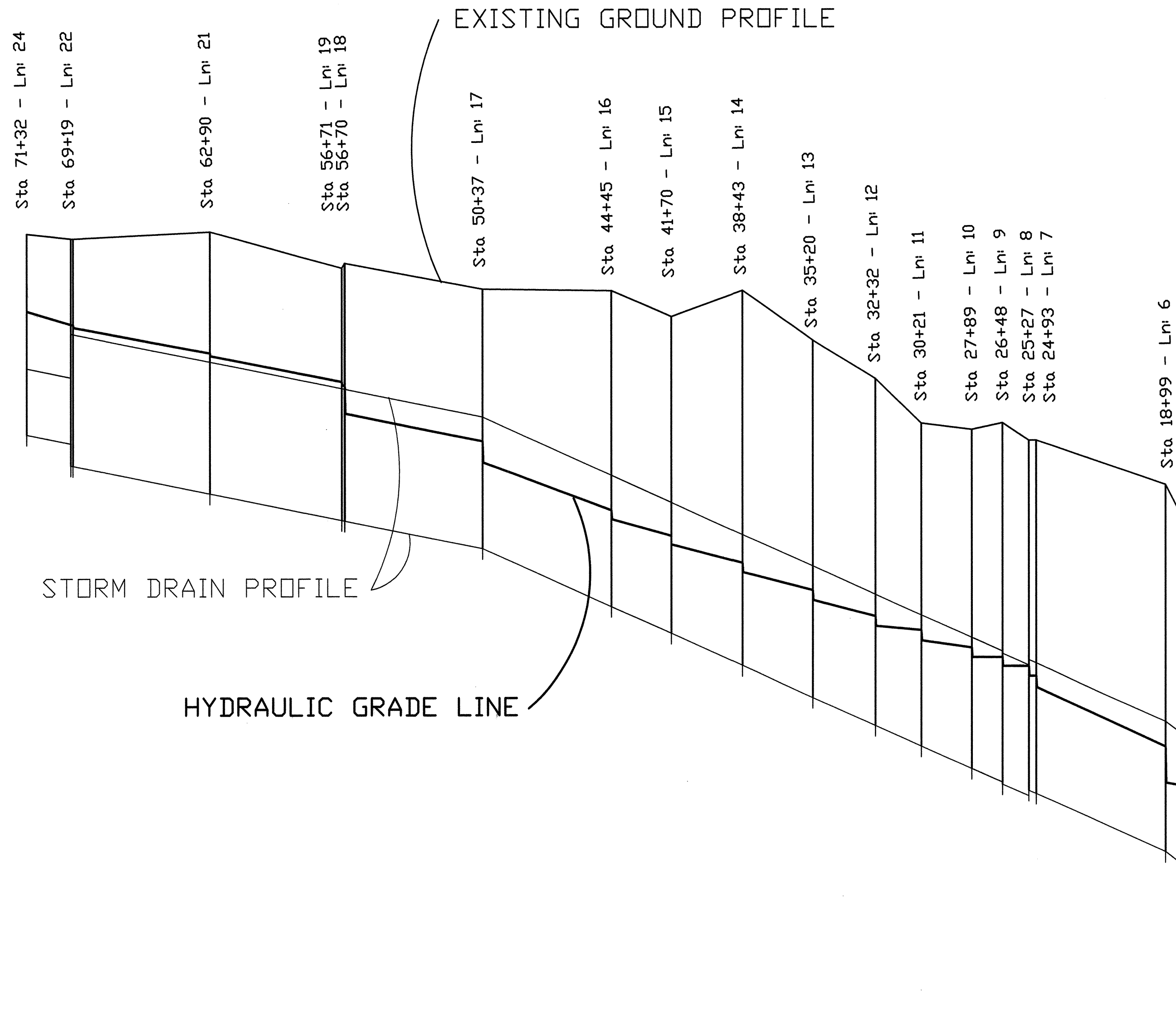

Line No.	FlowRate (cfs)	Line Size (Rise x Span) (in)	LineType	Invert El. Down (ft)	Invert El. Up (ft)	Line Slope (%)	HGL Down (ft)	HGL Up (ft)	Minor Loss (ft)
1	590.22	96 X 192	Box	109.53	110.1	0.2	118.6	118.72*	0.07
2	590.22	96 X 192	Box	110.1	111.34	0.2	118.79	118.98	0.07
3	20	36	Cir	111.34	111.46	0.21	119.05	119.11*	0.02
4	570.22	96 X 192	Box	111.46	111.88	0.2	119.05	119.08	0.08
5	528.35	72 X 192	Box	111.88	112.01	0.21	119.15	119.20*	0.09
6	511.22	72 X 192	Box	112.01	117.43	0.75	119.3	120.59	0.32
7	498.04	72 X 96	Box	117.43	120.1	0.45	122.27	125.03	0.5
8	498.04	72 X 96	Box	120.1	120.25	0.44	125.53	125.53	0.43
9	491.38	72 X 96	Box	120	120.54	0.45	125.96	125.97	0.4
10	484.24	72 X 96	Box	120.64	121.27	0.45	126.37	126.37	0.44
11	480.91	72 X 96	Box	121.27	122.31	0.45	126.81	127.13	0.48
12	440.51	72 X 96	Box	122.31	123.26	0.45	127.61	127.8	0.46
13	426.71	72 X 96	Box	123.26	124.56	0.45	128.26	129.01	0.45
14	401.02	72 X 96	Box	124.56	126.01	0.45	129.46	130.28	0.43
15	374.85	72 X 96	Box	126.01	127.48	0.45	130.71	131.56	0.41
16	365.38	72 X 96	Box	127.48	128.72	0.45	131.97	132.73	0.4
17	354.18	72 X 96	Box	128.72	131.38	0.45	133.14	135.31	0.39
18	338.38	72 X 96	Box	131.38	132.65	0.2	136.28	137.53	0.23
19	251.43	72 X 72	Box	132.65	132.65	0	138.65	138.65*	0.15
20	251.43	72 X 72	Box	132.65	132.68	0.23	138.8	138.83*	0.15
21	237.79	72 X 72	Box	132.68	133.89	0.2	138.98	140.16*	0.14
22	231.8	72 X 72	Box	133.89	135.15	0.2	140.3	141.46*	0.13
23	42.8	72 X 72	Box	135.15	135.17	0.2	141.59	141.59*	0
24	36.3	36	Cir	136.17	136.58	0.2	141.59	142.20*	0.1
25	27.2	36	Cir	136.58	137.71	0.2	142.3	143.24*	0.06
26	21.7	36	Cir	138.71	138.84	0.19	143.3	143.37*	0.04
27	11.6	36	Cir	138.94	138.98	0.2	143.4	143.41*	0.01
28	41.87	72 X 96	Box	109.28	109.82	2	119.15	119.15*	0
29	17.13	24	Cir	113	114.75	5	119.3	119.50*	0.12
30	13.18	36	Cir	118.65	125.05	20	120.91	126.21	0.11
31	6.66	36	Cir	121.42	121.59	0.2	125.96	125.97*	0
32	7.14	36	Cir	121.96	122.14	0.2	126.37	126.38*	0
33	1.9	18	Cir	124.1	124.12	0.2	126.81	126.81*	0
34	40.4	36	Cir	125.61	126.86	1.51	127.61	128.89	0.25
35	13.8	24	Cir	125.61	125.63	0.18	128.26	128.30*	0.07
36	25.69	30	Cir	126.9	126.92	0.17	129.46	129.50*	0.11
37	26.17	24	Cir	128.31	128.34	0.23	130.71	130.88*	0.27
38	9.47	24	Cir	129.84	129.86	0.17	131.97	131.99*	0.04
39	11.2	24	Cir	131.08	131.1	0.17	133.14	133.16*	0.05
40	15.8	24	Cir	133.75	133.77	0.17	135.75	135.77	0.1
41	86.95	78 X 78	Box	135.01	135.07	0.21	137.77	137.79	0.09
42	13.64	48 X 72	Box	135.04	135.06	0.18	138.98	138.98	0
43	5.99	24	Cir	136.25	136.27	0.2	140.3	140.30*	0.01
44	6.5	24	Cir	138.03	138.16	0.2	141.59	141.65*	0.02
45	9.1	24	Cir	137.01	137.21	0.2	142.3	142.46*	0.03
46	6.66	24	Cir	-0.5	-0.49	0.08	125.97	125.98*	0.02
47	7.14	24	Cir	-0.37	-0.36	0.07	126.38	126.40*	0.02
48	8.09	18	Cir	126.4	127.41	1.51	128.38	128.69	0.1
49	19.98	30	Cir	128.92	129.93	1.51	130.02	131.54	0.14
50	26.17	18	Cir	130.83	131.87	1.51	132.33	136.62*	0.85
51	8.95	18	Cir	130.36	130.49	0.2	132.03	132.51*	0.1
52	10	18	Cir	134.27	134.4	0.19	135.87	136.48*	0.12
53	10.94	18	Cir	135.56	135.69	0.19	138.99	139.71*	0.15
54	3.28	18	Cir	136.77	136.9	0.19	140.32	140.38*	0.01
55	14.27	30	Cir	130	131.46	1.51	131.68	132.72	0.13
56	1.43	12	Cir	0.54	0.72	0.31	126.81	126.90*	0.01
57	189	18	Cir	124.1	124.96	1.51	141.59	326.34*	44.46
58	26.17	24	Cir	137.51	137.61	0.2	139.51	140.17*	0.27

OFFICE CHECK
 Engineer: J. PARSONS
 Designer: J. PARSONS
 POC Job No.: 1793
 Date: JULY 2005

POE & ASSOCIATES, INC.
 CONSULTING ENGINEERS
 5906 Central Exp. 200 Wichita, KS 67208-4202
 Phone: 316/685-4114 FAX: 316/685-4444

PANWEE AVENUE
 119TH TO MAIZE ROAD
 CITY OF WICHITA, KANSAS
 DRAINAGE CALCULATIONS

No.	Date	By	Approved	Revision