

MAJOR CONSTRUCTION ITEMS	HANDLING OF TRAFFIC	REMARKS
<b>PHASE 1</b> Construct Storm Sewer from Cowskin Creek to Maize Road. Construct Waterline relocation.	Maintain local traffic to residences depending on Pawnee Avenue for access.	See Sheet No. 105-106
<b>PHASE 2</b> Construct Pawnee Avenue from Maize Road to Yellowstone.	Maintain local traffic to residences depending on Pawnee Avenue for access.	See Sheet No. 105-106
<b>PHASE 3</b> Construct east half of Pawnee Avenue / Maize Road intersection with temporary paving on west side of intersection.	Maintain two-way traffic on Maize Road with vehicles diverted to west side of Intersection at Pawnee Avenue.	See Sheet No. 105, 107 No Left Turns.
<b>PHASE 4</b> Construct west half of Pawnee Avenue / Maize Road intersection.	Maintain two-way traffic on Maize Road with vehicles diverted to east side of Intersection at Pawnee Avenue.	See Sheet No. 105, 107 No Left Turns.
<b>PHASE 5</b> Construct Storm Sewer from Maize Road to Prescott.	Close Pawnee Avenue from Maize Road to Prescott. Maintain access to Prescott from the west.	See Sheet No. 103-104
<b>PHASE 6</b> Construct Pawnee Avenue from Maize Road to Prescott. Install Traffic Signals at Pawnee Avenue and Maize Road intersection.	Close Pawnee Avenue from Maize Road to Prescott. Maintain access to Prescott from the west.	See Sheet No. 103-104
<b>PHASE 7</b> Construct Storm Sewer from Prescott to 119th Street West.	Maintain local access to Prescott, Shefford, and Church Entrance.	See Sheet No. 100-102
<b>PHASE 8</b> Construct Pawnee Avenue from Prescott to 119th Street West.	Maintain local access to Prescott, Shefford, and Church Entrance.	See Sheet No. 100-102
<b>PHASE 9</b> Construct east side of 119th Street West.	Maintain two-way traffic on 119th Street West. Move traffic to west side of 119th Street West.	See Sheet No. 100, 107 No Left Turns.
<b>PHASE 10</b> Construct west side of 119th Street West and Pawnee Avenue west of 119th Street West.	Maintain two-way traffic on 119th Street West. Move traffic to east side of 119th Street West.	See Sheet No. 100, 108 No Left Turns.

**GENERAL NOTES**

THE INTENTION OF THESE DRAWINGS FOR CONSTRUCTION TRAFFIC CONTROL IS TO PROVIDE THE CONTRACTOR A SCHEME FOR ORGANIZING THE WORK WHILE MAINTAINING THROUGH TRAFFIC AND ACCESS TO PROPERTY ALONG THE PROJECT. THE OBJECTIVE OF THE SCHEME IS THE SAFE, EXPEDITIOUS MOVEMENT OF TRAFFIC AND SAFETY OF THE WORK FORCE. THIS SCHEME IS NOT INTENDED TO BE COMPLETE AND WILL REQUIRE ADDITIONAL DETAIL TO BE PROVIDED BY THE CONTRACTOR WHICH MAY INCLUDE, BUT NOT LIMITED TO, ADDITIONAL SIGNING, BARRICADES, MARKINGS, TEMPORARY SURFACING, AND DETOURS. ALL TRAFFIC CONTROLS FOR STREET CONSTRUCTION, MAINTENANCE, UTILITY, AND EMERGENCY OPERATIONS SHALL CONFORM TO THE MANUAL ON UNIFORM TRAFFIC CONTROL DEVICES.

THE SEQUENCE SHOWN IS INTENDED AS A GUIDE FOR MAJOR ITEMS ONLY. THE CONTRACTOR WILL BE RESPONSIBLE FOR THE COORDINATION OF ALL MAJOR ITEMS. VARIATIONS TO THE SEQUENCE SHOWN MAY BE USED AS APPROVED BY THE ENGINEER. REGARDLESS OF SEQUENCE USED, CONSTRUCTION TRAFFIC SHALL BE ESSENTIALLY IN ACCORDANCE WITH THAT SHOWN. PART OF THE WORK SHOWN FOR A SPECIFIC PHASE MAY BE ACCOMPLISHED IN OTHER PHASES. MAJOR WORK NOT CONSTRUCTED WITHIN THE INDICATED PHASE SHALL BE APPROVED BY THE ENGINEER.

ALL SIGNS AND PAVEMENT MARKINGS CONFLICTING WITH THIS TRAFFIC CONTROL SHALL BE COVERED OR REMOVED AS DIRECTED BY THE ENGINEER.

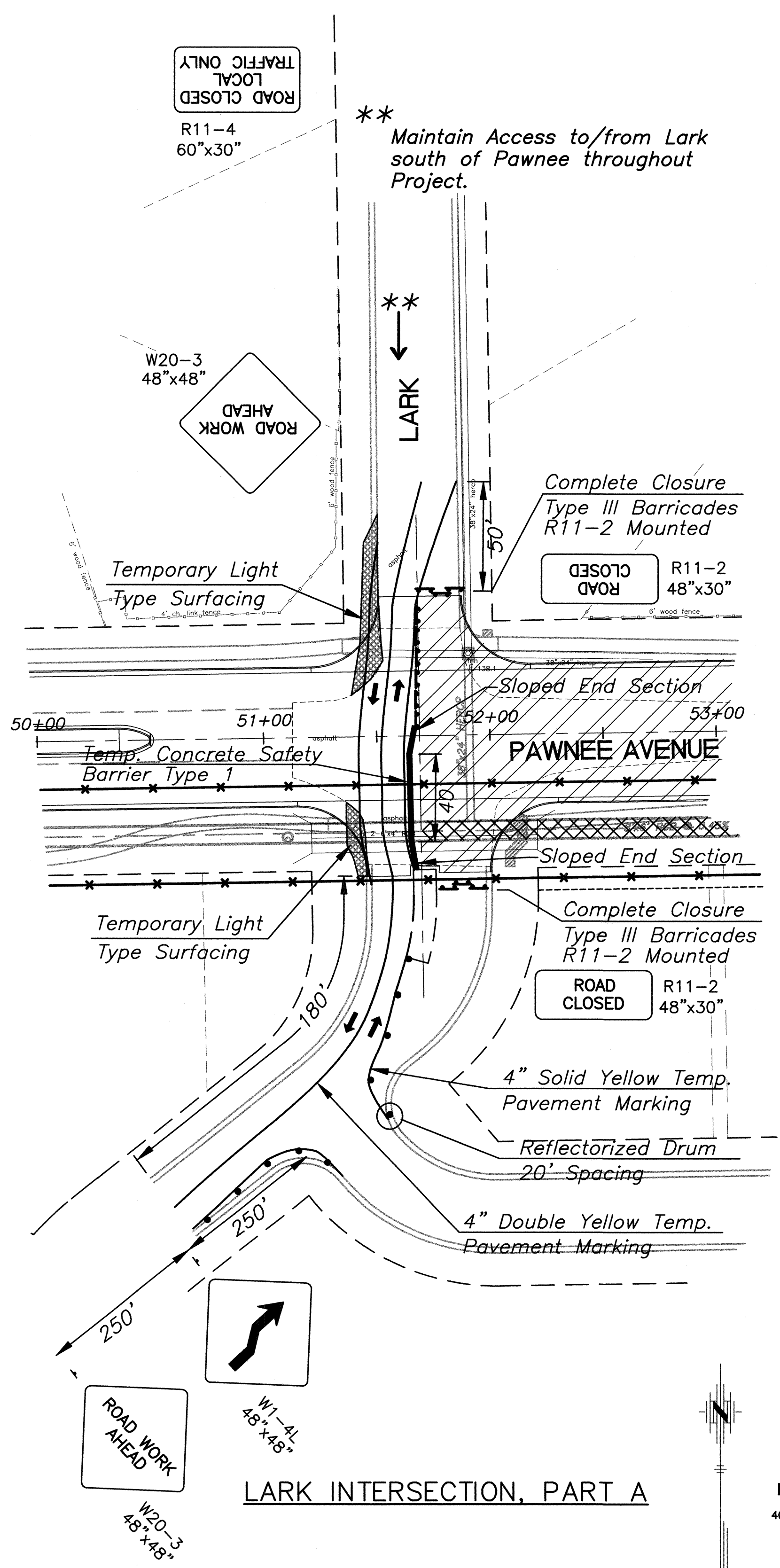

LARK INTERSECTION, PART A

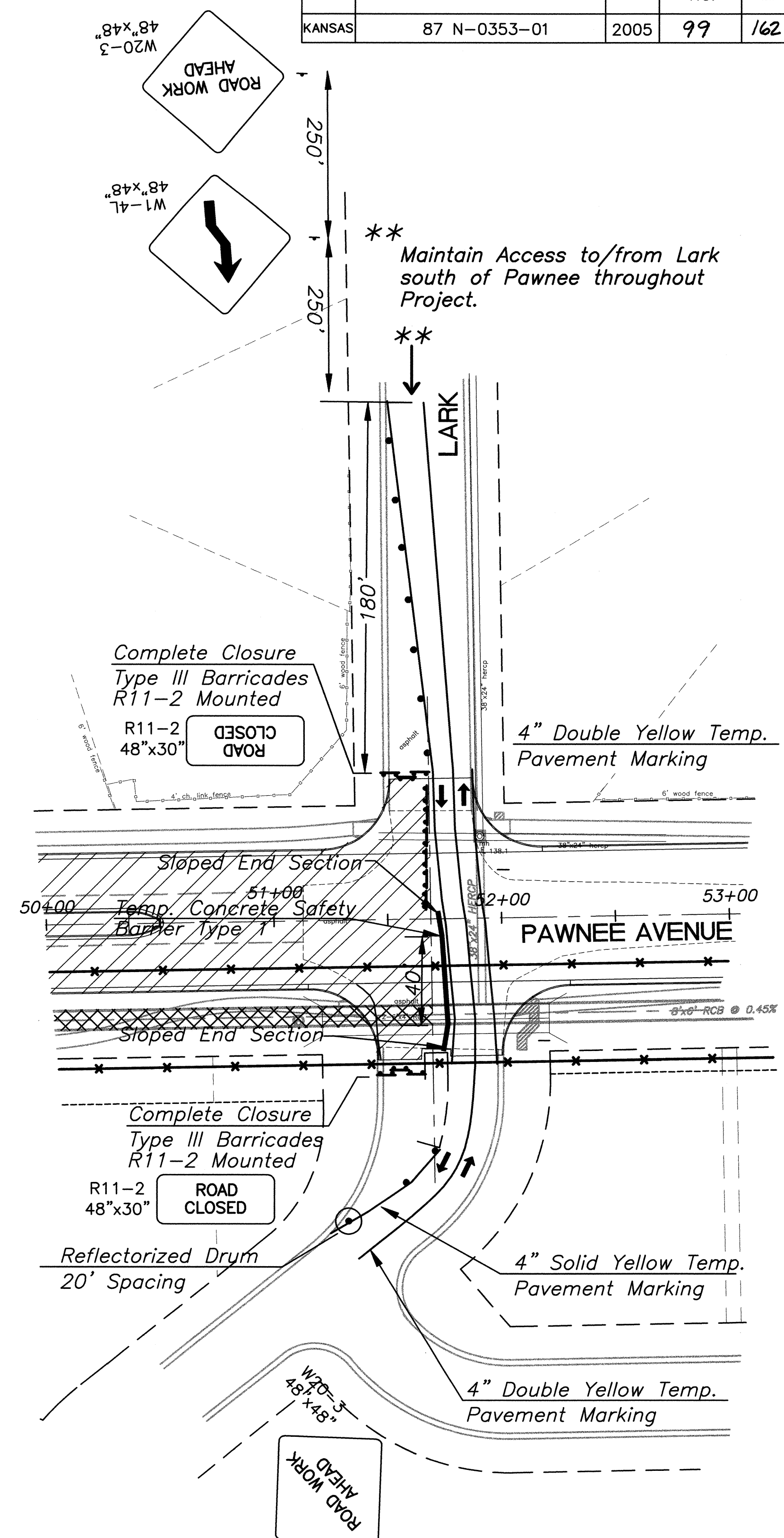

LARK INTERSECTION, PART B

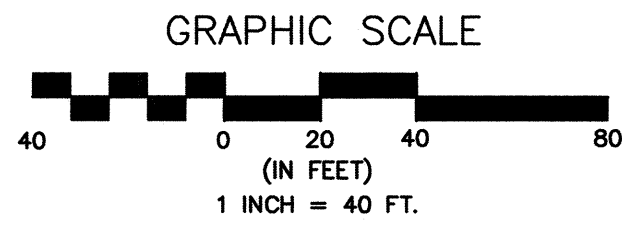

**KANSAS DEPARTMENT OF TRANSPORTATION**  
TRAFFIC HANDLING &  
CONSTRUCTION SEQUENCE  
PAWNEE AVENUE

Drawn By : USERNAME Plotted : SYTIME  
 File : DGN5PEC  
 REFERENCES NOTED  
 REFERENCES CHECKED