

**PHASE 1**  
 Construct Waterline Relocate.  
 Construct Storm Sewer from Cowskin Creek to Maize Road.  
 Maintain local traffic to residences depending on Pawnee Avenue for access.

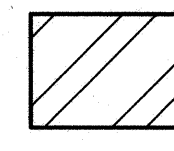

**PHASE 2**  
 Construct Pawnee Avenue from Maize Road to Yellowstone.  
 Maintain local traffic to residences depending on Pawnee Avenue for access.

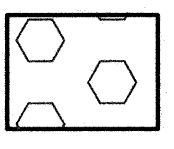

**PHASE 3** See Sheet No. 109  
 Construct east half of Pawnee Avenue / Maize Road intersection with temporary paving on west side of intersection.  
 Maintain two-way traffic on Maize Road with vehicles diverted to west side of Intersection at Pawnee Avenue.

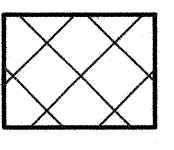

**PHASE 4** See Sheet No. 110  
 Construct west half of Pawnee Avenue / Maize Road intersection.  
 Maintain two-way traffic on Maize Road with vehicles diverted to east side of Intersection at Pawnee Avenue.

**Notes:**

1. Temporary Orange Construction Fence shall be placed around the limits of the storm sewer installation excavation. This fence shall not be removed until excavation is backfilled.
2. Construction activities shall be coordinated so as to allow local access to driveways and side-streets from Sta. 69+00 to Sta. 78+00. The Type III Barricades closing Pawnee Ave. may be relocated as necessary to facilitate access.
3. The east & west ends of the work area shall be protected with appropriate barricades in areas where local traffic approaches the work area.

- ☆ Configuration to be used when Road Closure necessary.
- ⊗ Configuration to be used when Local Access to be Maintained.

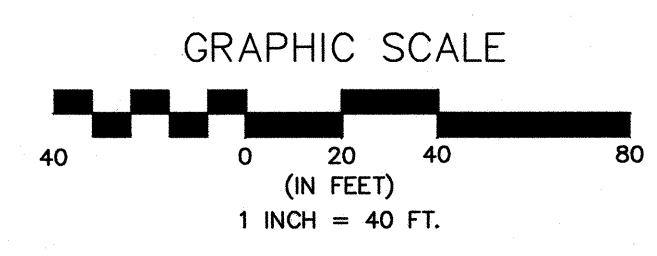
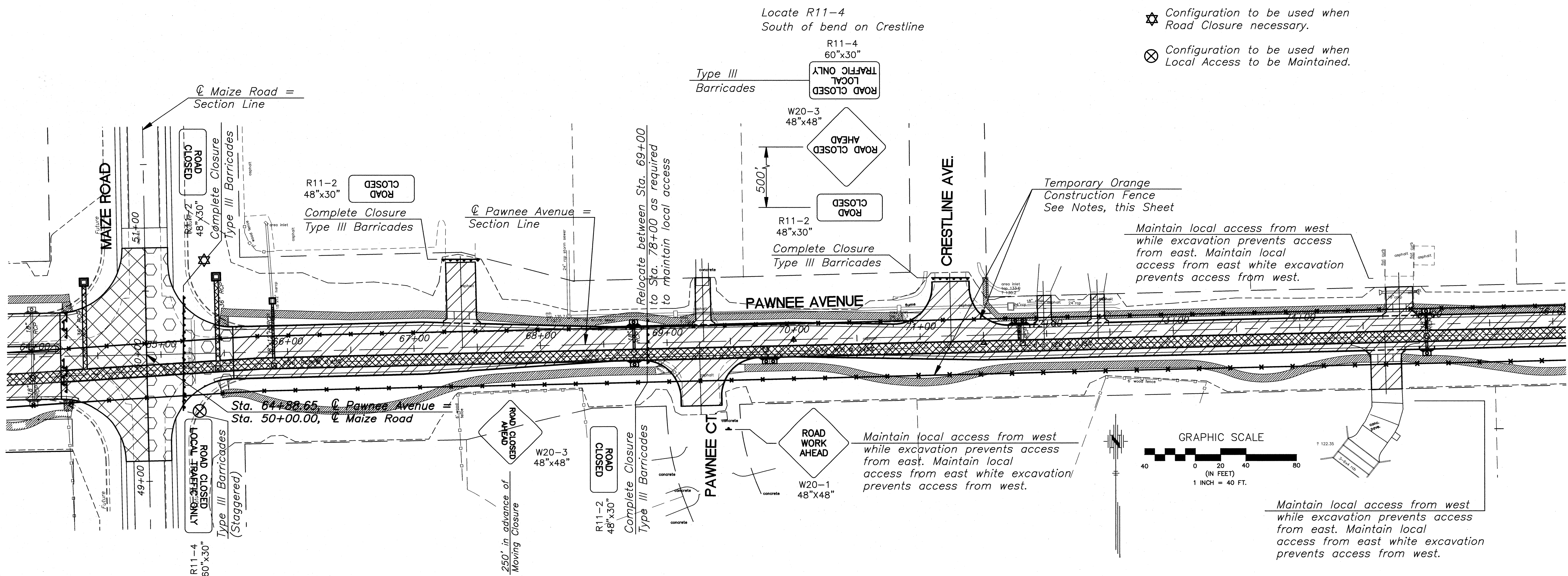

Approved	By	Revision
Date	No.	

**PAWNEE AVENUE  
119TH TO MAIZE ROAD  
CITY OF WICHITA, KANSAS  
TRAFFIC CONTROL**

**POE & ASSOCIATES, INC.**  
 CONSULTING ENGINEERS  
 5940 E. Central, Suite 200 ■ Wichita, KS 67208-0242  
 Phone 316/685-4114 ■ FAX 316/685-4444

**POE**

**FINAL**

Engineer: P. FERGUSON  
 Designer: J. UNRUH  
 Pce. Job No.: 1793  
 Date: JULY 2005

Sheet  
105 of 162