

- PHASE 1**
 Construct Waterline Relocation.
 Construct Storm Sewer from Cowskin Creek to Maize Road.
 Maintain local traffic to residences depending on Pawnee Avenue for access.
- PHASE 2**
 Construct Pawnee Avenue from Maize Road to Yellowstone.
 Maintain local traffic to residences depending on Pawnee Avenue for access.

- Notes:**
1. Temporary Orange Construction Fence shall be placed around the limits of the storm sewer installation excavation. This fence shall not be removed until excavation is backfilled.
 2. Construction activities shall be coordinated so as to allow local access to driveways and side-streets from Sta. 69+00 to Sta. 78+00. The Type III Barricades closing Pawnee Ave. may be relocated as necessary to facilitate access.
 3. The east & west ends of the work area shall be protected with appropriate barricades in areas where local traffic approaches the work area.

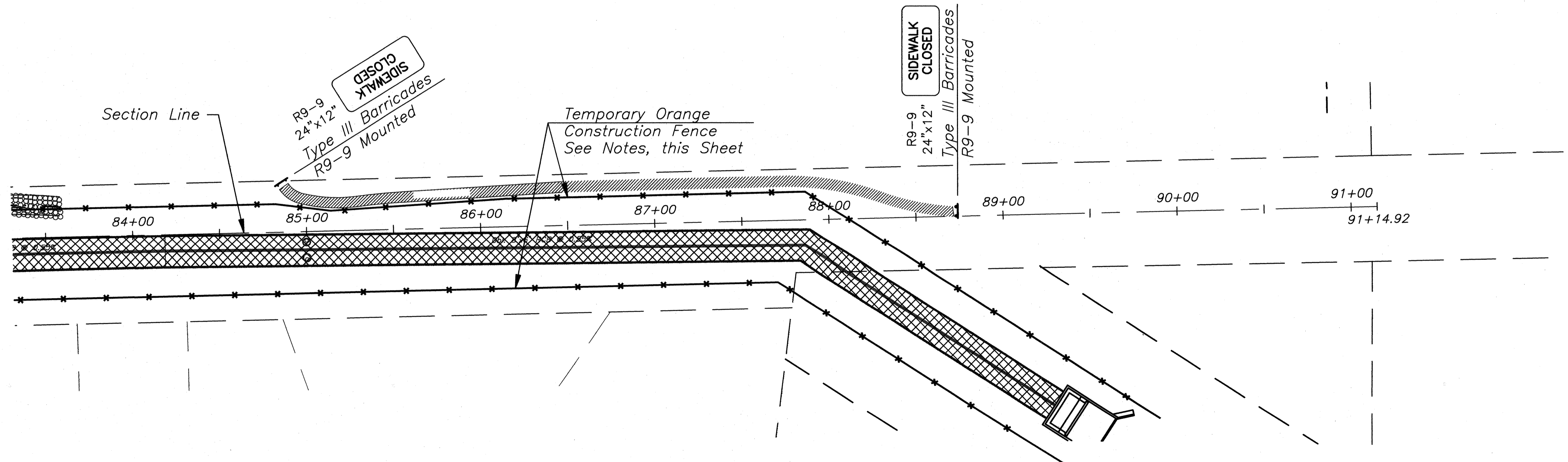

PAWNEE AVENUE 119TH TO MAIZE ROAD CITY OF WICHITA, KANSAS TRAFFIC CONTROL	
POE & ASSOCIATES, INC. CONSULTING ENGINEERS 5940 E. Central, Suite 200 Wichita, KS 67208-4242 Phone 316/685-4114 FAX 316/685-4444	
FINAL Engineer: P. FERGOUSON Designer: J. UNRUH P.O. Job No.: 1793 Date: JULY 2005	Sheet 106 of 162