

PHASE 10
Construct west side of 119th Street West and Pawnee Avenue west of 119th Street West. Maintain two-way traffic on 119th Street West. Move traffic to east side of 119th Street West.

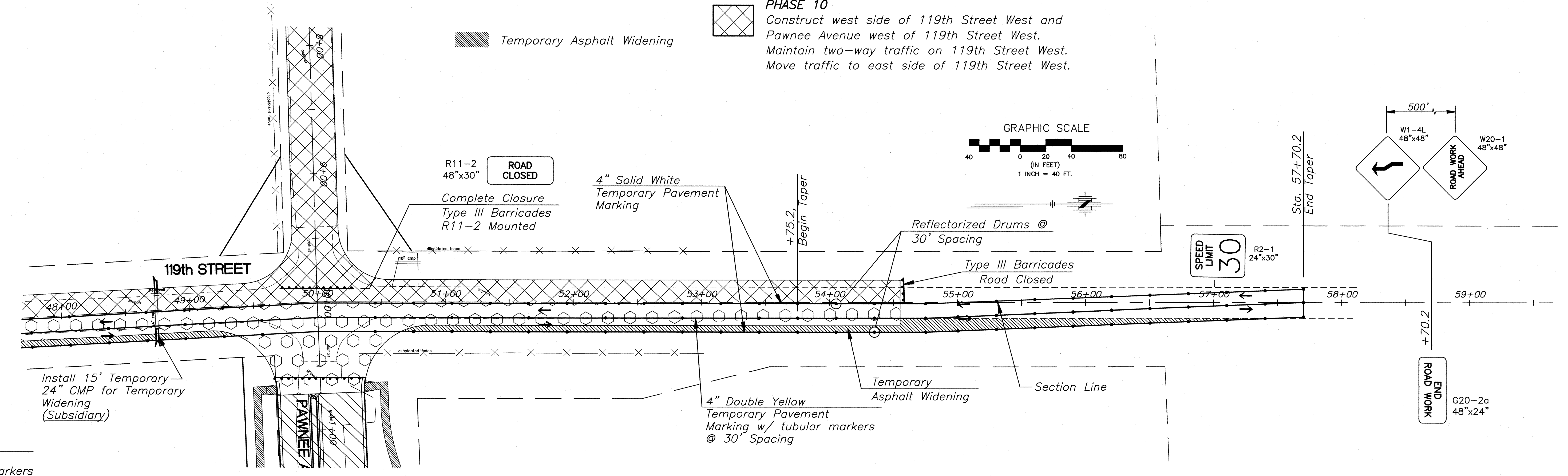
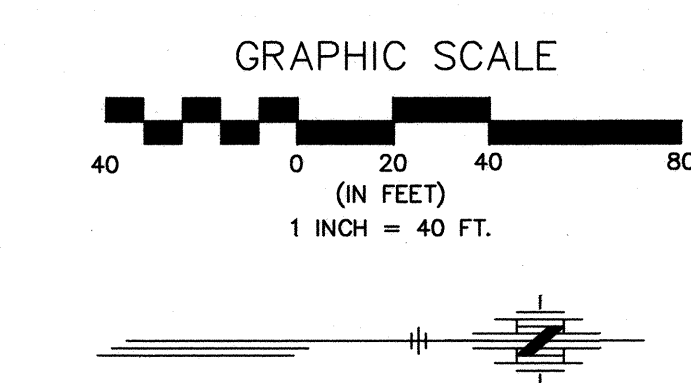

Revision					
By					
Date					
No.					

PAWNEE AVENUE
119TH TO MAIZE ROAD
CITY OF WICHITA, KANSAS
TRAFFIC CONTROL

POE & ASSOCIATES, INC.
CONSULTING ENGINEERS
5940 E. Central, Suite 200 • Wichita, KS 67208-4242
Phone 316/685-4114 • FAX 316/685-4444

PE

FINAL

Engineer: P. FERGUSON
Designer: J. UNRUH
Pee Job No.: 1793
Date: JULY 2005

Sheet
108 of 162